

THOMAS JAMES RAY  
 3217 BOYETTE DR SW  
 L25 LANDFALL SUB 1.00LT  
 .303 AC

Wilson County  
 YR 2024 3701880431.000  
 3217 BOYETTE DR SW  
 PIN: 3701 88 0431 000  
 DISTRICT: 31 C/CIWI-WILSON

ACCOUNT#: 1084213  
 NBHD: 8159 LANDFALL  
 Plat Bk/Pg 22 9  
 EXCD: APPR: KRC APPR DT: 2/07/2019  
 NOTICE: 82 3/08/2024

Bldg No. 1  
 Imp Desc: R1.0 SFR-1.0 STY EYB: 1998 3217 BOYETTE DR SW Exempt Code LAND VALUE 40,000  
 Grade : C+10 C+10 GRADE AYB: 1993 Finished Area: 1,520.00 MISC VALUE 0  
 # of Units 5 Rms 3 Bedrms 2.0 Bathrms HBaths BLDG VALUE 191,246  
 TOTAL VALUE 231,246

TYPE/CODE/DESCRIPTION	PCT	%CMP	UNITS	RATE	STR#	STR%	SIZ%	HGT%	PER%	COST
AC 1031 CARPORT	100		270	27.90			97.00			7,307
AC 1051 PORCH-OPEN-FR	100		28	38.80			120.00			1,303
AC 1064 DECK-WOOD	100		168	24.95			102.00			4,275
AC 1071 UTILITY STG-FR	100		49	39.45			110.00			2,126
MA 111 SFR-1.0 STY	100		1520	136.00	1.00		100.94			208,662
- AR 10 FORCED AIR HEAT W/ A100	100		1520	.00						0
- EW 02 VINYL SIDING	100		186	.00						0
- FC 20 HARDWOOD/CARPET	100		1520	2.00						3,040
- FN 03 CONT WALL-BRICK	100		186	.00						0
- FP 3 1STY SNGL	100		1	5100.00						5,100
- IF 48 CUSTOM INTERIOR	100		1520	.00						0
- RC 02 COMPOSITION SHINGLE	100		1520	.00						0
- RT 03 DOUBLE PITCH ROOF	100		1520	.00						0
RCN...		PCT COMPLETE			100	x				231,813
QUAL..	C+10				110.00	x				254,994
DEPR.. RC					25.00	-		63,748		63,748
--ASV...										191,246

PROPERTY NOTES:	PERMIT NO	TYPE	DATE	BOOK	PAGE	DT	DATE	QS	SALES	PRICE
WORK DONE PER '11 LISTING NVC				2770	578	WD	1/14/2019			135,000
	AMOUNT			2406	509	WD	5/19/2010			136,000
	AMOUNT			2004	416	WD	12/05/2003	U		
				1980	871	WD	8/15/2003	U		102,000

MISC CODE	DESC	UNITS	RATE	AYB	EYB	DT	PCT	%CMP	ADD.DEPR	PCT	VALUE	EXMPT
							.00					
							.00					
							.00					
							.00					

#	ZONE	TYPE/CODE	LAND QTY	LAND RATE	DPTH	DPT%	TOP%	LOC%	SIZ%	SHP%	OTH%	ADJ	FMV	EXMPT
1	SR6	LT 0100	1.000	40,000.00	150	.00	.00	.00	100.00	.00	.00	.00	40,000	

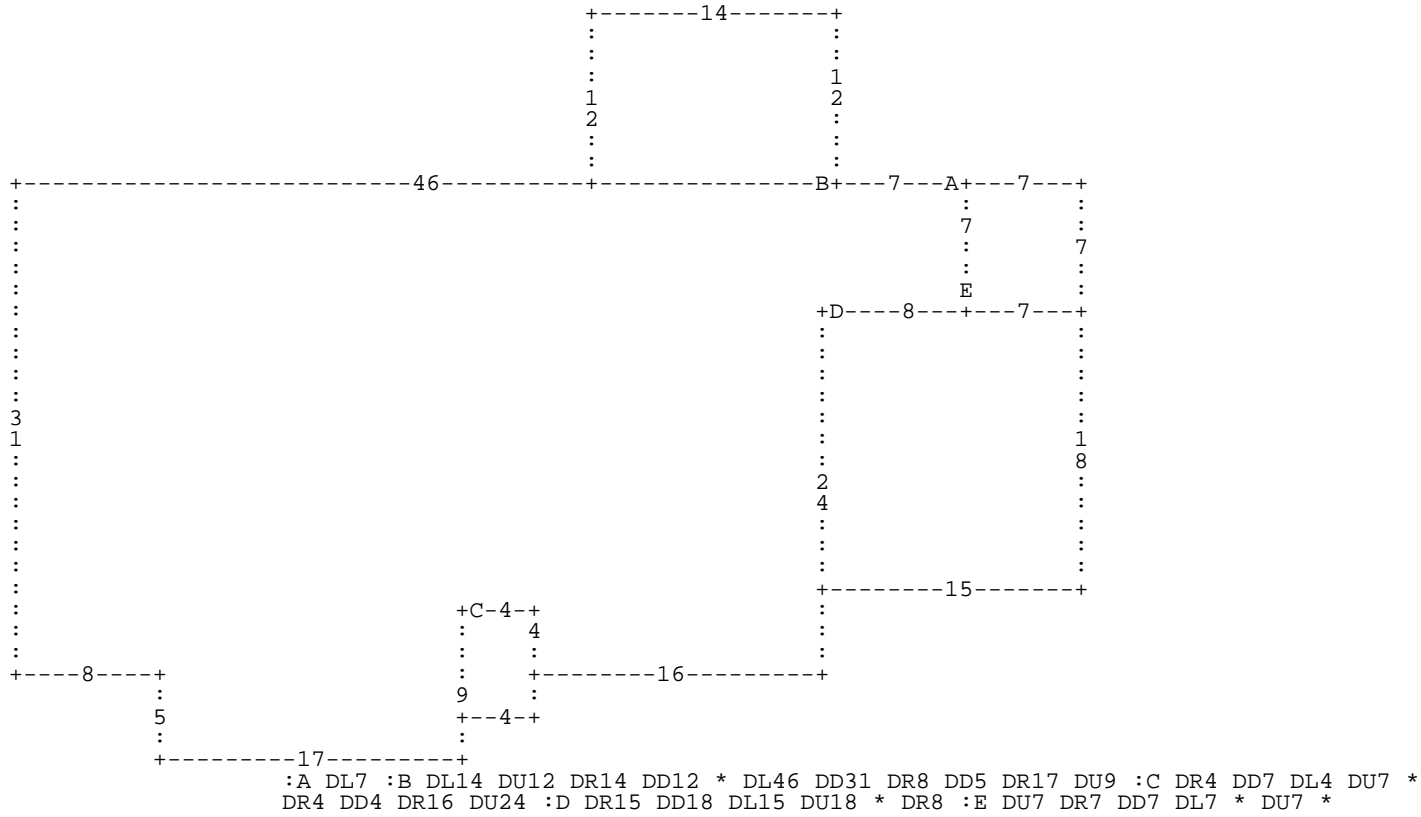

:A DL7 :B DL14 DU12 DR14 DD12 \* DL46 DD31 DR8 DD5 DR17 DU9 :C DR4 DD7 DL4 DU7 \*  
DR4 DD4 DR16 DU24 :D DR15 DD18 DL15 DU18 \* DR8 :E DU7 DR7 DD7 DL7 \* DU7 \*

A= MA 111  
D= AC 1031

1,520.00 SFR-1.0 STY  
270.00 CARPORT

B= AC 1064  
E= AC 1071

168.00 DECK-WOOD  
49.00 UTILITY STG-F

C= AC 1051

28.00 PORCH-OPEN-FR