

FORTSON FLORENCE TYSON
 3314 B NC 42 HWY W
 RAPER LD 1.00LT
 .350 AC

Wilson County
 YR 2024 3701795544.000
 3314 B NC 42 HWY W
 PIN: 3701 79 5544 000
DISTRICT: 13 C/SW/CONTENTNEA SWAF

ACCOUNT#: 13796570
 NBHD: 8388 WILSON_WEST_A-1
 Plat Bk/Pg 1.00 EXCD:
 APPR: REV APPR DT: 7/07/2015
 NOTICE: 82 3/08/2024

Bldg No. 1
 Imp Desc: R1.0 SFR-1.0 STY
 Grade : C-05 C-05 GRADE
 # of Units 3 Rms 2 Bedrms 1.0 Bathrms 1 HBaths
 EYB: 1985 3314 B NC 42 HWY W
 AYB: 1960 Finished Area: 1,276.00
 Exempt Code
LAND VALUE 11,340
MISC VALUE 14,787
BLDG VALUE 104,092
TOTAL VALUE 130,219

| TYPE/CODE/DESCRIPTION | PCT | %CMP | UNITS | RATE | STR# | STR% | SIZ% | HGT% | PER% | COST |
|------------------------------|------|------|--------------|---------|-------|--------|--------|--------|------|----------|
| AC 1031 CARPORT | 100 | | 417 | 27.90 | | | 94.00 | | | 10,936 |
| AC 1052 PORCH-OPEN-MAS | 100 | | 65 | 29.10 | | | 106.00 | | | 2,004 |
| AC 1071 UTILITY STG-FR | 100 | | 48 | 39.45 | 1.00 | 100.00 | 110.00 | | | 2,082 |
| MA 111 SFR-1.0 STY | 100 | | 1276 | 136.00 | 1.00 | | 104.00 | | | 180,477 |
| - AR 27 ELECTRIC HEAT PUMP | 100 | | 1276 | .00 | | | | | | 0 |
| - BT BT FULL BATH | 100 | | 1- | 5500.00 | | | | | | 5,500- |
| - BT HBT HALF BATH | 100 | | 1 | 3667.00 | | | | | | 3,667 |
| - EW 02 VINYL SIDING | 100 | | 180 | .00 | | | | | | 0 |
| - FC 10 SOFTWOOD | 100 | | 1276 | 4.35 | | | | | | 5,550 |
| - FN 02 CONT WALL-CONC BLOCK | 100 | | 180 | .00 | | | | | | 0 |
| - IF 01 DRYWALL | 100 | | 1276 | .00 | | | | | | 0 |
| - RC 02 COMPOSITION SHINGLE | 100 | | 1276 | .00 | | | | | | 0 |
| - RT 03 DOUBLE PITCH ROOF | 100 | | 1276 | .00 | | | | | | 0 |
| ----- | | | | | | | | | | |
| RCN... | | | PCT COMPLETE | | 100 | x | | | | 199,216 |
| QUAL.. | C-05 | | | | 95.00 | x | | | | 189,256 |
| DEPR.. RC | | | | | 45.00 | - | | 85,164 | | 85,164 T |
| --ASV... | | | | | | | | | | 104,092 |

| PROPERTY NOTES: | PERMIT NO | TYPE | DATE | BOOK | PAGE | DT | DATE | QS | SALES | PRICE |
|-----------------------------------|-----------|------|------|------|------|----|------------|----|--------|-------|
| HVAC & CORRECT CLERICAL 4 '09-GRW | | | | 1485 | 504 | WD | 10/25/1999 | @ | | |
| | AMOUNT | | | 1359 | 864 | WD | 6/14/1993 | U | 44,500 | |
| | AMOUNT | | | 1062 | 640 | WD | 9/01/1988 | X | | |
| | | | | | | WD | 8/01/1971 | X | 500 | |

| MISC CODE | DESC | UNITS | RATE | AYB | EYB | DT | PCT | %CMP | ADD.DEPR | PCT | VALUE | EXMPT |
|-----------|--------------------|--------|-------|------|------|-----|-------|------|----------|-----|--------|-------|
| 81 1121 | GAR-DET-FR 19 X 24 | 456.00 | 51.50 | 2005 | 2005 | MAV | 40.00 | 100 | | | 14,091 | |
| 82 1142 | LEAN-TO 19 X 12 | 228.00 | 4.80 | 2005 | 2005 | MAV | 40.00 | 100 | | | 696 | |
| | | | | | | | .00 | | | | | |
| | | | | | | | .00 | | | | | |

| # | ZONE | TYPE/CODE | LAND QTY | LAND RATE | DPTH | DPT% | TOP% | LOC% | SIZ% | SHP% | OTH% | ADJ | FMV | EXMPT |
|---|------|-----------|----------|-----------|------|------|------|------|--------|------|------|--------|--------|-------|
| 1 | RA | AC 5030 | .350 | 18,000.00 | | .00 | .00 | .00 | 180.00 | .00 | .00 | 180.00 | 11,340 | |

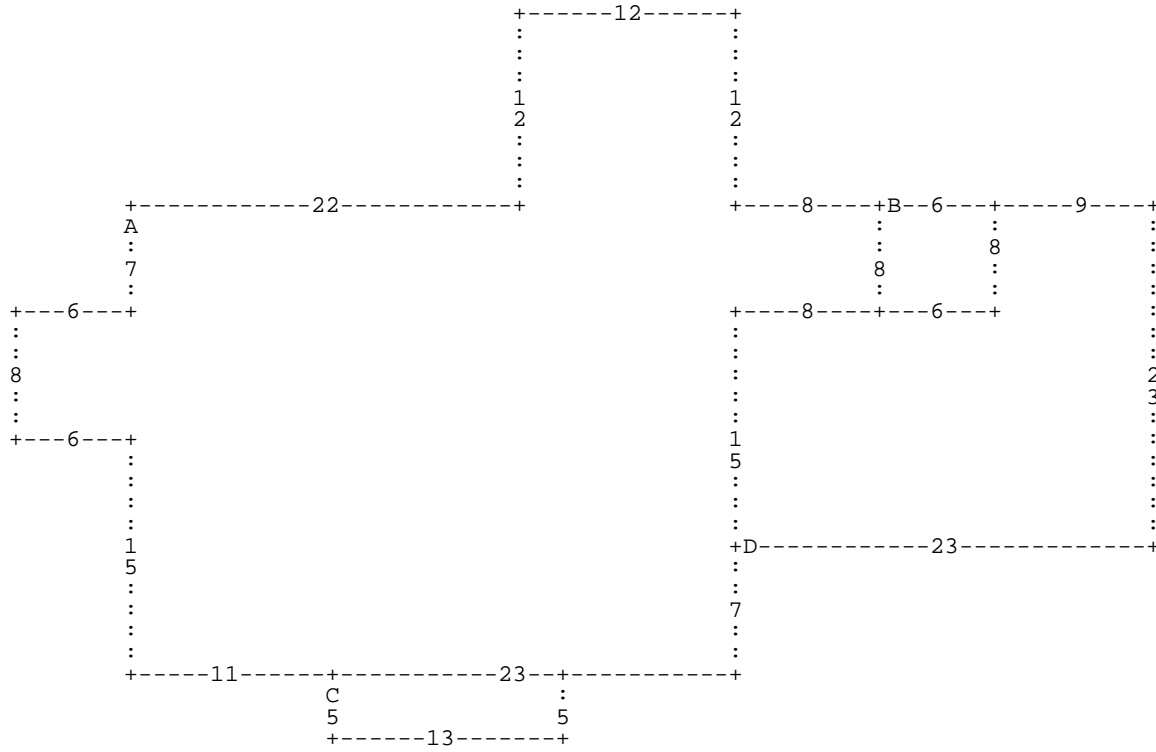

:A DD7 DL6 DD8 DR6 DD15 DR11 :C DD5 DR13 DU5 DL13 * DR23 DU7 :D DR23 DU23 DL9 DD
 8 DL14 DD15 * DU15 DR8 DU8 :B DR6 DD8 DL6 DU8 * DL8 DU12 DL12 DD12 DL22 *

A= MA 111
D= AC 1031

1,276.00 SFR-1.0 STY
 417.00 CARPORT

B= AC 1071

48.00 UTILITY STG-F

C= AC 1052

65.00 PORCH-OPEN-MA