

PRETLOW MELISSA A
 3232 BOYETTE DR SW
 L9 LANDFALL SUB 1.00LT
 .299 AC

Wilson County
 YR 2024 3701787132.000
 3232 BOYETTE DR SW
 PIN: 3701 78 7132 000
 DISTRICT: 31 C/CIWI-WILSON

ACCOUNT#: 69951966
 NBHD: 8159 LANDFALL
 Plat Bk/Pg 22 9
 EXCD: APPR: REV APPR DT: 12/02/2014
 NOTICE: 82 3/08/2024

Bldg No. 1
 Imp Desc: R1.5 SFR-UPTO 1.5 STY EYB: 1997 3232 BOYETTE DR SW Exempt Code
 Grade : C+10 C+10 GRADE AYB: 1992 Finished Area: 1,508.00
 # of Units 5 Rms 3 Bedrms 2.0 Bathrms 1 HBaths

LAND VALUE 40,000
 MISC VALUE 0
 BLDG VALUE 167,032
 TOTAL VALUE 207,032

TYPE/CODE/DESCRIPTION	PCT	%CMP	UNITS	RATE	STR#	STR%	SIZ%	HGT%	PER%	COST
AC 1051 PORCH-OPEN-FR	100		72	38.80			106.00			2,961
AC 1051 PORCH-OPEN-FR	100		30	38.80			120.00			1,396
AC 1054 PORCH-SCR-MAS	100		196	45.80			100.00			8,976
AC 1071 UTILITY STG-FR	100		84	39.45			106.00			3,512
MA 112 SFR-1.5 STY	100		1062	116.00	1.42		100.94			124,349
MA 112 (UPPER FLOORS)	100		446	116.00	1.42	100.00	100.94			52,222
- AR 10 FORCED AIR HEAT W/ A100			1508	.00						0
- BT HBT HALF BATH	100		1	3667.00						3,667
- EW 02 VINYL SIDING	100		144	.00						0
- FC 20 HARDWOOD/CARPET	100		1508	2.00						3,016
- FN 02 CONT WALL-CONC BLOCK	100		144	.00						0
- FP 3 1STY SNGL	100		1	5100.00						5,100
- IF 30 DRYWALL/CUSTOM	100		1062	.00						0
- RC 02 COMPOSITION SHINGLE	100		1062	.00						0
- RT 03 DOUBLE PITCH ROOF	100		1062	.00						0

RCN...			PCT COMPLETE		100	x				205,199
QUAL..	C+10				110.00	x				225,718
DEPR.. RC					26.00	-		58,686		58,686 T
--ASV...										167,032

PROPERTY NOTES:

PERMIT NO	TYPE	DATE	BOOK	PAGE	DT	DATE	QS	SALES	PRICE
			2056	589	WD	9/02/2004	U	132,000	
AMOUNT					@	10/25/1999	@		
			1709	385	WD	3/02/1999	U	117,000	
AMOUNT			1498	357	WD	10/07/1993		99,500	

MISC CODE	DESC	UNITS	RATE	AYB	EYB	DT	PCT	%CMP	ADD.DEPR	PCT	VALUE	EXMPT
							.00					
							.00					
							.00					
							.00					

#	ZONE	TYPE/CODE	LAND QTY	LAND RATE	DPTH	DPT%	TOP%	LOC%	SIZ%	SHP%	OTH%	ADJ	FMV	EXMPT
1	SR6	LT 0100	1.000	40,000.00	150	.00	.00	.00	100.00	.00	.00	.00	40,000	

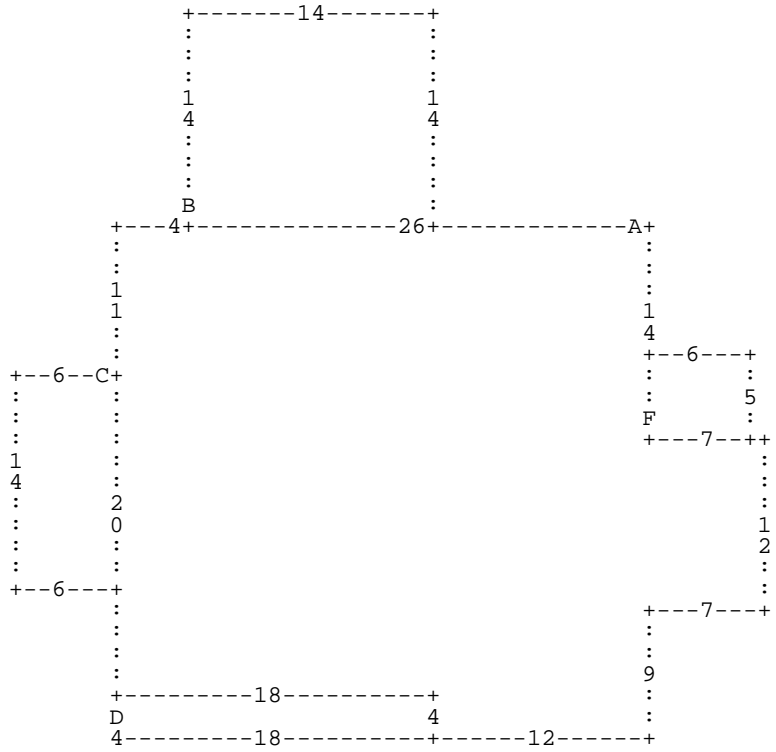

:A DL26 :B DU14 DR14 DD14 DL14 * DL4 DD11 :C DL6 DD14 DR6 DU14 * DD20 :D DD4 DR1
8 DU4 DL18 * DR18 DD4 DR12 DU9 DR7 DU12 DL7 :F DU5 DR6 DD5 DL6 * DU14 *

A= MA 112	1,062.00 SFR-1.5 STY	B= AC 1054	196.00 PORCH-SCR-MAS	C= AC 1071	84.00 UTILITY STG-F
D= AC 1051	72.00 PORCH-OPEN-FR	F= AC 1051	30.00 PORCH-OPEN-FR		