

NOLAND QUENTIN DOUGLAS  
 3302 TEAL DR SW  
 L3S1 MILLBROOK 1.00LT  
 .357 AC

Wilson County  
 YR 2024 3701786701.000  
 3302 TEAL DR SW  
 PIN: 3701 78 6701 000  
 DISTRICT: 31 C/CIWI-WILSON

ACCOUNT#: 1116018  
 NBHD: 8192 MILLBROOK  
 Plat Bk/Pg 14 260  
 EXCD: APPR: JHB APPR DT: 11/26/2017  
 NOTICE: 82 3/08/2024

Bldg No. 1  
 Imp Desc: RSF SFR-SPLIT FOYER  
 Grade : C+10 C+10 GRADE  
 # of Units 8 Rms 4 Bedrms 2.0 Bathrms 1 HBaths  
 EYB: 2000 3302 TEAL DR SW  
 AYB: 1980 Finished Area: 1,976.00  
 Exempt Code  
 LAND VALUE 40,000  
 MISC VALUE 1,659  
 BLDG VALUE 240,866  
 TOTAL VALUE 282,525

| TYPE/CODE/DESCRIPTION           | PCT  | %CMP | UNITS        | RATE    | STR#   | STR%   | SIZ%   | HGT%   | PER% | COST     |
|---------------------------------|------|------|--------------|---------|--------|--------|--------|--------|------|----------|
| AC 1021 GARAGE-ATT-FR           | 100  |      | 416          | 42.55   |        |        | 90.00  |        |      | 15,930   |
| AC 1054 PORCH-SCR-MAS           | 100  |      | 168          | 45.80   |        |        | 102.00 |        |      | 7,848    |
| AC 1061 PATIO-CONC              | 100  |      | 312          | 7.50    |        |        | 55.00  |        |      | 1,287    |
| AC 1064 DECK-WOOD               | 100  |      | 28           | 24.95   |        |        | 120.00 |        |      | 838      |
| MA 115 SFR-SPL LVL              | 100  |      | 1040         | 136.00  | 1.22   |        | 104.38 |        |      | 147,634  |
| MA 115 (UPPER FLOORS)           | 100  |      | 229          | 136.00  | 1.22   | 100.00 | 104.38 |        |      | 32,507   |
| BA LLU LOWER LEVEL UNF          | 68   |      | 707          | 37.50   |        |        |        |        |      | 26,512   |
| BA LLF LOWER LEVEL FIN          | 100  |      | 707          | 53.00   |        |        |        |        |      | 37,471   |
| - AR 10 FORCED AIR HEAT W/ A100 |      |      | 1269         | .00     |        |        |        |        |      | 0        |
| - BT HBT HALF BATH              | 0    |      | 1            | 3667.00 |        |        |        |        |      | 3,667    |
| - EW 02 VINYL SIDING            | 100  |      | 136          | .00     |        |        |        |        |      | 0        |
| - FC 20 HARDWOOD/CARPET         | 100  |      | 1269         | 2.00    |        |        |        |        |      | 2,538    |
| - FN 03 CONT WALL-BRICK         | 100  |      | 136          | .00     |        |        |        |        |      | 0        |
| - FP 4 2STY SNGL/1STY DBL       | 100  |      | 1            | 8125.00 |        |        |        |        |      | 8,125    |
| - IF 01 DRYWALL                 | 100  |      | 1040         | .00     |        |        |        |        |      | 0        |
| - RC 02 COMPOSITION SHINGLE     | 100  |      | 1040         | .00     |        |        |        |        |      | 0        |
| - RT 03 DOUBLE PITCH ROOF       | 100  |      | 1040         | .00     |        |        |        |        |      | 0        |
| -----                           |      |      |              |         |        |        |        |        |      |          |
| RCN...                          |      |      | PCT COMPLETE |         | 100    | x      |        |        |      | 284,357  |
| QUAL..                          | C+10 |      |              |         | 110.00 | x      |        |        |      | 312,813  |
| DEPR.. RC                       |      |      |              |         | 23.00  | -      |        | 71,947 |      | 71,947 T |
| --ASV...                        |      |      |              |         |        |        |        |        |      | 240,866  |

| PROPERTY NOTES:   | PERMIT NO   | TYPE | DATE      | BOOK | PAGE | DT | DATE       | QS | SALES | PRICE   |
|---|-------------|------|-----------|------|------|----|------------|----|-------|---------|
| LOCKED GATE   | BP00081597A |      | 6/20/2008 | 2777 | 431  | WD | 3/14/2019  |    |       | 179,000 |
| REMEASURED SFD VALUE BASED FROM 2016 REVEL GRADES/OWNER HAD | AMOUNT      |      | 17,000    |      |      | @  | 10/25/1999 | @  |       |         |
| APPRAISAL FROM 2011/JHB/11/27/2017/JHB                      |             |      |           | 1275 | 873  | WD | 4/30/1985  | X  |       | 69,000  |
| PERMIT CODE: N MO/YR: 041996 NOTE: 12400                    | AMOUNT      |      |           |      |      |    |            |    |       |         |

| MISC CODE | DESC                   | UNITS  | RATE  | AYB  | EYB  | DT  | PCT   | %CMP | ADD.DEPR | PCT | VALUE | EXMPT |
|-----------|------------------------|--------|-------|------|------|-----|-------|------|----------|-----|-------|-------|
| 81 1173   | STORAGE-FRAMED 10 X 12 | 120.00 | 24.00 | 2005 | 2005 | MAV | 40.00 | 100  |          |     | 1,659 |       |
|           |                        |        |       |      |      |     | .00   |      |          |     |       |       |
|           |                        |        |       |      |      |     | .00   |      |          |     |       |       |
|           |                        |        |       |      |      |     | .00   |      |          |     |       |       |

| # | ZONE | TYPE/CODE | LAND QTY | LAND RATE | DPTH | DPT% | TOP% | LOC% | SIZ%   | SHF% | OTH% | ADJ | FMV    | EXMPT |
|---|------|-----------|----------|-----------|------|------|------|------|--------|------|------|-----|--------|-------|
| 1 | SR6  | LT 0100   | 1.000    | 40,000.00 |      | .00  | .00  | .00  | 100.00 | .00  | .00  | .00 | 40,000 |       |

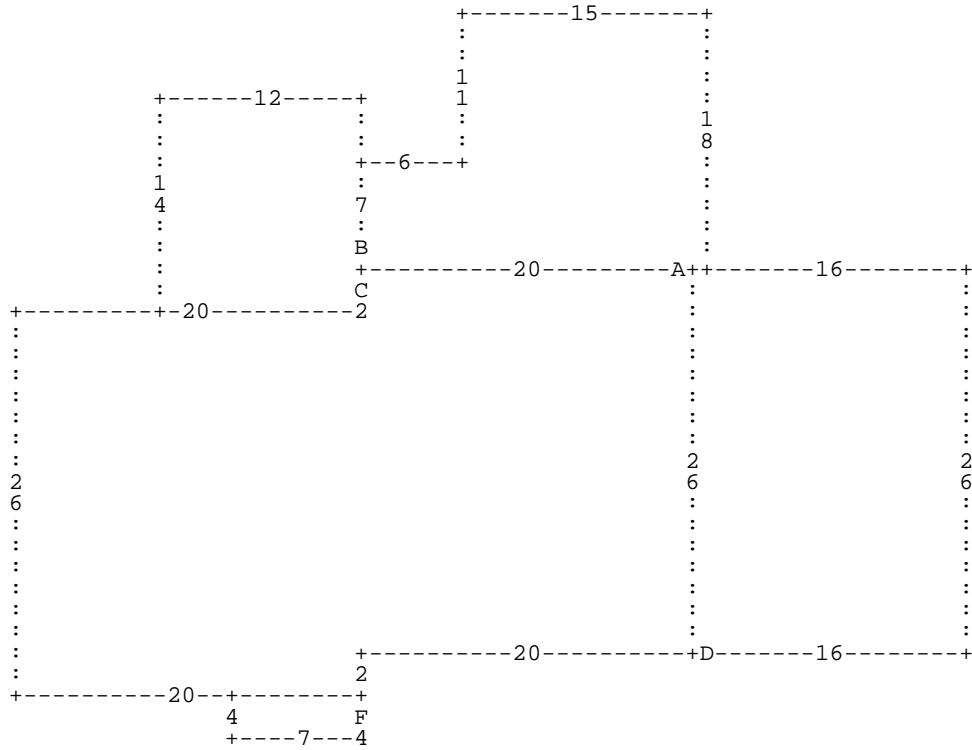

:A DL20 :B DU7 DR6 DU11 DR15 DD18 DL21 \* DD2 :C DU14 DL12 DD14 DR12 \* DL20 DD26  
 DR20 :F DD4 DL7 DU4 DR7 \* DU2 DR20 :D DR16 DU26 DL16 DD26 \* DU26 \*

**A=** MA 115  
**D=** AC 1021

1,040.00 SFR-SPL LVL  
 416.00 GARAGE-ATT-FR

**B=** AC 1061  
**F=** AC 1064

312.00 PATIO-CONC  
 28.00 DECK-WOOD

**C=** AC 1054

168.00 PORCH-SCR-MAS