

JOHNSON STEPHEN T
 3305 TEAL DR SW
 L15S1 MILLBROOK 1.00LT
 .295 AC

Wilson County
 N2 FOUND YR 2024 3701786498.000
 3305 TEAL DR SW
 PIN: 3701 78 6498 000
DISTRICT: 31 C/CIWI-WILSON

ACCOUNT#: 1097400
 NBHD: 8192 MILLBROOK
 Plat Bk/Pg 14 260
 EXCD: NOTICE: 82 3/08/2024
 APPR: REV APPR DT: 12/10/2014

Bldg No. 1
 Imp Desc: R1.0 SFR-1.0 STY EYB: 1995 3305 TEAL DR SW Exempt Code
 Grade : C+05 C+05 GRADE AYB: 1979 Finished Area: 1,802.00
 # of Units 5 Rms 3 Bedrms 2.0 Bathrms HBaths

LAND VALUE 40,000
 MISC VALUE 1,770
 BLDG VALUE 199,147
 TOTAL VALUE 240,917

TYPE/CODE/DESCRIPTION	PCT	%CMP	UNITS	RATE	STR#	STR%	SIZ%	HGT%	PER%	COST
AC 1031 CARPORT	100		315	27.90			97.00			8,524
AC 1051 PORCH-OPEN-FR	100		56	38.80			106.00			2,303
AC 1061 PATIO-CONC	100		280	7.50			58.00			1,218
AC 1071 UTILITY STG-FR	100		90	39.45			104.00			3,692
MA 111 SFR-1.0 STY	100		1802	136.00	1.00		97.50			238,945
- AR 27 ELECTRIC HEAT PUMP	100		1802	.00						0
- EW 18 BRICK VENEER	100		210	35.00						7,350
- FC 06 CARPET	100		1802	.00						0
- FN 03 CONT WALL-BRICK	100		210	.00						0
- FP 3 1STY SNGL	100		1	5100.00						5,100
- IF 30 DRYWALL/CUSTOM	100		1802	.00						0
- RC 02 COMPOSITION SHINGLE	100		1802	.00						0
- RT 03 DOUBLE PITCH ROOF	100		1802	.00						0
RCN...			PCT COMPLETE		100	x				267,132
QUAL..	C+05				105.00	x				280,488
DEPR.. RC					29.00	-		81,341		81,341 T
--ASV...										199,147

PROPERTY NOTES:

PERMIT NO	TYPE	DATE	BOOK	PAGE	DT	DATE	QS	SALES	PRICE
			2524	305	WD	3/22/2013			128,000
AMOUNT			2241	316	WD	4/09/2007			141,000
AMOUNT			1175	392	WD	6/08/1979	@		57,000

MISC CODE	DESC	UNITS	RATE	AYB	EYB	DT	PCT	%CMP	ADD.DEPR	PCT	VALUE	EXMPT
81 1173	STG-FR 8 X 16	128.00	24.00	2005	2005	MAV	40.00	100			1,770	
							.00					
							.00					
							.00					

#	ZONE	TYPE/CODE	LAND QTY	LAND RATE	DPH	DPT%	TOP%	LOC%	SIZ%	SHP%	OTH%	ADJ	FMV	EXMPT
1	SR6	LT 0100	1.000	40,000.00	127	.00	.00	.00	100.00	.00	.00	.00	40,000	

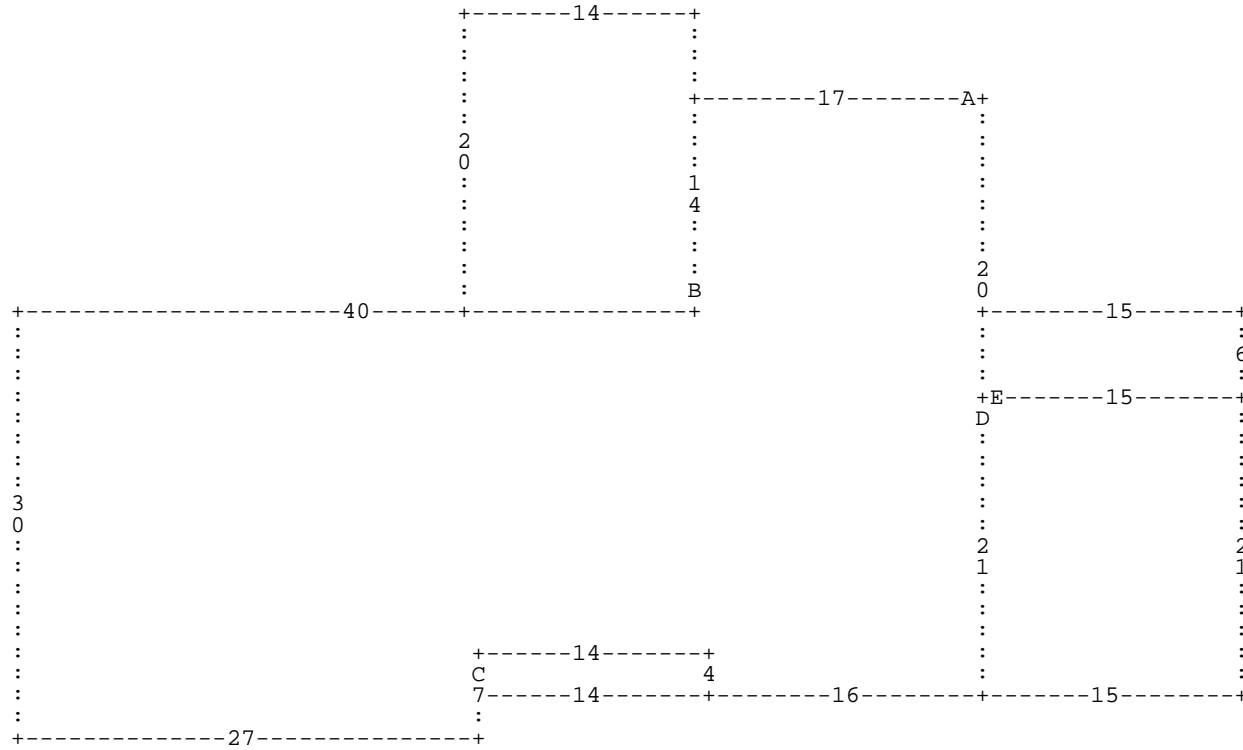

:A DL17 DD14 :B DU20 DL14 DD20 DR14 * DL40 DD30 DR27 DU7 :C DD4 DR14 DU4 DL14 *
 DR14 DD4 DR16 DU21 :D DD21 DR15 DU21 DL15 * :E DR15 DU6 DL15 DD6 * DU20 *

A= MA 111
D= AC 1031

1,802.00 SFR-1.0 STY
 315.00 CARPORT

B= AC 1061
E= AC 1071

280.00 PATIO-CONC
 90.00 UTILITY STG-F

C= AC 1051

56.00 PORCH-OPEN-FR