

WINDHAM VURGIA STRICKLAND  
 3400 MILLBROOK DR SW  
 L45S2 MILLBROOK 1.00LT  
 .423 AC

Wilson County  
 YR 2024 3701772732.000  
 3400 MILLBROOK DR SW  
 PIN: 3701 77 2732 000  
 DISTRICT: 31 C/CIWI-WILSON

ACCOUNT#: 1020264  
 NBHD: 8192 MILLBROOK  
 Plat Bk/Pg 15 72  
 EXCD: APPR: REV APPR DT: 12/10/2014  
 NOTICE: 82 3/08/2024

Bldg No. 1  
 Imp Desc: R1.0 SFR-1.0 STY EYB: 2000 3400 MILLBROOK DR SW Exempt Code  
 Grade : C+10 C+10 GRADE AYB: 1980 Finished Area: 1,752.00  
 # of Units 5 Rms 3 Bedrms 2.0 Bathrms HBaths  
 LAND VALUE 44,000  
 MISC VALUE 1,516  
 BLDG VALUE 220,468  
 TOTAL VALUE 265,984

TYPE/CODE/DESCRIPTION	PCT	%CMP	UNITS	RATE	STR#	STR%	SIZ%	HGT%	PER%	COST
AC 1031 CARPORT	100		276	27.90			97.00			7,469
AC 1051 PORCH-OPEN-FR	100		120	38.80			104.00			4,842
AC 1061 PATIO-CONC	100		240	7.50			58.00			1,044
AC 1071 UTILITY STG-FR	100		42	39.45			110.00			1,822
MA 111 SFR-1.0 STY	100		1752	136.00	1.00		98.00			233,506
- AR 10 FORCED AIR HEAT W/ A100	100		1752	.00						0
- EW 18 BRICK VENEER	100		186	35.00						6,510
- FC 06 CARPET	100		1752	.00						0
- FN 03 CONT WALL-BRICK	100		186	.00						0
- FP 3 1STY SNGL	100		1	5100.00						5,100
- IF 30 DRYWALL/CUSTOM	100		1752	.00						0
- RC 02 COMPOSITION SHINGLE	100		1752	.00						0
- RT 03 DOUBLE PITCH ROOF	100		1752	.00						0
RCN... PCT COMPLETE					100	x				260,293
QUAL.. C+10					110.00	x				286,322
DEPR.. RC					23.00	-		65,854		65,854 T
--ASV...										220,468

PROPERTY NOTES:

PERMIT NO	TYPE	DATE	BOOK	PAGE	DT	DATE	QS	SALES	PRICE
			2017	CDTH	CDTH	7/16/2017	E		
AMOUNT					@	10/25/1999	@		
			1451	865	WD	6/30/1992	X	89,000	
AMOUNT			1193	826	WD	8/01/1980	X	70,000	

MISC CODE	DESC	UNITS	RATE	AYB	EYB	DT	PCT	%CMP	ADD.DEPR	PCT	VALUE	EXMPT
81 1173	STORAGE 012 X 016	192.00	24.00	1980	1980	MAV	65.00	100			1,516	
							.00					
							.00					
							.00					

#	ZONE	TYPE/CODE	LAND QTY	LAND RATE	DPTH	DPT%	TOP%	LOC%	SIZ%	SHP%	OTH%	ADJ	FMV	EXMPT
1	SR6	LT 0100	1.000	40,000.00	155	.00	.00	.00	110.00	.00	.00	110.00	44,000	

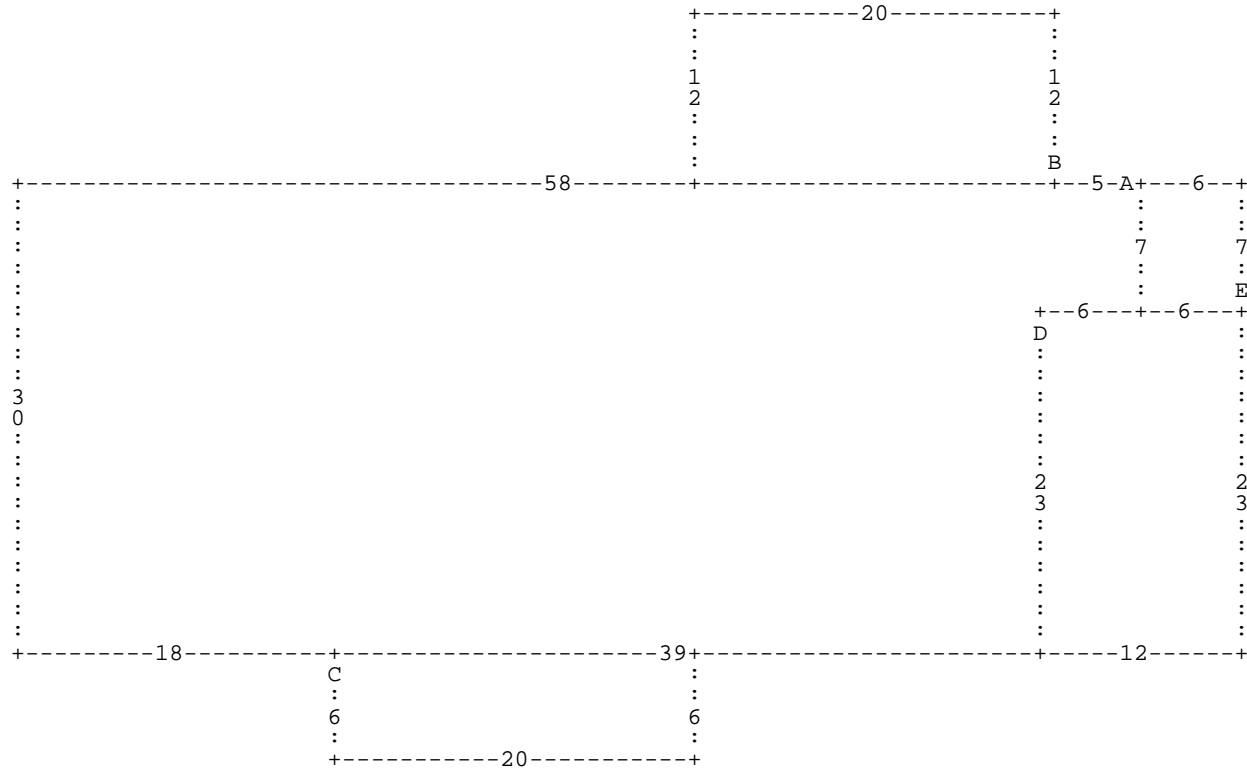

:A DL5 :B DU12 DL20 DD12 DR20 \* DL58 DD30 DR18 :C DD6 DR20 DU6 DL20 \* DR39 DU23  
 :D DD23 DR12 DU23 :E DU7 DL6 DD7 DR6 \* DL12 \* DR6 DU7 \*

**A=** MA 111  
**D=** AC 1031

1,752.00 SFR-1.0 STY  
 276.00 CARPORT

**B=** AC 1061  
**E=** AC 1071

240.00 PATIO-CONC  
 42.00 UTILITY STG-F

**C=** AC 1051

120.00 PORCH-OPEN-FR