

SLEEPY HOLLOW DEVELOPMENT CO
 3557 OLD DAM DR SW
 L15S1 SLEEPY HOLLOW 1LT
 .262 AC

Wilson County
 YR 2024 3701374215.000
 3557 OLD DAM DR SW
 PIN: 3701 37 4215 000
 DISTRICT: 31 C/CIWI-WILSON

ACCOUNT#: 69924435
 NBHD: 8283 SLEEPY_HOLLOW_RA-8
 Plat Bk/Pg 23 88 APPR: REV APPR DT: 12/16/2014
 EXCD: NOTICE: 82 3/08/2024

Bldg No. 1
 Imp Desc: 6201 SFR- DUPLEX/TRIPLEX EYB: 1994 3557 OLD DAM DR SW Exempt Code
 Grade : C+05 C+05 GRADE AYB: 1994 Finished Area: 1,435.00
 # of Units 2 Rms Bedrms Bathrms HBaths
 LAND VALUE 20,000
 MISC VALUE 0
 BLDG VALUE 145,343
 TOTAL VALUE 165,343

TYPE/CODE/DESCRIPTION	PCT	%CMP	UNITS	RATE	STR#	STR%	SIZ%	HGT%	PER%	COST
AC 2031 CARPORT	100		210	27.90			110.00			6,444
AC 2051 PORCH-OPEN-FR	100		60	38.80			106.00			2,467
AC 2061 PATIO-CONC	100		96	7.50			70.00			504
AC 2061 PATIO-CONC	100		96	7.50			70.00			504
AC 2071 UTILITY STG-FR	100		136	28.50			102.00			3,953
MA 251 APT-DUPLEX/TRIPLEX	100		1435	118.00	1.00		113.00			191,342
- AR 27 ELECTRIC HEAT PUMP	100		1435	.00						0
- EW 18 BRICK VENEER	100		152	35.00						5,320
- FC 48 VINYL/CARPET	100		1435	.00						0
- FN 06 SPREAD FOOTING	100		152	5.30-						805-
- IF 01 DRYWALL	100		1435	.00						0
- RC 02 COMPOSITION SHINGLE	100		1435	.00						0
- RT 03 DOUBLE PITCH ROOF	100		1435	.00						0

RCN... PCT COMPLETE 100 x 209,729
 QUAL.. C+05 105.00 x 220,215
 DEPR.. C50 34.00 - 74,872 T
 --ASV... 145,343

PROPERTY NOTES:

PERMIT NO	TYPE	DATE	BOOK	PAGE	DT	DATE	QS	SALES	PRICE
			1402	665	WD	10/25/1999	@		
AMOUNT			1392	142	WD	6/22/1990	U		
AMOUNT			1380	880	WD	1/01/1990	X		
						7/01/1989	X		

MISC CODE	DESC	UNITS	RATE	AYB	EYB	DT	PCT	%CMP	ADD.DEPR	PCT	VALUE	EXMPT
							.00					
							.00					
							.00					
							.00					

#	ZONE	TYPE/CODE	LAND QTY	LAND RATE	DPTH	DPT%	TOP%	LOC%	SIZ%	SHP%	OTH%	ADJ	FMV	EXMPT
1	UR	LT 0562	1.000	20,000.00	135	.00	.00	.00	100.00	.00	.00	.00	20,000	

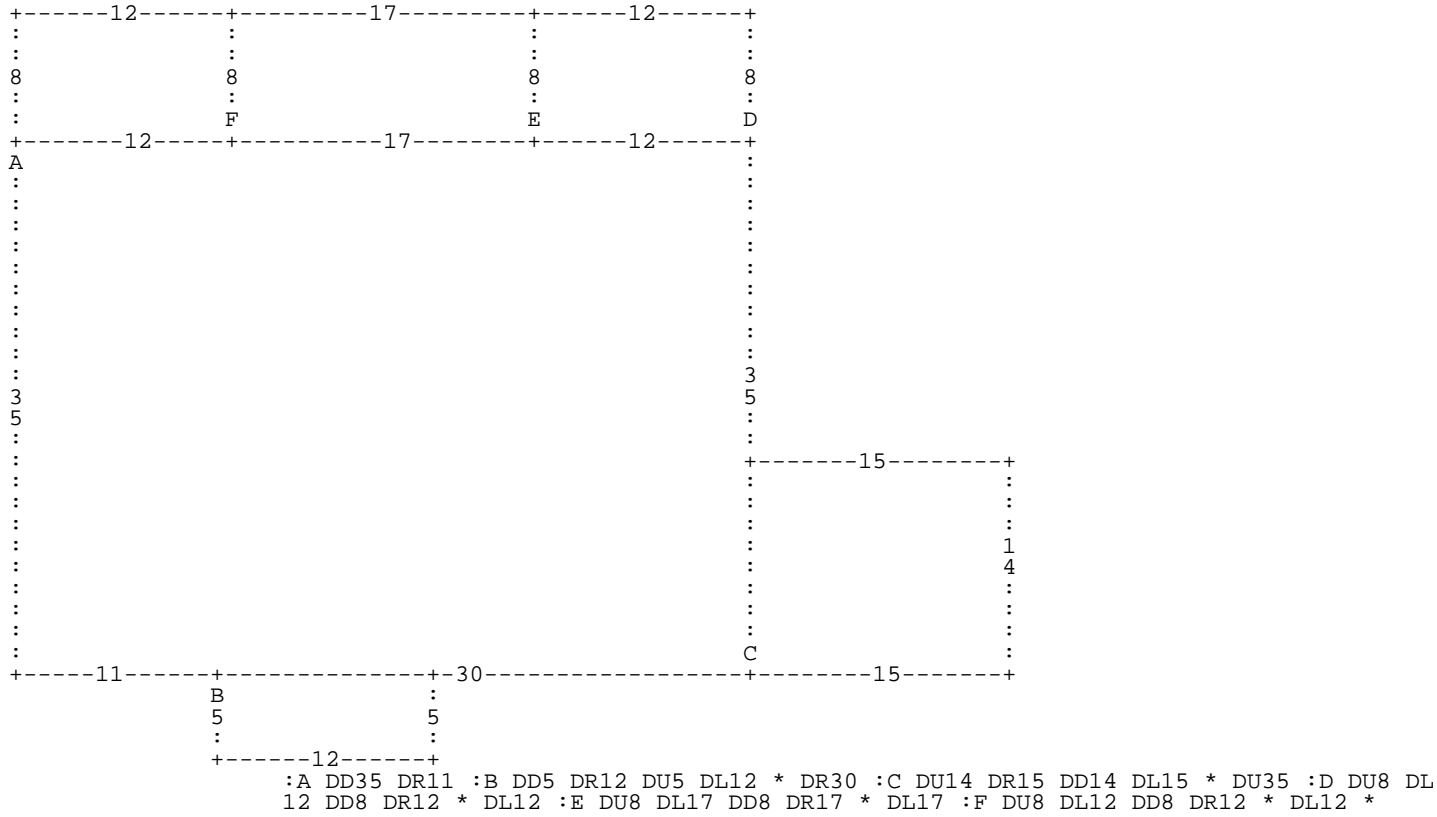

A= MA 251
D= AC 2061

1,435.00 APT-DUPLEX/TR
96.00 PATIO-CONC

B= AC 2051
E= AC 2071

60.00 PORCH-OPEN-FR
136.00 UTILITY STG-F

C= AC 2031
F= AC 2061

210.00 CARPORT
96.00 PATIO-CONC