

WINSTEAD GROVER  
 7024 CHURCH ST  
 L1S1 KINGSWD SUB 1.00LT  
 .389 AC

N2 FOUND YR 2024 **3669464118.000**  
 7024 CHURCH ST  
 PIN: 3669 46 4118 000  
**DISTRICT:** 9 C/CISA-SARATOGA

Wilson County

**ACCOUNT#:** 69953496 **PAGE** 1  
**NBHD:** 8475 KINGSWOOD SUBD-SARATOGA  
 Plat Bk/Pg 22 41 **APPR:** REV APPR DT: 8/13/2015  
**EXCD:** NOTICE: 82 3/08/2024

Bldg No. 1  
 Imp Desc: R1.0 SFR-1.0 STY EYB: 1992 7024 CHURCH ST Exempt Code  
 Grade : C-05 C-05 GRADE AYB: 1992 Finished Area: 984.00  
 # of Units 3 Rms 2 Bedrms 1.0 Bathrms HBaths

**LAND VALUE** 25,000  
**MISC VALUE** 0  
**BLDG VALUE** 94,916  
**TOTAL VALUE** 119,916

TYPE/CODE/DESCRIPTION	PCT	%CMP	UNITS	RATE	STR#	STR%	SIZ%	HGT%	PER%	COST
AC 1052 PORCH-OPEN-MAS	100		80	29.10			106.00			2,467
AC 1053 STOOP-MAS	100		55	19.40			106.00			1,131
AC 1072 UTILITY STG-MAS	100		72	41.40			106.00			3,159
MA 111 SFR-1.0 STY	100		984	136.00	1.00		109.25			146,202
- AR 27 ELECTRIC HEAT PUMP	100		984	.00						0
- BT BT FULL BATH	100		1-	5500.00						5,500-
- EW 18 BRICK VENEER	100		132	35.00						4,620
- FC 48 VINYL/CARPET	100		984	.00						0
- FN 06 SPREAD FOOTING	100		132	5.30-						699-
- IF 01 DRYWALL	100		984	.00						0
- RC 02 COMPOSITION SHINGLE	100		984	.00						0
- RT 03 DOUBLE PITCH ROOF	100		984	.00						0
RCN...			PCT COMPLETE		100	x				151,380
QUAL..	C-05				95.00	x				143,811
DEPR.. RC					34.00	-		48,895		48,895 T
--ASV...										94,916

PROPERTY NOTES:

PERMIT NO	TYPE	DATE	BOOK	PAGE	DT	DATE	QS	SALES	PRICE
			2098	639	WD	4/19/2005	X		67,500
AMOUNT			1991	815	TD	10/06/2003	P		
					@	10/25/1999	@		
AMOUNT			1444	206	WD	4/15/1992	X		8,000

MISC CODE	DESC	UNITS	RATE	AYB	EYB	DT	PCT	%CMP	ADD.DEPR	PCT	VALUE	EXMPT
							.00					
							.00					
							.00					
							.00					

#	ZONE	TYPE/CODE	LAND	QTY	LAND RATE	DPTH	DPT%	TOP%	LOC%	SIZ%	SHP%	OTH%	ADJ	FMV	EXMPT
1	RA	LT 0100		1.000	25,000.00		.00	.00	.00	100.00	.00	.00	.00	25,000	

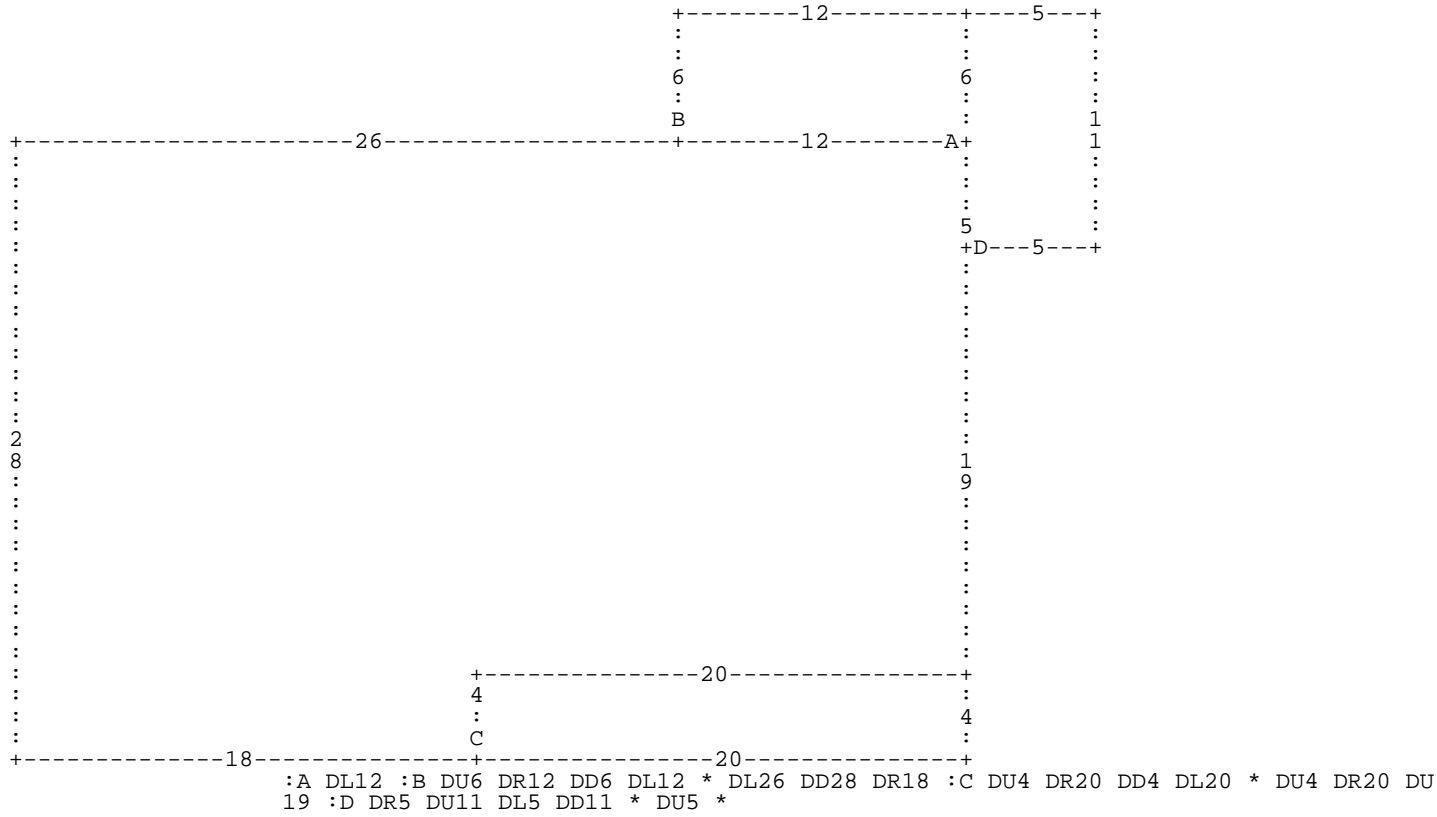

A= MA 111  
D= AC 1053

984.00 SFR-1.0 STY  
55.00 STOOP-MAS

B= AC 1072

72.00 UTILITY STG-M

C= AC 1052

80.00 PORCH-OPEN-MA