

DOWELL FLEXCIA
 8205 IDA ST
 .51AC 1.00LT
 .504 AC

Wilson County
 YR 2024 3669249365.000
 8205 IDA ST
 PIN: 3669 24 9365 000
 DISTRICT: 9 C/CISA-SARATOGA

ACCOUNT#: 1078619
 NBHD: 8261 SARATOGA_R-10
 Plat Bk/Pg
 EXCD: NOTICE: 82 3/08/2024
 APPR: REV APPR DT: 8/14/2015
 PAGE 1

Bldg No. 1
 Imp Desc: R1.5 SFR-UPTO 1.5 STY EYB: 1993 8205 IDA ST Exempt Code
 Grade : C C GRADE AYB: 1988 Finished Area: 2,086.00
 # of Units 5 Rms 3 Bedrms 2.0 Bathrms HBaths

LAND VALUE 20,000
 MISC VALUE 10,955
 BLDG VALUE 156,737
 TOTAL VALUE 187,692

TYPE/CODE/DESCRIPTION	PCT	%CMP	UNITS	RATE	STR#	STR%	SIZ%	HGT%	PER%	COST
AC 1053 STOOP-MAS	100		24	19.40			120.00			558
AC 1053 STOOP-MAS	100		20	19.40		100.00	120.00			465
MA 112 SFR-1.5 STY	100		1896	116.00	1.00		96.75			212,788
AT FAT FIN ATTIC	10		190	68.00						12,920
- AR 10 FORCED AIR HEAT W/ A100			1896	.00						0
- EW 02 VINYL SIDING	100		192	.00						0
- FC 20 HARDWOOD/CARPET	100		1896	2.00						3,792
- FN 03 CONT WALL-BRICK	100		192	.00						0
- IF 01 DRYWALL	100		1896	.00						0
- RC 07 WOOD SHAKES/3D-SHING	100		1896	.00						0
- RT 03 DOUBLE PITCH ROOF	100		1896	.00						0

RCN...			PCT COMPLETE		100	x				230,523
QUAL..	C				100.00	x				230,495
DEPR..	RC				32.00	-		73,758		73,758 T
--ASV...										156,737

PROPERTY NOTES:
 ADDT & CORRECTED SKT N 07.

PERMIT NO	TYPE	DATE	BOOK	PAGE	DT	DATE	QS	SALES	PRICE
			2409	852	WD	6/17/2010	I	110,000	
			2384	89	TD	10/22/2009	P	120,000	
			2338	25	WD	10/16/2008	R	120,000	
					@	10/25/1999	@		

MISC CODE	DESC	UNITS	RATE	AYB	EYB	DT	PCT	%CMP	ADD.DEPR	PCT	VALUE	EXMPT
81 1121	GAR-DET-FR 20 X 20	400.00	51.50	1990	1990	MAV	65.00	100			7,210	
82 1131	CARPORT-DET-FR 20 X 20	400.00	26.75	1990	1990	MAV	65.00	100			3,745	
							.00					
							.00					

#	ZONE	TYPE/CODE	LAND QTY	LAND RATE	DPTH	DPT%	TOP%	LOC%	SIZ%	SHP%	OTH%	ADJ	FMV	EXMPT
1	R10	LT 0100	1.000	20,000.00		.00	.00	.00	100.00	.00	.00	.00	20,000	

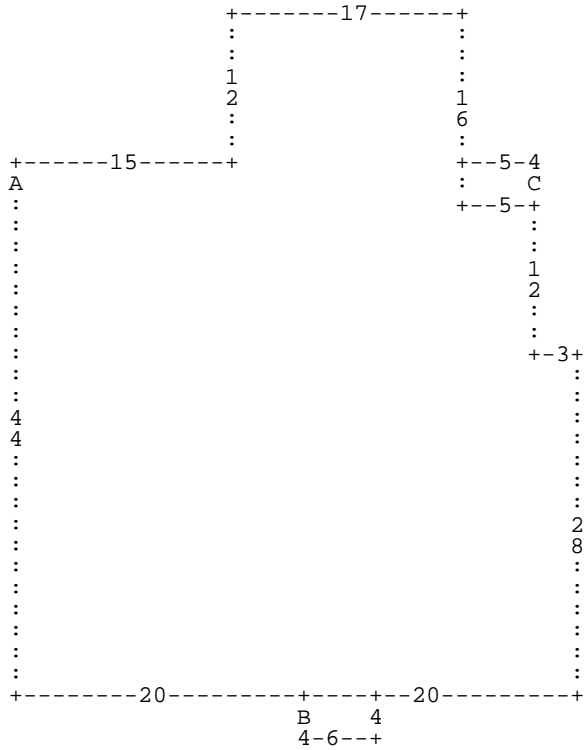

:A DD44 DR20 :B DD4 DR6 DU4 DL6 * DR20 DU28 DL3 DU12 :C DU4 DL5 DD4 DR5 * DL5 DU
 16 DL17 DD12 DL15 *

A= MA 112

1,896.00 SFR-1.5 STY

B= AC 1053

24.00 STOOP-MAS

C= AC 1053

20.00 STOOP-MAS