

THIGPEN EDWARD LEE JR  
 6011 GRIMSLEY STORE RD  
 GOFF PL .92AC

Wilson County  
 YR 2024 3659065489.000  
 6011 GRIMSLEY STORE RD  
 PIN: 3659 06 5489 000  
 DISTRICT: 26 C/SW/SANOCA FD SWAF

ACCOUNT#: 69952586  
 NBHD: 8264 SARATOGA\_TWP  
 Plat Bk/Pg 1.00 EXCD:  
 APPR: REV APPR DT: 8/07/2015  
 NOTICE: 82 3/08/2024

Bldg No. 1  
 Imp Desc: R1.0A SFR-1.0 STY W/ADDN EYB: 1980 6011 GRIMSLEY STORE RD Exempt Code  
 Grade : C+05 C+05 GRADE AYB: 1975 Finished Area: 2,257.00  
 # of Units 5 Rms 3 Bedrms 2.0 Bathrms HBaths

LAND VALUE 19,688  
 MISC VALUE 28,130  
 BLDG VALUE 165,071  
 TOTAL VALUE 212,889

TYPE/CODE/DESCRIPTION	PCT	%CMP	UNITS	RATE	STR#	STR%	SIZ%	HGT%	PER%	COST
AC 1051 PORCH-OPEN-FR	100		100	38.80			104.00			4,035
AC 1064 DECK-WOOD	100		480	24.95			90.00			10,778
AC 1071 UTILITY STG-FR	100		65	39.45			106.00			2,718
MA 111 SFR-1.0 STY	100		1729	136.00	1.00		98.25			231,028
- AR 10 FORCED AIR HEAT W/ A100			1729	.00						0
- EW 18 BRICK VENEER	100		220	35.00						7,700
- FC 0608 CARPET/CERAMIC TILE	100		1729	8.50						14,696
- FN 03 CONT WALL-BRICK	100		220	.00						0
- FP 3 1STY SNGL	100		1	5100.00						5,100
- IF 07 DRYWALL/PANELING	100		1729	.00						0
- RC 02 COMPOSITION SHINGLE	100		1729	.00						0
- RT 03 DOUBLE PITCH ROOF	100		1729	.00						0
MA 191 SFR-ADDT FR	100		528	102.00	1.00		122.00			65,704

RCN... PCT COMPLETE 100 x 341,759  
 QUAL.. C+05 105.00 x 358,848  
 DEPR.. RC 54.00 - 193,777 T  
 --ASV... 165,071

PROPERTY NOTES:

PERMIT NO	TYPE	DATE	BOOK	PAGE	DT	DATE	QS	SALES	PRICE
			2072	550	WD	11/30/2004	X		
AMOUNT					@	10/25/1999	@		
AMOUNT			1103	317	WD	9/01/1974	X		

MISC CODE	DESC	UNITS	RATE	AYB	EYB	DT	PCT	%CMP	ADD.DEPR	PCT	VALUE	EXMPT
81 1173	STG-FR 8 X 10	80.00	24.00	1980	1983	MFR	75.00	100			352	
82 1121	GAR-DET-FR 28 X 60	1,680.00	51.50	1980	1983	MAV	65.00	100			27,254	
83 1142	LEAN-TO 10 X 30	300.00	4.80	1993	1993	MAV	65.00	100			524	

#	ZONE	TYPE/CODE	LAND QTY	LAND RATE	DPTH	DPT%	TOP%	LOC%	SIZ%	SHP%	OTH%	ADJ	FMV	EXMPT
1	AR	AC 5010	.920	20,000.00		.00	.00	.00	107.00	.00	.00	107.00	19,688	

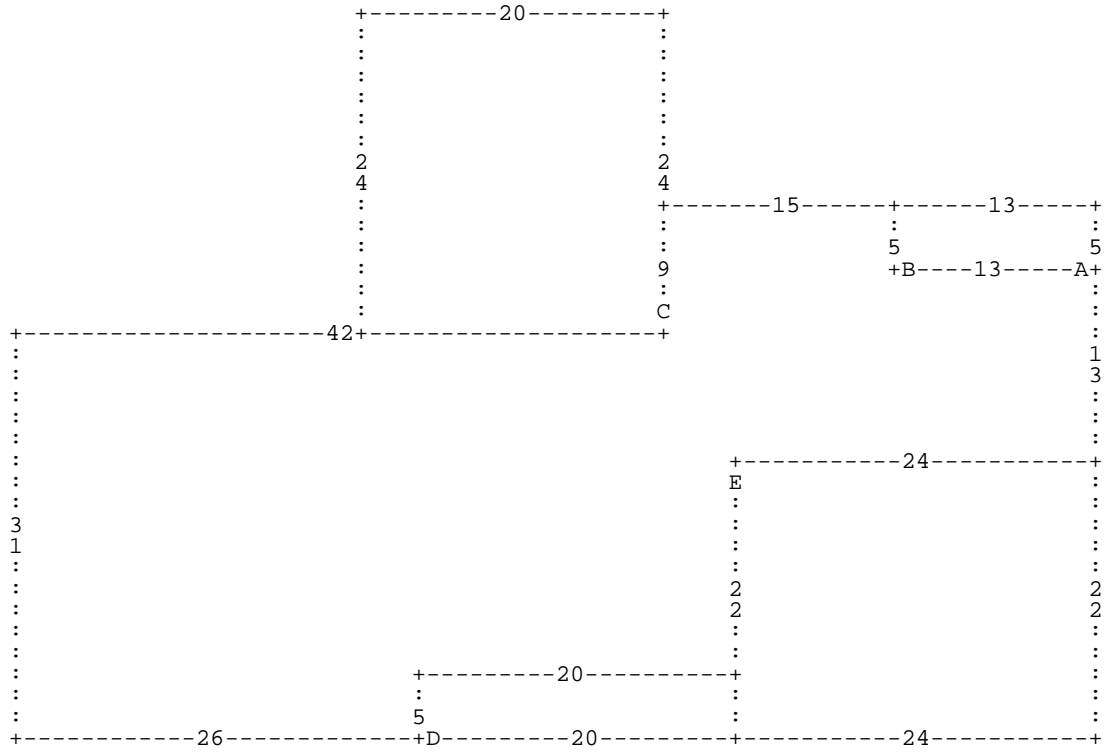

:A DL13 :B DR13 DU5 DL13 DD5 \* DU5 DL15 DD9 :C DU24 DL20 DD24 DR20 \* DL42 DD31 D  
R26 :D DR20 DU5 DL20 DD5 \* DU5 DR20 DU17 :E DD22 DR24 DU22 DL24 \* DR24 DU13 \*

**A=** MA 111  
**D=** AC 1051

1,729.00 SFR-1.0 STY  
100.00 PORCH-OPEN-FR

**B=** AC 1071  
**E=** MA 191

65.00 UTILITY STG-F  
528.00 SFR-ADDT FR

**C=** AC 1064

480.00 DECK-WOOD