

JOYNER DALTON E
 5252 CASTLEWOOD DR
 L14S3 KNOLLWOOD 1.00LT
 .299 AC

N2 FOUND YR 2024 **3629406330.000**
 5252 CASTLEWOOD DR
 PIN: 3629 40 6330 000
DISTRICT: 16 C/SW/LEE WOODAR SWAF

Wilson County

ACCOUNT#: 15199890
NBHD: 8155 KNOLLWOOD
 Plat Bk/Pg 27 8
EXCD: 1.00
 APPR: REV APPR DT: 8/06/2015
 NOTICE: 82 3/08/2024

Bldg No. 1
 Imp Desc: R1.0A SFR-1.0 STY W/ADDN EYB: 2006 5252 CASTLEWOOD DR Exempt Code
 Grade : C+05 C+05 GRADE AYB: 2001 Finished Area: 1,600.00
 # of Units 5 Rms 3 Bedrms 2.0 Bathrms HBaths

LAND VALUE 30,000
MISC VALUE 6,536
BLDG VALUE 196,981
TOTAL VALUE 233,517

TYPE/CODE/DESCRIPTION	PCT	%CMP	UNITS	RATE	STR#	STR%	SIZ%	HGT%	PER%	COST
AC 1052 PORCH-OPEN-MAS	100		20	29.10			120.00			698
AC 1061 PATIO-CONC	100		120	7.50		100.00	64.00			576
AC 1071 UTILITY STG-FR	100		40	39.45			110.00			1,735
MA 111 SFR-1.0 STY	100		1390	136.00	1.00		102.50			193,766
- AR 14 GAS PACK	100		1390	.00						0
- EW 02 VINYL SIDING	100		162	.00						0
- FC 48 VINYL/CARPET	100		1390	.00						0
- FN 03 CONT WALL-BRICK	100		162	.00						0
- IF 30 DRYWALL/CUSTOM	100		1390	.00						0
- RC 07 WOOD SHAKES/3D-SHING	100		1390	.00						0
- RT 03 DOUBLE PITCH ROOF	100		1390	.00						0
MA 191 SFR-ADDT FR	100		210	102.00	1.00		124.00			26,560
RCN...					100	x				223,335
QUAL..	C+05				105.00	x				234,501
DEPR..	RC				16.00	-		37,520		37,520 T
--ASV...										196,981

PROPERTY NOTES:	PERMIT NO	TYPE	DATE	BOOK	PAGE	DT	DATE	QS	SALES	PRICE
ADDED R10 AND PTO/JHB	BP01300084A		3/12/2013	1882	925	WD	6/04/2002			15,000
PERMIT CODE: N MO/YR: 102002 NOTE: 1900	AMOUNT			1882	923	WD	6/04/2002	X		15,000
PERMIT CODE: N MO/YR: 052002 NOTE: 73500	AMOUNT			90E	305	WI	10/25/1999	@		
							7/21/1990	@		E

MISC CODE	DESC	UNITS	RATE	AYB	EYB	DT	PCT	%CMP	ADD.DEPR	PCT	VALUE	EXMPT
81 1121	GAR-DET-FR 30 X 24	720.00	51.50	2003	2006	MFR	75.00	100			6,536	
							.00					
							.00					
							.00					

#	ZONE	TYPE/CODE	LAND QTY	LAND RATE	DPTH	DPT%	TOP%	LOC%	SIZ%	SHP%	OTH%	ADJ	FMV	EXMPT
1	AR	LT 5010	1.000	30,000.00		.00	.00	.00	100.00	.00	.00	.00	30,000	

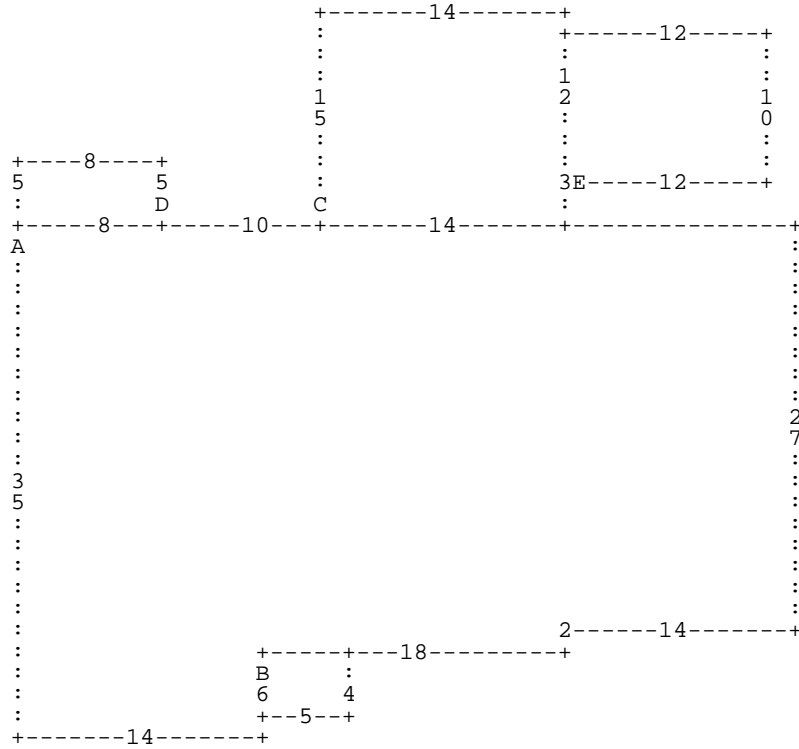

```

:A DD35 DR14 DU6 :B DD4 DR5 DU4 DL5 * DR18 DU2 DR14 DU27 DL28 :C DU15 DR14 DD12
:E DR12 DU10 DL12 DD10 * DD3 DL14 * DL10 :D DU5 DL8 DD5 DR8 * DL8 *

```

A= MA 111
D= AC 1071

1,390.00 SFR-1.0 STY
40.00 UTILITY STG-F

B= AC 1052
E= AC 1061

20.00 PORCH-OPEN-MA
120.00 PATIO-CONC

C= MA 191

210.00 SFR-ADDT FR