

VASQUEZ TERRY C  
 5212 EVANSDALE RD  
 BK-C L10S1 KNOLLWD 1.00LT  
 .266 AC

Wilson County  
 YR 2024 3629402263.000  
 5212 EVANSDALE RD  
 PIN: 3629 40 2263 000  
 DISTRICT: 16 C/SW/LEE WOODAR SWAF

ACCOUNT#: 69954421  
 NBHD: 8155 KNOLLWOOD  
 Plat Bk/Pg 16 21  
 EXCD: 1.00  
 APPR: KRC APPR DT: 1/25/2018  
 NOTICE: 82 3/08/2024

Bldg No. 1  
 Imp Desc: R1.0 SFR-1.0 STY  
 Grade : C+05 C+05 GRADE  
 # of Units 5 Rms 3 Bedrms 2.0 Bathrms HBaths  
 EYB: 2005 5212 EVANSDALE RD  
 AYB: 1994 Finished Area: 1,277.00  
 Exempt Code  
 LAND VALUE 30,000  
 MISC VALUE 238  
 BLDG VALUE 167,621  
 TOTAL VALUE 197,859

| TYPE/CODE/DESCRIPTION           | PCT  | %CMP | UNITS | RATE    | STR#   | STR% | SIZ%   | HGT%   | PER% | COST     |
|---------------------------------|------|------|-------|---------|--------|------|--------|--------|------|----------|
| AC 1052 PORCH-OPEN-MAS          | 100  |      | 25    | 29.10   |        |      | 120.00 |        |      | 873      |
| AC 1064 DECK-WOOD               | 100  |      | 144   | 24.95   |        |      | 102.00 |        |      | 3,664    |
| AC 1071 UTILITY STG-FR          | 100  |      | 48    | 39.45   |        |      | 110.00 |        |      | 2,082    |
| MA 111 SFR-1.0 STY              | 100  |      | 1277  | 136.00  | 1.00   |      | 104.00 |        |      | 180,618  |
| - AR 10 FORCED AIR HEAT W/ A100 |      |      | 1277  | .00     |        |      |        |        |      | 0        |
| - EW 02 VINYL SIDING            | 100  |      | 158   | .00     |        |      |        |        |      | 0        |
| - FC 48 VINYL/CARPET            | 100  |      | 1277  | .00     |        |      |        |        |      | 0        |
| - FN 03 CONT WALL-BRICK         | 100  |      | 158   | .00     |        |      |        |        |      | 0        |
| - FP 3 1STY SNGL                | 0    |      | 1     | 5100.00 |        |      |        |        |      | 5,100    |
| - IF 30 DRYWALL/CUSTOM          | 100  |      | 1277  | .00     |        |      |        |        |      | 0        |
| - RC 07 WOOD SHAKES/3D-SHING    | 100  |      | 1277  | .00     |        |      |        |        |      | 0        |
| - RT 03 DOUBLE PITCH ROOF       | 100  |      | 1277  | .00     |        |      |        |        |      | 0        |
| RCN...                          |      |      |       |         | 100    | x    |        |        |      | 192,337  |
| QUAL..                          | C+05 |      |       |         | 105.00 | x    |        |        |      | 201,953  |
| DEPR..                          | RC   |      |       |         | 17.00  | -    |        | 34,332 |      | 34,332 T |
| --ASV...                        |      |      |       |         |        |      |        |        |      | 167,621  |

| PROPERTY NOTES:                                | PERMIT NO | TYPE | DATE | BOOK | PAGE | DT | DATE       | QS | SALES | PRICE   |
|--|-----------|------|------|------|------|----|------------|----|-------|---------|
| NEW FLOORS, WINDOWS, HVAC PER TAX LISTING 4'18 |           |      |      | 2126 | 303  | WD | 8/31/2005  | X  |       | 108,000 |
|  | AMOUNT    |      |      | 1881 | 881  | WD | 5/30/2002  | U  |       | 94,000  |
|  | AMOUNT    |      |      | 1741 | 198  | WD | 11/03/1999 | E  |       |         |
|  |           |      |      |      |      | @  | 10/25/1999 | @  |       |         |

| MISC CODE | DESC              | UNITS | RATE  | AYB  | EYB  | DT  | PCT   | %CMP | ADD.DEPR | PCT | VALUE | EXMPT |
|-----------|-------------------|-------|-------|------|------|-----|-------|------|----------|-----|-------|-------|
| 81 1173   | STORAGE 009 X 006 | 54.00 | 24.00 | 1996 | 1996 | MFR | 75.00 | 100  |          |     | 238   |       |
|           |                   |       |       |      |      |     | .00   |      |          |     |       |       |
|           |                   |       |       |      |      |     | .00   |      |          |     |       |       |
|           |                   |       |       |      |      |     | .00   |      |          |     |       |       |

| # | ZONE | TYPE/CODE | LAND QTY | LAND RATE | DPTH | DPT% | TOP% | LOC% | SIZ%   | SHP% | OTH% | ADJ | FMV    | EXMPT |
|---|------|-----------|----------|-----------|------|------|------|------|--------|------|------|-----|--------|-------|
| 1 | AR   | LT 5010   | 1.000    | 30,000.00 |      | .00  | .00  | .00  | 100.00 | .00  | .00  | .00 | 30,000 |       |

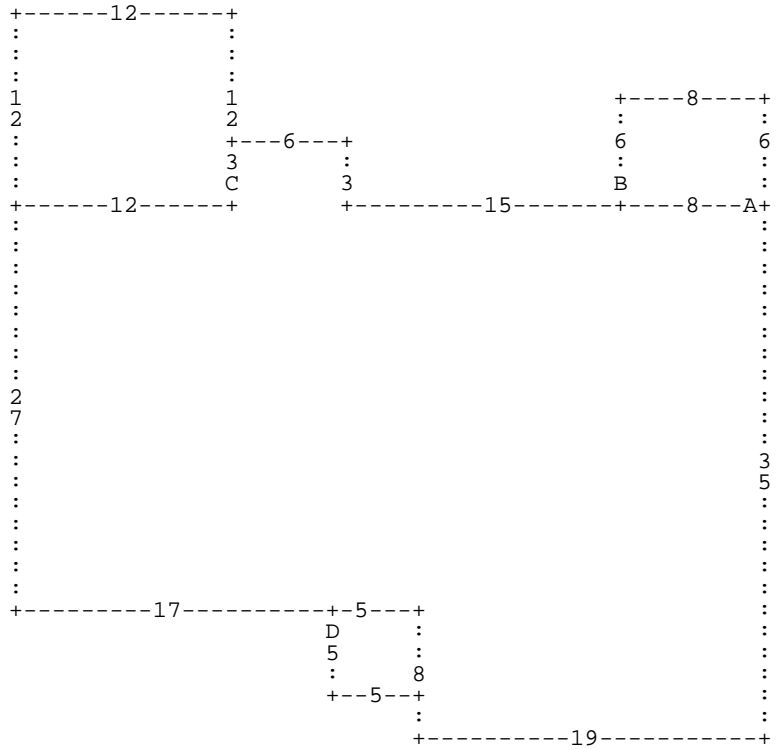

:A DL8 :B DU6 DR8 DD6 DL8 \* DL15 DU3 DL6 DD3 :C DU12 DL12 DD12 DR12 \* DL12 DD27  
 DR17 :D DD5 DR5 DU5 DL5 \* DR5 DD8 DR19 DU35 \*

**A=** MA 111  
**D=** AC 1052

1,277.00 SFR-1.0 STY  
 25.00 PORCH-OPEN-MA

**B=** AC 1071

48.00 UTILITY STG-F

**C=** AC 1064

144.00 DECK-WOOD