

GLOVER TINA WILLIAMSON
 5337 CASTLEWOOD DR
 L8S2 KNOLLWOOD 1.00LT
 .318 AC

Wilson County
 YR 2024 3629304718.000
 5337 CASTLEWOOD DR
 PIN: 3629 30 4718 000
 DISTRICT: 16 C/SW/LEE WOODAR SWAF

ACCOUNT#: 1121990
 NBHD: 8155 KNOLLWOOD
 Plat Bk/Pg 25 80
 EXCD: 1.00
 APPR: REV APPR DT: 8/06/2015
 NOTICE: 82 3/08/2024

Bldg No. 1
 Imp Desc: R1.0 SFR-1.0 STY
 Grade : C+05 C+05 GRADE
 # of Units 5 Rms 3 Bedrms 2.0 Bathrms HBaths
 EYB: 2007 5337 CASTLEWOOD DR
 AYB: 1997 Finished Area: 1,208.00
 Exempt Code
 LAND VALUE 30,000
 MISC VALUE 3,920
 BLDG VALUE 180,870
 TOTAL VALUE 214,790

TYPE/CODE/DESCRIPTION	PCT	%CMP	UNITS	RATE	STR#	STR%	SIZ%	HGT%	PER%	COST
AC 1021 GARAGE-ATT-FR	100		480	42.55		100.00	90.00			18,381
AC 1052 PORCH-OPEN-MAS	100		20	29.10			120.00			698
AC 1054 PORCH-SCR-MAS	100		144	45.80			102.00			6,727
AC 1071 UTILITY STG-FR	100		40	39.45			110.00			1,735
MA 111 SFR-1.0 STY	100		1208	136.00	1.00		105.12			172,699
- AR 14 GAS PACK	100		1208	.00						0
- EW 02 VINYL SIDING	100		150	.00						0
- FC 20 HARDWOOD/CARPET	100		1208	2.00						2,416
- FN 03 CONT WALL-BRICK	100		150	.00						0
- IF 30 DRYWALL/CUSTOM	100		1208	.00						0
- RC 07 WOOD SHAKES/3D-SHING	100		1208	.00						0
- RT 03 DOUBLE PITCH ROOF	100		1208	.00						0
RCN...					100	x				202,656
QUAL..	C+05				105.00	x				212,788
DEPR..	RC				15.00	-		31,918		31,918 T
--ASV...										180,870

PROPERTY NOTES:	PERMIT NO	TYPE	DATE	BOOK	PAGE	DT	DATE	QS	SALES	PRICE
ADDED FGD AND CHG FOP TO FSP IN BACK OF SFD/JHB	BP01200069A		3/02/2012	2885	745	QD	3/22/2021	C		
LEFT CARD NO ONE HOME AND FENCE/JHB						@	10/25/1999	@		
PERMIT CODE: N MO/YR: 081998 NOTE: 3000				1631	21	WD	6/23/1997			86,000
PERMIT CODE: N MO/YR: 021997 NOTE: 53505				1613	738	WD	1/17/1997	A		50,000

MISC CODE	DESC	UNITS	RATE	AYB	EYB	DT	PCT	%CMP	ADD.DEPR	PCT	VALUE	EXMPT
81 1178	SHOP-RSF 20 X 20	400.00	28.00	1998	1998	MAV	65.00	100			3,920	
							.00					
							.00					
							.00					

#	ZONE	TYPE/CODE	LAND QTY	LAND RATE	DPTH	DPT%	TOP%	LOC%	SIZ%	SHP%	OTH%	ADJ	FMV	EXMPT
1	RA	LT 5010	1.000	30,000.00	146	.00	.00	.00	100.00	.00	.00	.00	30,000	

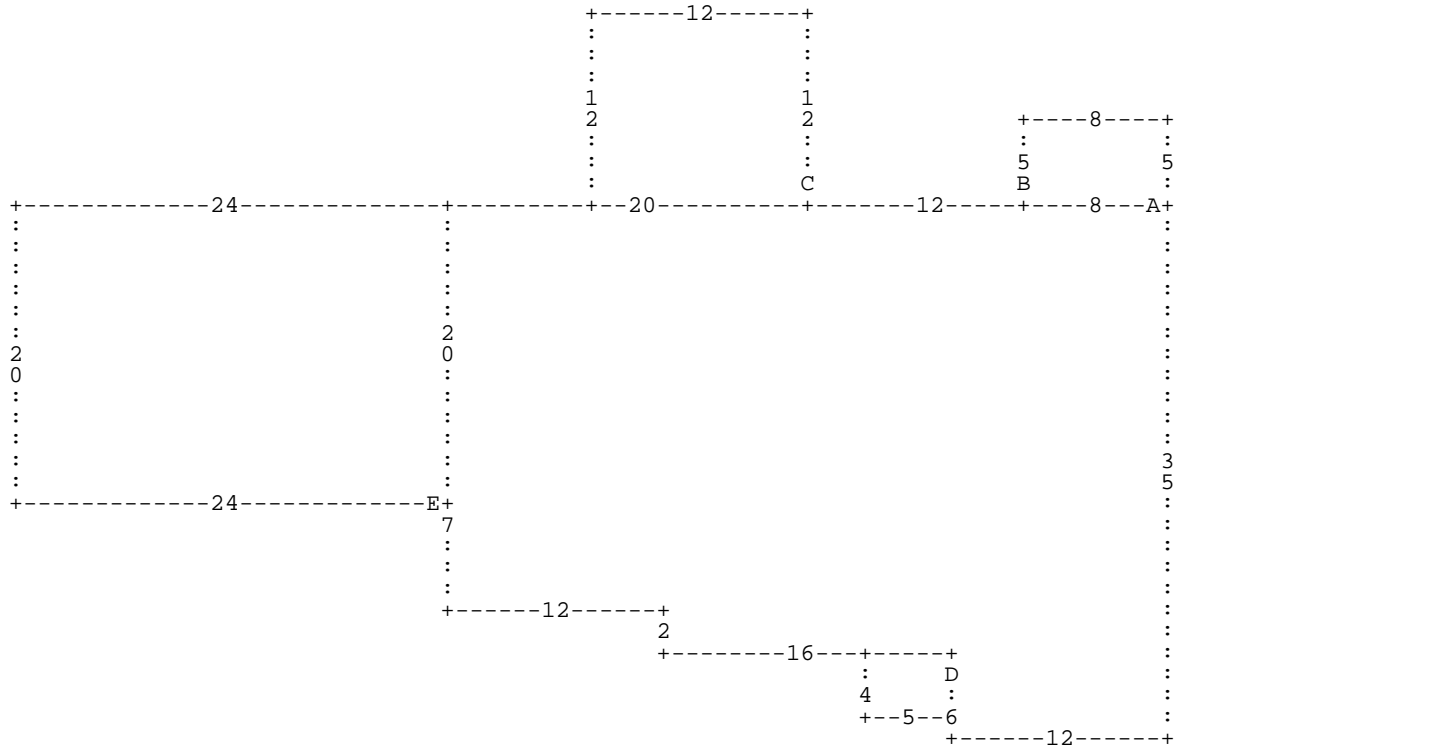

:A DL8 :B DU5 DR8 DD5 DL8 * DL12 :C DU12 DL12 DD12 DR12 * DL20 DD20 :E DL24 DU20
 DR24 DD20 * DD7 DR12 DD2 DR16 :D DD4 DL5 DU4 DR5 * DD6 DR12 DU35 *

A= MA 111
D= AC 1052

1,208.00 SFR-1.0 STY
 20.00 PORCH-OPEN-MA

B= AC 1071
E= AC 1021

40.00 UTILITY STG-F
 480.00 GARAGE-ATT-FR

C= AC 1054

144.00 PORCH-SCR-MAS