

FERRIS DEREK JOHN
 4919 YANK RD
 L2A 2.110 AC 2.11AC

Wilson County
 YR 2024 3619830304.000
 4919 YANK RD
 PIN: 3619 83 0304 000
 DISTRICT: 16 C/SW/LEE WOODAR

ACCOUNT#: 1105952
 NBHD: 8030 BLACK_CREEK_RA
 Plat Bk/Pg 29 152 APPR: JHB APPR DT: 4/23/2021
 EXCD: NOTICE: 82 3/08/2024

Bldg No. 1
 Imp Desc: R1.0 SFR-1.0 STY EYB: 1970 4919 YANK RD Exempt Code
 Grade : C C GRADE AYB: 1949 Finished Area: 1,193.00
 # of Units 4 Rms 3 Bedrms 1.0 Bathrms HBaths

LAND VALUE 27,814
 MISC VALUE 405
 BLDG VALUE 0
 TOTAL VALUE 28,219

TYPE/CODE/DESCRIPTION	PCT	%CMP	UNITS	RATE	STR#	STR%	SIZ%	HGT%	PER%	COST
AC 1052 PORCH-OPEN-MAS	100		40	29.10			110.00			1,280
MA 111 SFR-1.0 STY	100		1193	136.00	1.00		105.50			171,171
- AR 03 NO AC & FURNACE HEAT	100		1193	6.75-						8,052-
- BT BT FULL BATH	100		1-	5500.00						5,500-
- EW 19 CONCRETE BLOCK-12"	100		148	.00						0
- FC 03 HARDWOOD	100		1193	4.35						5,189
- FN 02 CONT WALL-CONC BLOCK	100		148	.00						0
- FP 3 1STY SNGL	100		1	5100.00						5,100
- IF 08 DRYWALL/PLASTER	100		1193	.00						0
- RC 02 COMPOSITION SHINGLE	100		1193	.00						0
- RT 03 DOUBLE PITCH ROOF	100		1193	.00						0
RCN...			PCT COMPLETE		100	x				169,188
QUAL..	C				100.00	x				169,188
DEPR..	RC				64.00	-		108,279		
ADDL..	FD		FIRE DAMAGE		100.00	-		60,909		169,188 T
--ASV...										0

PROPERTY NOTES:	PERMIT NO	TYPE	DATE	BOOK	PAGE	DT	DATE	QS	SALES	PRICE
100% FIRE DAMAGE/STORAGE SILL THERE/04/23/2021/JHB				2652	249	WD	4/15/2016			25,000
				AMOUNT	2556	502	WD	11/19/2013		31,000
						@	9/18/2000	@		
						@	10/25/1999	@		

MISC CODE	DESC	UNITS	RATE	AYB	EYB	DT	PCT	%CMP	ADD.DEPR	PCT	VALUE	EXMPT
81 1174	STG-MAS 8 X 10	80.00	27.50	1950	1950	MFR	75.00	100			405	
							.00					
							.00					
							.00					

#	ZONE	TYPE/CODE	LAND	QTY	LAND RATE	DPTH	DPT%	TOP%	LOC%	SIZ%	SHP%	OTH%	ADJ	FMV	EXMPT
1	RA	AC 5010		1.000	20,000.00		.00	.00	.00	100.00	.00	.00	.00	20,000	
2	RA	AC 0121		1.110	4,000.00		.00	.00	.00	176.00	.00	.00	176.00	7,814	

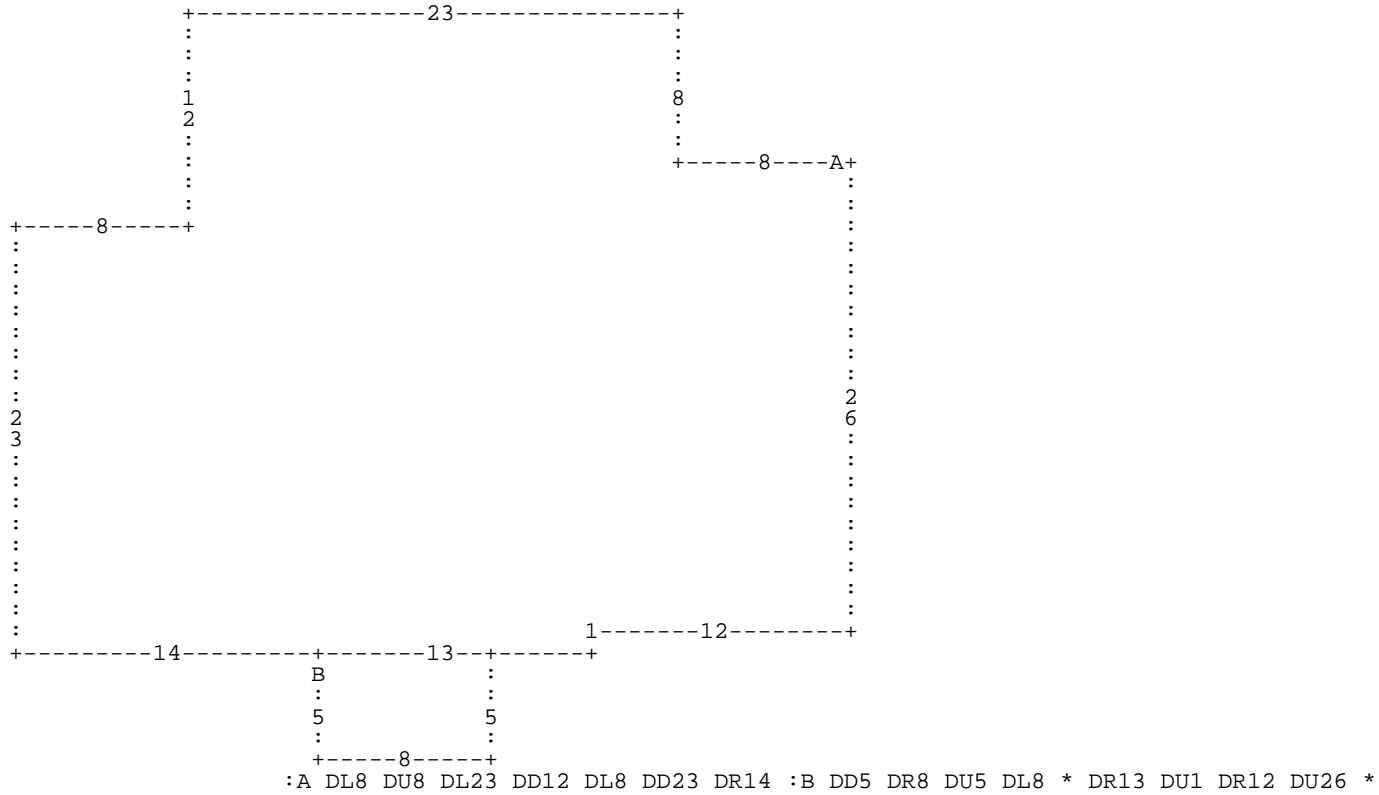

A= MA 111

1,193.00 SFR-1.0 STY

B= AC 1052

40.00 PORCH-OPEN-MA