

A W LETCHWORTH
 4613 YANK RD
 .580 AC .58AC

Wilson County
 YR 2024 3619662485.000
 4613 YANK RD
 PIN: 3619 66 2485 000
 DISTRICT: 16 C/SW/LEE WOODAR SWAF

ACCOUNT#: 1127956
 NBHD: 8031 BLACK_CREEK_TWP
 Plat Bk/Pg 1.00 EXCD:
 APPR: REV APPR DT: 8/27/2015
 NOTICE: 82 3/08/2024

Bldg No. 1
 Imp Desc: R1.0 SFR-1.0 STY EYB: 1981 4613 YANK RD Exempt Code
 Grade : C C GRADE AYB: 1961 Finished Area: 1,464.00
 # of Units 4 Rms 3 Bedrms 1.0 Bathrms HBaths

LAND VALUE 16,240
 MISC VALUE 8,358
 BLDG VALUE 111,935
 TOTAL VALUE 136,533

TYPE/CODE/DESCRIPTION	PCT	%CMP	UNITS	RATE	STR#	STR%	SIZ%	HGT%	PER%	COST
AC 1031 CARPORT	100		420	27.90			94.00			11,014
AC 1051 PORCH-OPEN-FR	100		120	38.80			104.00			4,842
AC 1053 STOOP-MAS	100		24	19.40			120.00			558
AC 1072 UTILITY STG-MAS	100		96	41.40			104.00			4,133
MA 111 SFR-1.0 STY	100		1464	136.00	1.00		101.56			202,209
- AR 10 FORCED AIR HEAT W/ A100	100		1464	.00						0
- BT BT FULL BATH	100		1-	5500.00						5,500-
- EW 18 BRICK VENEER	100		164	35.00						5,740
- FC 48 VINYL/CARPET	100		1464	.00						0
- FN 03 CONT WALL-BRICK	100		164	.00						0
- FP 3 1STY SNGL	100		2	5100.00						10,200
- IF 01 DRYWALL	100		1464	.00						0
- RC 07 WOOD SHAKES/3D-SHING100	100		1464	.00						0
- RT 03 DOUBLE PITCH ROOF	100		1464	.00						0

RCN...			PCT COMPLETE		100	x				233,196
QUAL..	C				100.00	x				233,196
DEPR..	RC				52.00	-		121,261		121,261 T
--ASV...										111,935

PROPERTY NOTES:

PERMIT NO	TYPE	DATE	BOOK	PAGE	DT	DATE	QS	SALES	PRICE
			2976	849	WD	8/05/2022			120,000
AMOUNT			1665	631	WD	10/25/1999	@		
AMOUNT			1216	881	QD	4/09/1998	E		
						2/26/1982	E		

MISC CODE	DESC	UNITS	RATE	AYB	EYB	DT	PCT	%CMP	ADD.DEPR	PCT	VALUE	EXMPT
81 1182	POOL-INGROUND 14 X 28	392.00	55.00	1961	1983	MAV	65.00	100			7,546	
82 1173	STG-FR 12 X 16	192.00	24.00	2005	2005	MFR	75.00	100			812	
							.00					
							.00					

#	ZONE	TYPE/CODE	LAND QTY	LAND RATE	DPTH	DPT%	TOP%	LOC%	SIZ%	SHP%	OTH%	ADJ	FMV	EXMPT
1	AR	AC 5010	.580	20,000.00		.00	.00	.00	140.00	.00	.00	140.00	16,240	

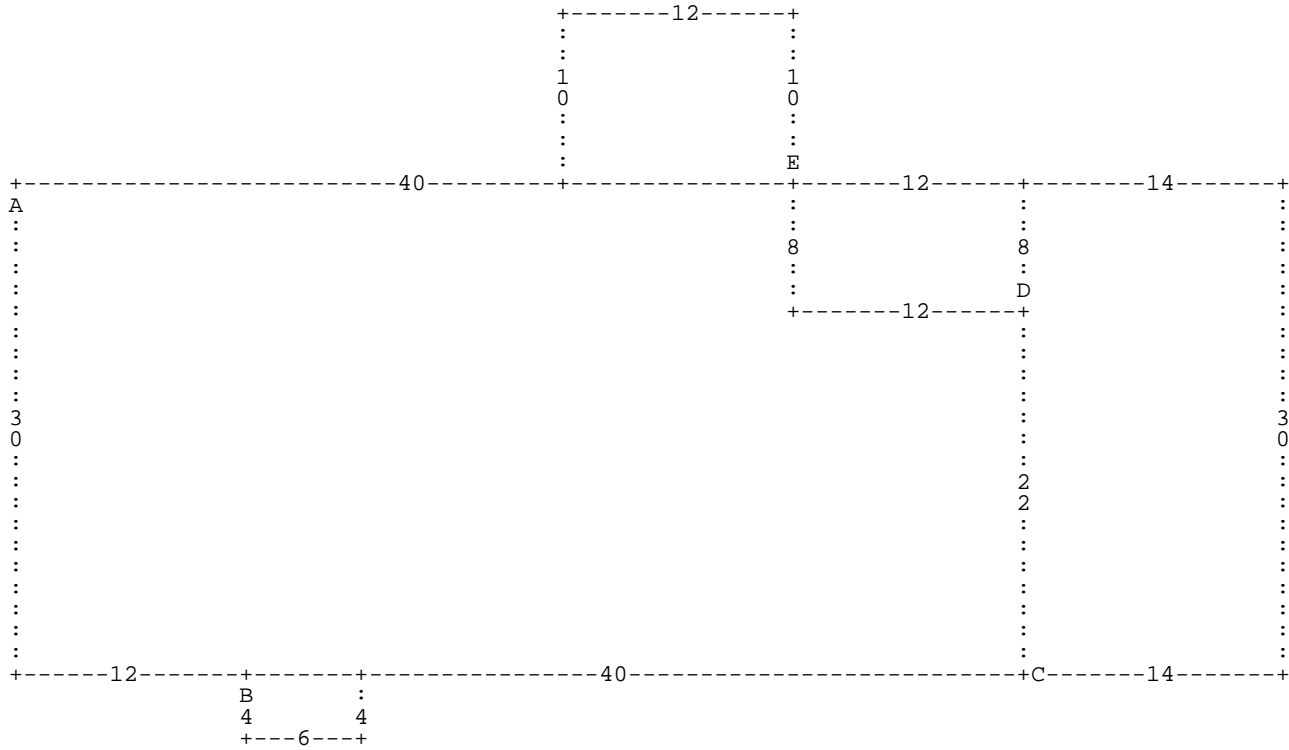

:A DD30 DR12 :B DD4 DR6 DU4 DL6 * DR40 :C DR14 DU30 DL14 DD30 * DU22 :D DU8 DL12
 DD8 DR12 * DL12 DU8 :E DU10 DL12 DD10 DR12 * DL40 *

A= MA 111
D= AC 1072

1,464.00 SFR-1.0 STY
 96.00 UTILITY STG-M

B= AC 1053
E= AC 1051

24.00 STOOP-MAS
 120.00 PORCH-OPEN-FR

C= AC 1031

420.00 CARPORT