

MATTHEWS KENNETH EXUM
 4507 YANK RD
 MERCER LD .53AC
 .530 AC

N2 FOUND YR 2024 **3619460444.000**
 4507 YANK RD
 PIN: 3619 46 0444 000
DISTRICT: 16 C/SW/LEE WOODAR SWAF

Wilson County

ACCOUNT#: 25971120 **PAGE** 1
NBHD: 8031 BLACK_CREEK_TWP
 Plat Bk/Pg APPR: REV APPR DT: 8/27/2015
 1.00 EXCD: NOTICE: 82 3/08/2024

Bldg No. 1
 Imp Desc: R1.0 SFR-1.0 STY EYB: 1989 4507 YANK RD Exempt Code
 Grade : C+05 C+05 GRADE AYB: 1969 Finished Area: 1,463.00
 # of Units 4 Rms 3 Bedrms 1.0 Bathrms 1 HBaths

LAND VALUE 15,370
MISC VALUE 30,645
BLDG VALUE 158,692
TOTAL VALUE 204,707

TYPE/CODE/DESCRIPTION	PCT	%CMP	UNITS	RATE	STR#	STR%	SIZ%	HGT%	PER%	COST
AC 1031 CARPORT	100		299	27.90			97.00			8,091
AC 1052 PORCH-OPEN-MAS	100		135	29.10			102.00			4,007
AC 1056 PORCH-ENCL-FR	100		315	58.20	1.00	100.00	97.00			17,783
AC 1072 UTILITY STG-MAS	100		56	41.40			106.00			2,457
MA 111 SFR-1.0 STY	100		1463	136.00	1.00		101.56			202,071
- AR 10 FORCED AIR HEAT W/ A100	100		1463	.00						0
- BT BT FULL BATH	100		1-	5500.00						5,500-
- BT HBT HALF BATH	100		1	3667.00						3,667
- EW 18 BRICK VENEER	100		174	35.00						6,090
- FC 48 VINYL/CARPET	100		1463	.00						0
- FN 03 CONT WALL-BRICK	100		174	.00						0
- FP 3 1STY SNGL	100		1	5100.00						5,100
- IF 48 CUSTOM INTERIOR	100		1463	.00						0
- RC 02 COMPOSITION SHINGLE	100		1463	.00						0
- RT 03 DOUBLE PITCH ROOF	100		1463	.00						0

RCN...			PCT COMPLETE		100	x				243,766
QUAL..	C+05				105.00	x				255,954
DEPR..	RC				38.00	-		97,262		97,262 T
--ASV...										158,692

PROPERTY NOTES:

PERMIT NO	TYPE	DATE	BOOK	PAGE	DT	DATE	QS	SALES	PRICE
			1057	496	WD	4/06/1971	X		500
			1026	15	WD	1/21/1969	X		1,000

MISC CODE	DESC	UNITS	RATE	AYB	EYB	DT	PCT	%CMP	ADD.DEPR	PCT	VALUE	EXMPT
81 1173	STG-FR 26 X 24	624.00	24.00	1969	1972	MFR	75.00	100			2,527	
82 1121	GAR-DET-FR 28 X 47	1,316.00	51.50	1969	1974	MAV	65.00	100			21,349	
83 1173	STG-FR 12 X 28	336.00	24.00	2005	2005	MAV	40.00	100			4,355	
84 1133	CARPORT-DET-LC 12 X 25	300.00	5.80	2000	2000	MAV	55.00	100			815	

#	ZONE	TYPE/CODE	LAND QTY	LAND RATE	DPTH	DPT%	TOP%	LOC%	SIZ%	SHP%	OTH%	ADJ	FMV	EXMPT
1	AR	AC 5010	.530	20,000.00		.00	.00	.00	145.00	.00	.00	145.00	15,370	

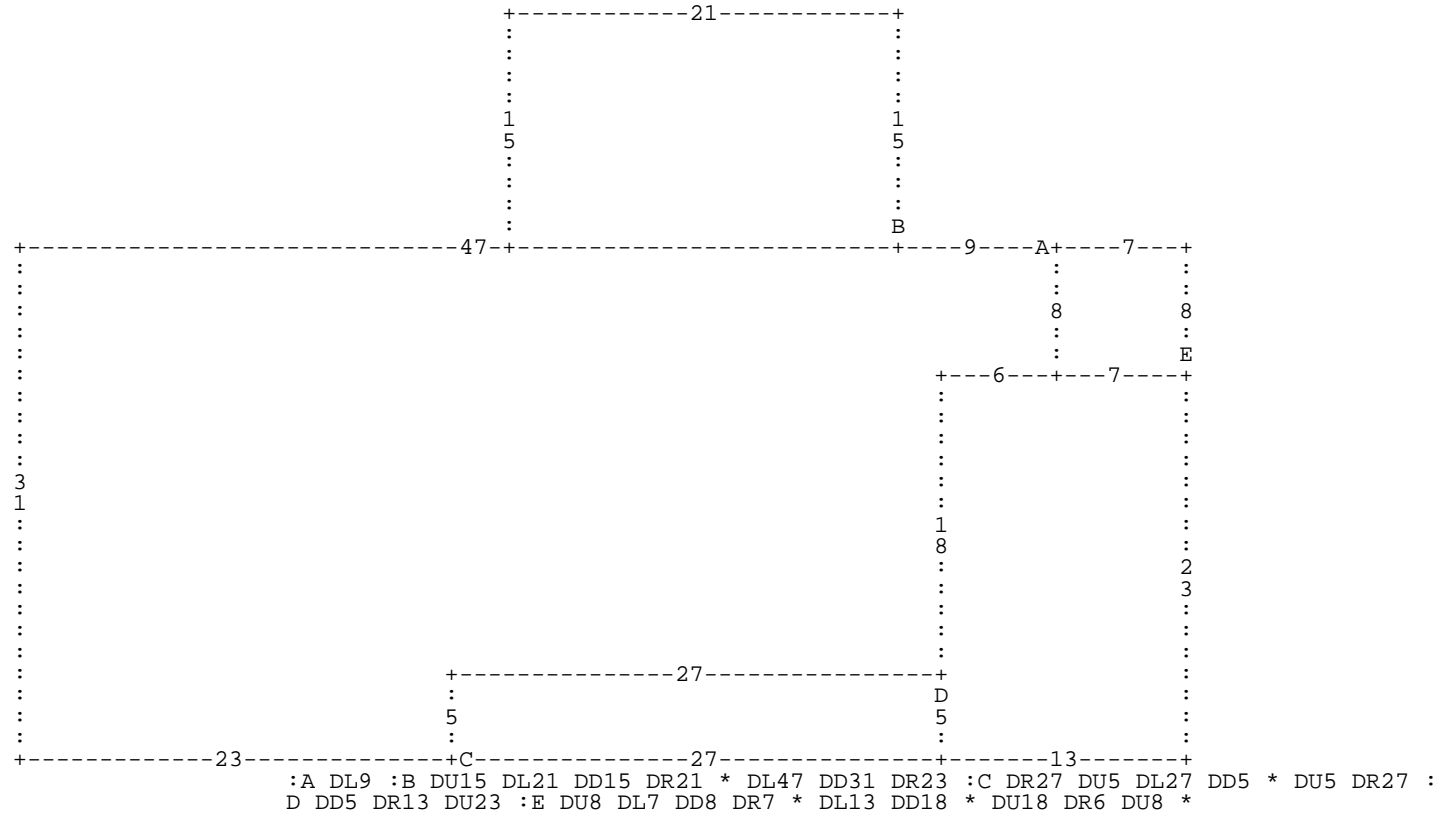

A= MA 111
D= AC 1031

1,463.00 SFR-1.0 STY
299.00 CARPORT

B= AC 1056
E= AC 1072

315.00 PORCH-ENCL-FR
56.00 UTILITY STG-M

C= AC 1052

135.00 PORCH-OPEN-MA

MATTHEWS KENNETH EXUM
 4507 YANK RD
 MERCER LD .53AC
 .530 AC

Wilson County
 N2 FOUND YR 2024 **3619460444.000**
 4507 YANK RD
 PIN: 3619 46 0444 000
DISTRICT: 16 C/SW/LEE WOODAR SWAF

ACCOUNT#: 25971120
 NBHD: 8031 BLACK_CREEK_TWP
 Plat Bk/Pg 1.00 EXCD: APPR: REV APPR DT: 8/27/2015
 NOTICE: 82 3/08/2024

Bldg No. 1 Exempt Code
 Imp Desc: R1.0 SFR-1.0 STY EYB: 1989 4507 YANK RD
 Grade : C+05 C+05 GRADE AYB: 1969 Finished Area: 1,463.00
 # of Units 4 Rms 3 Bedrms 1.0 Bathrms 1 HBaths

 TYPE/CODE/DESCRIPTION PCT %CMP UNITS RATE STR# STR% SIZ% HGT% PER% COST

PROPERTY NOTES:

PERMIT NO	TYPE	DATE	BOOK	PAGE	DT	DATE	QS	SALES	PRICE
AMOUNT									
AMOUNT									

MISC CODE	DESC	UNITS	RATE	AYB	EYB	DT	PCT	%CMP	ADD.DEPR	PCT	VALUE	EXMPT
85 1173	STG-FR 8 X 10	80.00	24.00	1980	1980	MAV	65.00	100			659	
86 1133	CARPORT-DET-LC 18 X 20	360.00	5.80	2000	2000	MAV	55.00	100			940	
							.00					
							.00					

#	ZONE	TYPE/CODE	LAND QTY	LAND RATE	DPTH	DPT%	TOP%	LOC%	SIZ%	SHP%	OTH%	ADJ	FMV	EXMPT
---	------	-----------	----------	-----------	------	------	------	------	------	------	------	-----	-----	-------

