

GUERRA JUANITA
 4551 HUTCHENS RD
 L21 KENROY EST 1.00LT
 .574 AC

Wilson County
 N2 FOUND YR 2024 3609791153.000
 4551 HUTCHENS RD
 PIN: 3609 79 1153 000
 DISTRICT: 15 C/SW/CROSSROADS SWAF

ACCOUNT#: 1011224
 NBHD: 8153 KENROY_ESTATES
 Plat Bk/Pg 17 126 APPR: REV APPR DT: 8/17/2015
 EXCD: 1.00 NOTICE: 82 3/08/2024

Bldg No. 1
 Imp Desc: R1.0 SFR-1.0 STY EYB: 1998 4551 HUTCHENS RD Exempt Code
 Grade : C C GRADE AYB: 1985 Finished Area: 1,297.00
 # of Units 5 Rms 3 Bedrms 2.0 Bathrms HBaths

LAND VALUE 33,000
 MISC VALUE 12,200
 BLDG VALUE 153,765
 TOTAL VALUE 198,965

TYPE/CODE/DESCRIPTION	PCT	%CMP	UNITS	RATE	STR#	STR%	SIZ%	HGT%	PER%	COST
AC 1031 CARPORT	100		266	27.90			97.00			7,198
AC 1052 PORCH-OPEN-MAS	100		105	29.10			104.00			3,177
AC 1064 DECK-WOOD	100		168	24.95			102.00			4,275
AC 1071 UTILITY STG-FR	100		42	39.45			110.00			1,822
MA 111 SFR-1.0 STY	100		1297	136.00	1.00		104.00			183,447
- AR 27 ELECTRIC HEAT PUMP	100		1297	.00						0
- EW 02 VINYL SIDING	100		172	.00						0
- FC 48 VINYL/CARPET	100		1297	.00						0
- FN 03 CONT WALL-BRICK	100		172	.00						0
- FP 3 1STY SNGL	100		1	5100.00						5,100
- IF 01 DRYWALL	100		1297	.00						0
- RC 07 WOOD SHAKES/3D-SHING	100		1297	.00						0
- RT 03 DOUBLE PITCH ROOF	100		1297	.00						0
RCN...			PCT COMPLETE		100	x				205,019
QUAL..	C				100.00	x				205,019
DEPR.. RC					25.00	-		51,254		51,254 T
--ASV...										153,765

PROPERTY NOTES:

PERMIT NO	TYPE	DATE	BOOK	PAGE	DT	DATE	QS	SALES	PRICE
			2251	131	WD	5/24/2007			112,000
AMOUNT			2030	925	WD	4/28/2004			103,000
AMOUNT			1797	801	DRMR	2/12/2001	E		
					@	10/25/1999	@		

MISC CODE	DESC	UNITS	RATE	AYB	EYB	DT	PCT	%CMP	ADD.DEPR	PCT	VALUE	EXMPT
81 1121	GARAGE 024 X 030	720.00	51.50	1987	1990	MAV	65.00	100			12,200	
							.00					
							.00					
							.00					

#	ZONE	TYPE/CODE	LAND QTY	LAND RATE	DPTH	DPT%	TOP%	LOC%	SIZ%	SHP%	OTH%	ADJ	FMV	EXMPT
1	R20	LT 0100	1.100	30,000.00		.00	.00	.00	100.00	.00	.00	.00	33,000	

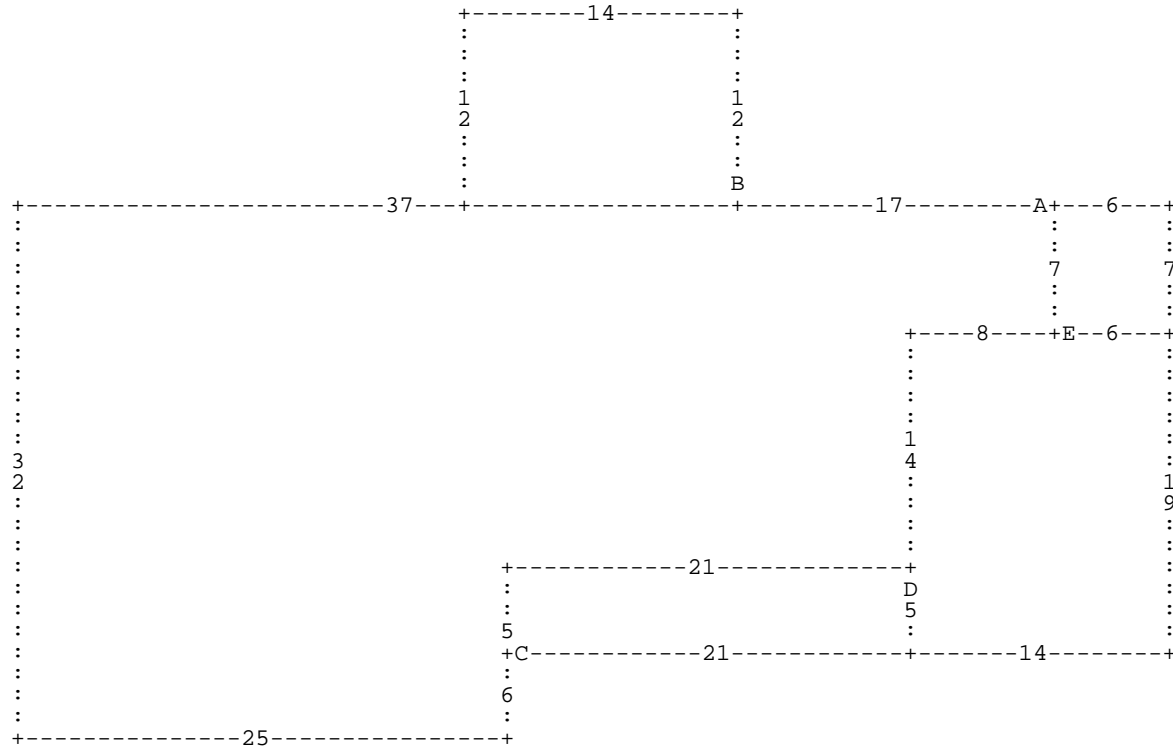

:A DL17 :B DU12 DL14 DD12 DR14 * DL37 DD32 DR25 DU6 :C DR21 DU5 DL21 DD5 * DU5 D
R21 :D DD5 DR14 DU19 DL14 DD14 * DU14 DR8 :E DR6 DU7 DL6 DD7 * DU7 *

A= MA 111
D= AC 1031

1,297.00 SFR-1.0 STY
266.00 CARPORT

B= AC 1064
E= AC 1071

168.00 DECK-WOOD
42.00 UTILITY STG-F

C= AC 1052

105.00 PORCH-OPEN-MA