

ELMORE DWAIN FELTON
 5505 CREECH RD
 L1 2.800 AC 2.80AC

Wilson County
 YR 2024 3609216593.000
 5505 CREECH RD
 PIN: 3609 21 6593 000
 DISTRICT: 15 C/SW/CROSSROADS SWAF

ACCOUNT#: 1090999
 NBHD: 8181 LUCAMA_R-15
 Plat Bk/Pg 42 240
 EXCD: 1.00
 APPR: GRW APPR DT: 7/09/2021
 NOTICE: 82 3/08/2024

Bldg No. 1
 Imp Desc: R1.0 SFR-1.0 STY EYB: 2002 5505 CREECH RD Exempt Code
 Grade : B+05 B+05 GRADE AYB: 2002 Finished Area: 1,944.00
 # of Units 6 Rms 3 Bedrms 3.0 Bathrms HBaths

LAND VALUE 37,712
 MISC VALUE 58,124
 BLDG VALUE 333,832
 TOTAL VALUE 429,668

TYPE/CODE/DESCRIPTION	PCT	%CMP	UNITS	RATE	STR#	STR%	SIZ%	HGT%	PER%	COST
AC 1022 GARAGE-ATT-MAS	100		528	44.65			90.00			21,217
AC 1052 PORCH-OPEN-MAS	100		28	29.10			120.00			977
AC 1052 PORCH-OPEN-MAS	100		366	29.10			94.00			10,011
AC 1071 UTILITY STG-FR	100		20	39.45			120.00			946
MA 111 SFR-1.0 STY	100		1944	136.00	1.00		96.38			254,811
- AR 14 GAS PACK	100		1944	.00						0
- BT BT FULL BATH	100		1	5500.00						5,500
- EW 18 BRICK VENEER	100		244	35.00						8,540
- FC 20 HARDWOOD/CARPET	100		1944	2.00						3,888
- FN 03 CONT WALL-BRICK	100		244	.00						0
- FP 2 PREFAB	100		1	3500.00						3,500
- IF 48 CUSTOM INTERIOR	100		1944	.00						0
- RC 07 WOOD SHAKES/3D-SHING	100		1944	.00						0
- RT 04 HIP ROOF	100		1944	.00						0

RCN...			PCT COMPLETE		100	x				309,390
QUAL..	B+05				130.00	x				402,207
DEPR.. RB					17.00	-		68,375		68,375 T
--ASV...										333,832

PROPERTY NOTES:	PERMIT NO	TYPE	DATE	BOOK	PAGE	DT	DATE	QS	SALES	PRICE
PERMIT CODE: A MO/YR: 052003 NOTE: 20000				2012	CDTH	CMB	7/06/2021	Y		
PERMIT CODE: N MO/YR: 112002 NOTE: 97598				AMOUNT	CDTH	CDTH	3/07/2012	E		
				1908	834	WD	10/11/2002			19,000
				AMOUNT		@	9/18/2002	@		

MISC CODE	DESC	UNITS	RATE	AYB	EYB	DT	PCT	%CMP	ADD.DEPR	PCT	VALUE	EXMPT
81 108	GAR-DET W/APT-U 28 X 36	1,008.00	65.50	2003	2010	MAV	28.00	100			42,784	
82 1151	PORCH-DET-FR 12 X 36	432.00	41.55	2003	2003	MAV	46.00	100			9,111	
83 1173	STG-FR 10 X 12	120.00	24.00	2005	2005	MAV	40.00	100			1,659	
84 020	BARN (GEN PURP) 24 X 14	336.00	13.50	1960	1960	MFR	75.00	100			765	

#	ZONE	TYPE/CODE	LAND QTY	LAND RATE	DPTH	DPT%	TOP%	LOC%	SIZ%	SHP%	OTH%	ADJ	FMV	EXMPT
1	R15	AC 5010	1.000	20,000.00		.00	.00	.00	100.00	.00	.00	.00	20,000	
2	R15	AC 0121	1.800	6,000.00		.00	.00	.00	164.00	.00	.00	164.00	17,712	

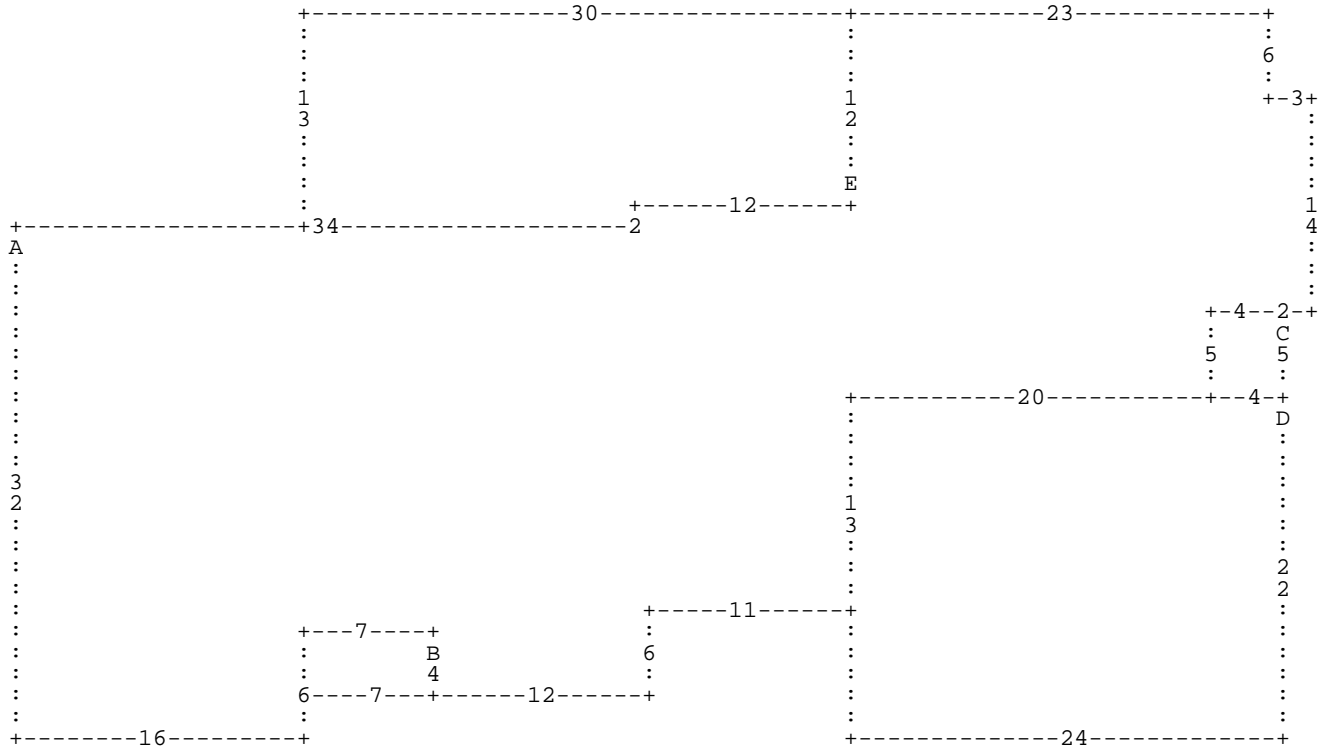

:A DD32 DR16 DU6 DR7 :B DD4 DL7 DU4 DR7 * DD4 DR12 DU6 DR11 DU13 DR20 DU5 DR4 :C
 DD5 :D DD22 DL24 DU22 DR24 * DL4 DU5 DR4 * DR2 DU14 DL3 DU6 DL23 DD12 :E DU11 D
 L30 DD13 DR18 DU2 DR12 * DL12 DD2 DL34 *

A= MA 111
 D= AC 1022

1,944.00 SFR-1.0 STY
 528.00 GARAGE-ATT-MA

B= AC 1052
 E= AC 1052

28.00 PORCH-OPEN-MA
 366.00 PORCH-OPEN-MA

C= AC 1071

20.00 UTILITY STG-F

ELMORE DWAIN FELTON
 5505 CREECH RD
 L1 2.800 AC 2.80AC

Wilson County
 YR 2024 3609216593.000
 5505 CREECH RD
 PIN: 3609 21 6593 000
DISTRICT: 15 C/SW/CROSSROADS SWAF

ACCOUNT#: 1090999
 NBHD: 8181 LUCAMA_R-15
 Plat Bk/Pg 42 240 APPR: GRW APPR DT: 7/09/2021
 EXCD: NOTICE: 82 3/08/2024

Bldg No. 1 Exempt Code
 Imp Desc: R1.0 SFR-1.0 STY EYB: 2002 5505 CREECH RD
 Grade : B+05 B+05 GRADE AYB: 2002 Finished Area: 1,944.00
 # of Units 6 Rms 3 Bedrms 3.0 Bathrms HBaths

TYPE/CODE/DESCRIPTION PCT %CMP UNITS RATE STR# STR% SIZ% HGT% PER% COST

PROPERTY NOTES:

PERMIT NO	TYPE	DATE	BOOK	PAGE	DT	DATE	QS	SALES	PRICE
			1404	172	WD	9/06/1990	X		
AMOUNT									
AMOUNT									

MISC CODE	DESC	UNITS	RATE	AYB	EYB	DT	PCT	%CMP	ADD.DEPR	PCT	VALUE	EXMPT
85 020	BARN (GEN PURP) 25 X 16	400.00	13.50	1960	1960	MFR	75.00	100			912	
86 1143	SHELTER-OPEN 25 X 15	375.00	10.50	1960	1960	MFR	75.00	100			665	
87 023	BARN-BANK W/LOFT 18 X 14	252.00	21.55	1960	1960	MFR	75.00	100			957	
88 1143	SHELTER-OPEN 18 X 19	342.00	10.50	1960	1960	MFR	75.00	100			606	

#	ZONE	TYPE/CODE	LAND QTY	LAND RATE	DPTH	DPT%	TOP%	LOC%	SIZ%	SHP%	OTH%	ADJ	FMV	EXMPT
---	------	-----------	----------	-----------	------	------	------	------	------	------	------	-----	-----	-------

ELMORE DWAIN FELTON
 5505 CREECH RD
 L1 2.800 AC 2.80AC

Wilson County
 YR 2024 3609216593.000
 5505 CREECH RD
 PIN: 3609 21 6593 000
DISTRICT: 15 C/SW/CROSSROADS SWAF

ACCOUNT#: 1090999
 NBHD: 8181 LUCAMA_R-15
 Plat Bk/Pg 42 240 APPR: GRW APPR DT: 7/09/2021
 EXCD: NOTICE: 82 3/08/2024

Bldg No. Exempt Code
 Imp Desc: SHELTER-OPEN 18 X 19 EYB: 1960
 Grade : D AYB: 1960 Finished Area:
 # of Units Rms Bedrms Bathrms HBaths

 TYPE/CODE/DESCRIPTION PCT %CMP UNITS RATE STR# STR% SIZ% HGT% PER% COST

PROPERTY NOTES:

PERMIT NO	TYPE	DATE	BOOK	PAGE	DT	DATE	QS	SALES	PRICE

MISC CODE	DESC	UNITS	RATE	AYB	EYB	DT	PCT	%CMP	ADD.DEPR	PCT	VALUE	EXMPT
89 1143	SHELTER-OPEN 25 X 15	375.00	10.50	1960	1960	MFR	75.00	100			665	
							.00					
							.00					
							.00					

#	ZONE	TYPE/CODE	LAND QTY	LAND RATE	DPTH	DPT%	TOP%	LOC%	SIZ%	SHP%	OTH%	ADJ	FMV	EXMPT
---	------	-----------	----------	-----------	------	------	------	------	------	------	------	-----	-----	-------

