

WHITLEY JAMES E (LER)
 5157 BLOOMERY RD
 O'NEAL LD 54.09AC
 54.090 AC

Wilson County
 YR 2024 2794713046.000
 5157 BLOOMERY RD
 PIN: 2794 71 3046 000
 DISTRICT: 14 C/SW/SILVER LAK SWAF

ACCOUNT#: 69954306
 NBHD: 8381 WILSON_NORTHWEST_A-1
 Plat Bk/Pg 2.00 EXCD:
 APPR: GRW APPR DT: 1/23/2024
 NOTICE: 82 3/08/2024

Bldg No. 2
 Imp Desc: R1.0 SFR-1.0 STY EYB: 1970 5157 BLOOMERY RD Exempt Code
 Grade : D+10 D+10 GRADE AYB: 1935 Finished Area: 1,461.00
 # of Units 5 Rms 2 Bedrms 2.0 Bathrms HBaths

LAND VALUE 84,136
 MISC VALUE 11,583
 BLDG VALUE 82,321
 TOTAL VALUE 178,040

TYPE/CODE/DESCRIPTION	PCT	%CMP	UNITS	RATE	STR#	STR%	SIZ%	HGT%	PER%	COST
AC 1021 GARAGE-ATT-FR	100		154	42.55			120.00			7,863
AC 1052 PORCH-OPEN-MAS	100		128	29.10			102.00			3,799
MA 111 SFR-1.0 STY	100		1461	136.00	1.00		101.56			201,794
- AR 03G NO AC & FURNACE HEAT	100		1461	6.25-						9,131-
- BT BT FULL BATH	100		1-	5500.00						5,500-
- EW 02 VINYL SIDING	100		192	.00						0
- FC 05 VINYL	100		1461	.00						0
- FN 02 CONT WALL-CONC BLOCK	100		192	.00						0
- IF 39 PLASTER/FIBERBOARD	100		1461	.00						0
- RC 07 WOOD SHAKES/3D-SHING	100		1461	.00						0
- RT 03 DOUBLE PITCH ROOF	100		1461	.00						0

RCN...			PCT COMPLETE		100	x				198,825
QUAL..	D+10				85.00	x				169,001
DEPR.. RD					69.00	-		116,610		116,610 T
--ASV...										52,391

PROPERTY NOTES:
 50% COMPLETE ON ADDITION/ADDED BATH SECIND HOUSE/01/11/2023
 100% COMPLETE ON ADDITION/06/12/2023/JHB

PERMIT NO	TYPE	DATE	BOOK	PAGE	DT	DATE	QS	SALES	PRICE
			2119	942	SPL	10/03/2023	#		
AMOUNT			2119	942	SPL	9/24/2015	#		
			2119	942	SPL	6/06/2012	#		
AMOUNT			2119	942	DG	7/28/2005	E		

MISC CODE	DESC	UNITS	RATE	AYB	EYB	DT	PCT	%CMP	ADD.DEPR	PCT	VALUE	EXMPT
91 020	BARN (GEN PURP) 30 X 28	840.00	13.50	1960	1960	MAV	65.00	100			3,573	
92 038	SHED-IMPLEMENT 30 X 18	540.00	9.75	1960	1960	MAV	65.00	100			1,659	
93 1143	SHELTER-OPEN 30 X 40	1,200.00	10.50	1960	1960	MAV	65.00	100			3,969	
94 1143	SHELTER-OPEN 16 X 45	720.00	10.50	1960	1960	MAV	65.00	100			2,382	

#	ZONE	TYPE/CODE	LAND QTY	LAND RATE	DPTH	DPT%	TOP%	LOC%	SIZ%	SHP%	OTH%	ADJ	FMV	EXMPT
1	RA	AC 5010	1.200	30,000.00		.00	.00	.00	100.00	.00	.00	.00	36,000	
2	AR	AC 5111	33.870	3,000.00		.00	.00	.00	94.00	.00	.00	94.00	95,513	
		LU 5110	33.870	1,200.00									40,644	
3	AR	AC 6111	10.020	1,500.00		.00	.00	.00	94.00	.00	.00	94.00	14,128	
		LU 6110	10.020	375.00									3,757	
4	AR	AC 6111	9.000	1,500.00		.00	.00	.00	94.00	.00	.00	94.00	12,690	
		LU 6120	9.000	415.00									3,735	

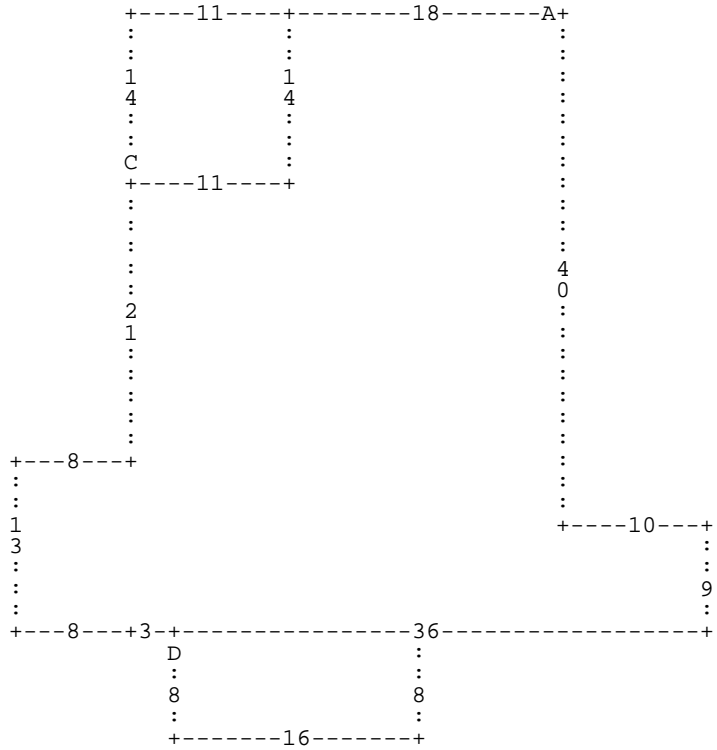

:A DL18 DD14 DL11 :C DU14 DR11 DD14 DL11 * DD21 DL8 DD13 DR8 DD1 DR3 :D DD8 DR16
 DU8 DL16 * DR36 DU9 DL10 DU40 *

A= MA 111 1,461.00 SFR-1.0 STY C= AC 1021 154.00 GARAGE-ATT-FR D= AC 1052 128.00 PORCH-OPEN-MA

WHITLEY JAMES E (LER)
 5157 BLOOMERY RD
 O'NEAL LD 54.09AC
 54.090 AC

Wilson County
 YR 2024 2794713046.000
 5157 BLOOMERY RD
 PIN: 2794 71 3046 000
 DISTRICT: 14 C/SW/SILVER LAK SWAF

ACCOUNT#: 69954306
 NBHD: 8381 WILSON_NORTHWEST_A-1
 Plat Bk/Pg 2.00 EXCD:
 PAGE 3
 APPR: GRW APPR DT: 1/23/2024
 NOTICE: 82 3/08/2024

Bldg No. 3 Exempt Code
 Imp Desc: R1.0 SFR-1.0 STY EYB: 1950 5158 BLOOMERY RD
 Grade : D+05 D+05 GRADE AYB: 1950 Finished Area: 864.00
 # of Units 2 Rms 1 Bedrms 1.0 Bathrms HBaths

TYPE/CODE/DESCRIPTION	PCT	%CMP	UNITS	RATE	STR#	STR%	SIZ%	HGT%	PER%	COST
AC 1052 PORCH-OPEN-MAS	100		15	29.10			120.00			523
MA 111 SFR-1.0 STY	100		864	136.00	1.00		112.13			131,756
- AR 03 NO AC & FURNACE HEAT	100		864	6.75-						5,832-
- BT BT FULL BATH	100		1-	5500.00						5,500-
- EW 02 VINYL SIDING	100		128	.00						0
- FC 10 SOFTWOOD	100		864	4.35						3,758
- FN 02 CONT WALL-CONC BLOCK	100		128	.00						0
- IF 08 DRYWALL/PLASTER	100		864	.00						0
- RC 02 COMPOSITION SHINGLE	100		864	.00						0
- RT 03 DOUBLE PITCH ROOF	100		864	.00						0
RCN...		PCT COMPLETE			100	x				124,705
QUAL..	D+05				80.00	x				99,764
DEPR.. RD					70.00	-		69,834		69,834 T
--ASV...										29,930

PROPERTY NOTES:

PERMIT NO	TYPE	DATE	BOOK	PAGE	DT	DATE	QS	SALES	PRICE
AMOUNT			92E	361	WD	10/25/1999 @ 7/01/1992 U			
AMOUNT									

MISC CODE	DESC	UNITS	RATE	AYB	EYB	DT	PCT	%CMP	ADD.DEPR	PCT	VALUE	EXMPT
							.00					
							.00					
							.00					
							.00					

#	ZONE	TYPE/CODE	LAND QTY	LAND RATE	DPTH	DPT%	TOP%	LOC%	SIZ%	SHP%	OTH%	ADJ	FMV	EXMPT
---	------	-----------	----------	-----------	------	------	------	------	------	------	------	-----	-----	-------

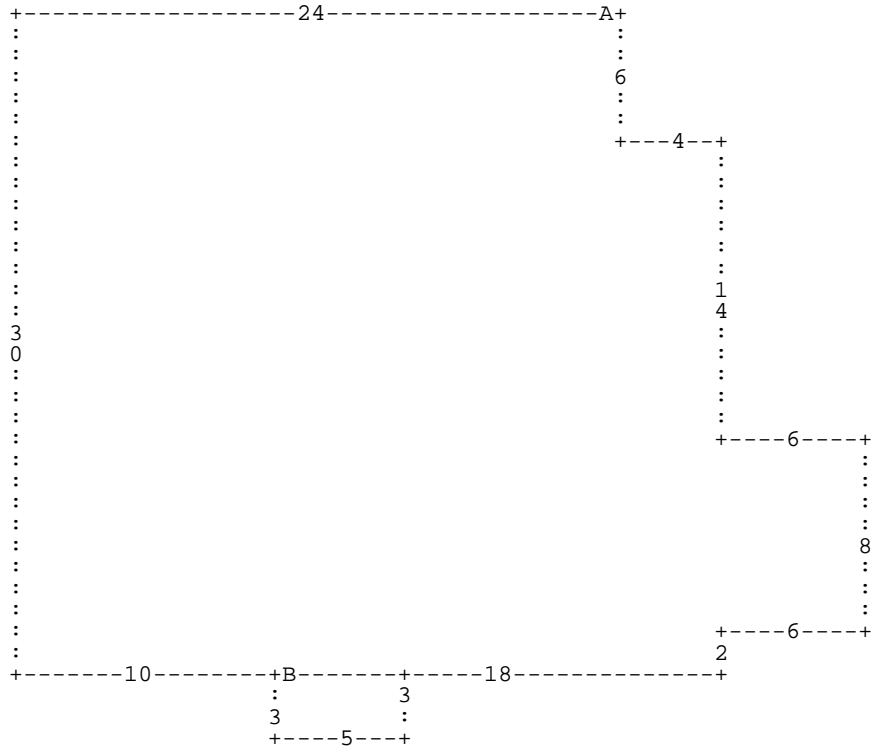

:A DL24 DD30 DR10 :B DR5 DD3 DL5 DU3 * DR18 DU2 DR6 DU8 DL6 DU14 DL4 DU6 *

A= MA 111

864.00 SFR-1.0 STY

B= AC 1052

15.00 PORCH-OPEN-MA