

BOYKIN ICIE CAROL(LER)  
 4759 LAMM RD  
 L2 LAMM HEIRS .74AC  
 .740 AC

Wilson County  
 YR 2024 2792711853.000  
 4759 LAMM RD  
 PIN: 2792 71 1853 000  
 DISTRICT: 13 C/SW/CONTENTNEA SWAF

ACCOUNT#: 51835800  
 NBHD: 8219 OLD\_FIELDS  
 Plat Bk/Pg 17 2  
 EXCD: 1.00  
 APPR: REV APPR DT: 5/28/2015  
 NOTICE: 82 3/08/2024  
 PAGE 1

Bldg No. 1  
 Imp Desc: R1.0 SFR-1.0 STY  
 Grade : C-10 C-10 GRADE  
 # of Units 5 Rms 3 Bedrms 2.0 Bathrms HBaths  
 EYB: 1995 4759 LAMM RD  
 AYB: 1978 Finished Area: 1,700.00  
 Exempt Code  
 LAND VALUE 37,000  
 MISC VALUE 4,506  
 BLDG VALUE 169,065  
 TOTAL VALUE 210,571

TYPE/CODE/DESCRIPTION	PCT	%CMP	UNITS	RATE	STR#	STR%	SIZ%	HGT%	PER%	COST
AC 1031 CARPORT	100		495	27.90			90.00			12,429
AC 1052 PORCH-OPEN-MAS	100		120	29.10			104.00			3,631
AC 1064 DECK-WOOD	100		112	24.95		100.00	104.00			2,906
AC 1071 UTILITY STG-FR	100		133	39.45			102.00			5,351
MA 111 SFR-1.0 STY	100		1700	136.00	1.00		98.75			228,310
- AR 27 ELECTRIC HEAT PUMP	100		1700	.00						0
- EW 31 BRICK/VINYL COMBO	100		184	18.75						3,450
- FC 20 HARDWOOD/CARPET	100		1700	2.00						3,400
- FN 03 CONT WALL-BRICK	100		184	.00						0
- FP 3 1STY SNGL	100		1	5100.00						5,100
- IF 01 DRYWALL	100		1700	.00						0
- RC 02 COMPOSITION SHINGLE	100		1700	.00						0
- RT 03 DOUBLE PITCH ROOF	100		1700	.00						0
RCN...			PCT COMPLETE		100	x				264,577
QUAL..	C-10				90.00	x				238,119
DEPR.. RC					29.00	-		69,054		69,054 T
--ASV...										169,065

PROPERTY NOTES:	PERMIT NO	TYPE	DATE	BOOK	PAGE	DT	DATE	QS	SALES	PRICE
UDU WILL BE FUT WHEN COMP		LETE		1224	410	WD	10/25/1999	@		
	AMOUNT						5/01/1982	X		
	AMOUNT									

MISC CODE	DESC	UNITS	RATE	AYB	EYB	DT	PCT	%CMP	ADD.DEPR	PCT	VALUE	EXMPT
81 1142	LEAN-TO 16 X 43	688.00	4.80	1978	1978	MFR	75.00	100			594	
82 1173	STG-FR 21 X 46	966.00	24.00	1978	1978	MFR	75.00	100			3,912	
							.00					
							.00					

#	ZONE	TYPE/CODE	LAND QTY	LAND RATE	DPTH	DPT%	TOP%	LOC%	SIZ%	SHP%	OTH%	ADJ	FMV	EXMPT
1	AR	AC 5010	.740	40,000.00		.00	.00	.00	125.00	.00	.00	125.00	37,000	

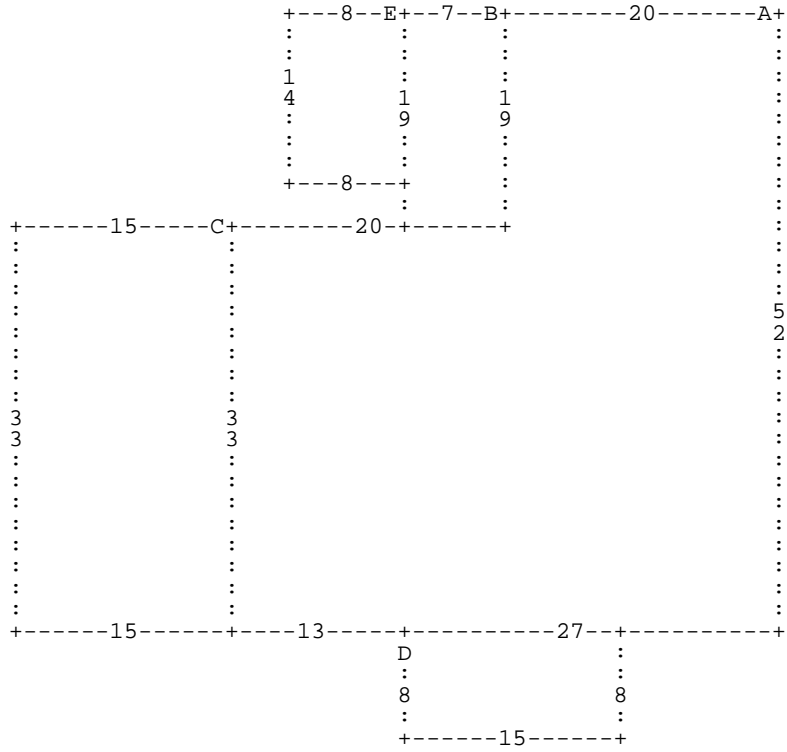

:A DL20 :B DL7 :E DL8 DD14 DR8 DU14 \* DD19 DR7 DU19 \* DD19 DL20 :C DL15 DD33 DR1  
5 DU33 \* DD33 DR13 :D DD8 DR15 DU8 DL15 \* DR27 DU52 \*

A= MA 111  
D= AC 1052

1,700.00 SFR-1.0 STY  
120.00 PORCH-OPEN-MA

B= AC 1071  
E= AC 1064

133.00 UTILITY STG-F  
112.00 DECK-WOOD

C= AC 1031

495.00 CARPORT