

PAGE ROY CORNELIUS
 4669 WIGGINS MILL RD
 1.57AC
 1.57AC

Wilson County
 N2 FOUND YR 2024 2790859468.000
 4669 WIGGINS MILL RD
 PIN: 2790 85 9468 000
 DISTRICT: 15 C/SW/CROSSROADS SWAF

ACCOUNT#: 36741161
 NBHD: 8081 CROSSROADS_TWP
 Plat Bk/Pg 1.00 EXCD:
 APPR: REV APPR DT: 10/16/2015
 NOTICE: 82 3/08/2024

Bldg No. 1
 Imp Desc: R1.0 SFR-1.0 STY EYB: 1985 4669 WIGGINS MILL RD Exempt Code
 Grade : C+05 C+05 GRADE AYB: 1950 Finished Area: 1,268.00
 # of Units 4 Rms 3 Bedrms 1.0 Bathrms HBaths

LAND VALUE 24,446
 MISC VALUE 5,525
 BLDG VALUE 127,380
 TOTAL VALUE 157,351

TYPE/CODE/DESCRIPTION	PCT	%CMP	UNITS	RATE	STR#	STR%	SIZ%	HGT%	PER%	COST
AC 1031 CARPORT	100		240	27.90			100.00			6,696
AC 1051 PORCH-OPEN-FR	100		320	38.80			97.00			12,043
AC 1064 DECK-WOOD	100		320	24.95			97.00			7,744
AC 1071 UTILITY STG-FR	100		84	39.45			106.00			3,512
MA 111 SFR-1.0 STY	100		1268	136.00	1.00		104.38			180,000
- AR 10 FORCED AIR HEAT W/ A100	100		1268	.00						0
- BT BT FULL BATH	100		1-	5500.00						5,500-
- EW 18 BRICK VENEER	100		156	35.00						5,460
- FC 10 SOFTWOOD	100		1268	4.35						5,515
- FN 03 CONT WALL-BRICK	100		156	.00						0
- FP 3 1STY SNGL	100		1	5100.00						5,100
- IF 48 CUSTOM INTERIOR	100		1268	.00						0
- RC 02 COMPOSITION SHINGLE	100		1268	.00						0
- RT 03 DOUBLE PITCH ROOF	100		1268	.00						0

RCN...			PCT COMPLETE		100	x				220,570
QUAL..	C+05				105.00	x				231,599
DEPR.. RC					45.00	-		104,219		104,219 T
--ASV...										127,380

PROPERTY NOTES:
 FROM JAMES T LAMM

PERMIT NO	TYPE	DATE	BOOK	PAGE	DT	DATE	QS	SALES	PRICE
AMOUNT			1373	935	WD	10/25/1999 @	@		45,500
AMOUNT						6/01/1989			

MISC CODE	DESC	UNITS	RATE	AYB	EYB	DT	PCT	%CMP	ADD.DEPR	PCT	VALUE	EXMPT
81 020	BARN (GEN PURP) 16 X 16	256.00	13.50	1975	1975	MAV	65.00	100			1,137	
82 1143	SHELTER-OPEN 12 X 16	192.00	10.50	1975	1975	MAV	65.00	100			706	
83 1173	STG-FR 12 X 16	192.00	24.00	1975	1975	MAV	65.00	100			1,516	
84 1173	STG-FR 10 X 16	160.00	24.00	2005	2005	MAV	40.00	100			2,166	

#	ZONE	TYPE/CODE	LAND QTY	LAND RATE	DPTH	DPT%	TOP%	LOC%	SIZ%	SHR%	OTH%	ADJ	FMV	EXMPT
1	AR	AC 5010	1.000	20,000.00		.00	.00	.00	100.00	.00	.00	.00	20,000	
2	AR	AC 0121	.570	4,000.00		.00	.00	.00	195.00	.00	.00	195.00	4,446	

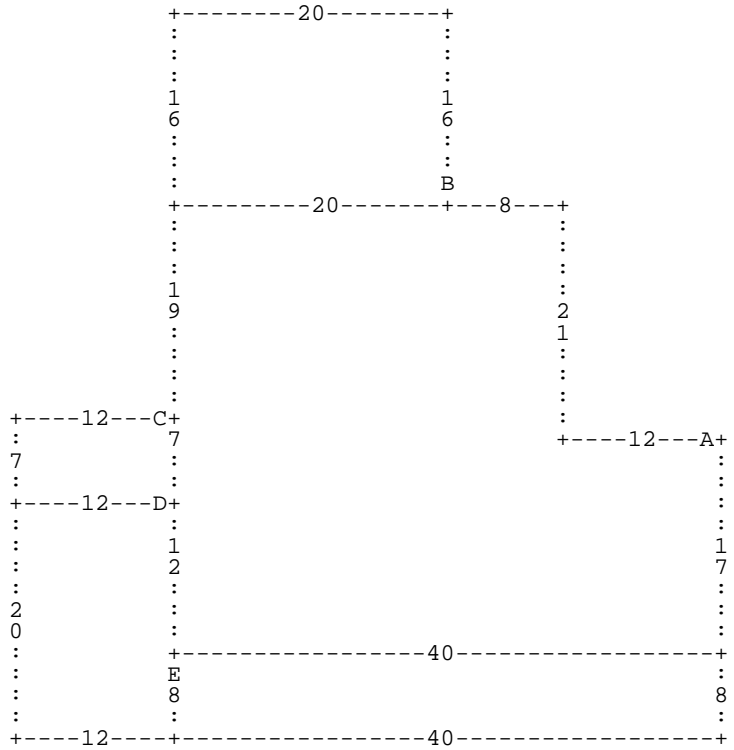

:A DL12 DU21 DL8 :B DU16 DL20 DD16 DR20 * DL20 DD19 :C DL12 DD7 DR12 DU7 * DD7 :
D DL12 DD20 DR12 DU20 * DD12 :E DD8 DR40 DU8 DL40 * DR40 DU17 *

A= MA 111	1,268.00 SFR-1.0 STY	B= AC 1064	320.00 DECK-WOOD	C= AC 1071	84.00 UTILITY STG-F
D= AC 1031	240.00 CARPORT	E= AC 1051	320.00 PORCH-OPEN-FR		