

HOLMAN LLOYD C  
 4841 ST ROSE CHURCH RD  
 1.00LT  
 .830 AC

Wilson County  
 N2 FOUND YR 2024 2783810763.000  
 4841 ST ROSE CHURCH RD  
 PIN: 2783 81 0763 000  
 DISTRICT: 22 C/SW/SIMS FD

ACCOUNT#: 1105615  
 NBHD: 8219 OLD\_FIELDS  
 Plat Bk/Pg SWAF 2.00 EXCD:  
 APPR: REV APPR DT: 3/17/2016  
 NOTICE: 82 3/08/2024

Bldg No. 1  
 Imp Desc: R1.0 SFR-1.0 STY EYB: 1980 4841 ST ROSE CHURCH RD Exempt Code  
 Grade : D+05 D+05 GRADE AYB: 1950 Finished Area: 1,146.00  
 # of Units 4 Rms 3 Bedrms 1.0 Bathrms HBaths

LAND VALUE 38,844  
 MISC VALUE 2,903  
 BLDG VALUE 127,401  
 TOTAL VALUE 169,148

| TYPE/CODE/DESCRIPTION        | PCT  | %CMP | UNITS        | RATE    | STR#  | STR% | SIZ%   | HGT%   | PER% | COST     |
|------------------------------|------|------|--------------|---------|-------|------|--------|--------|------|----------|
| AC 1031 CARPORT              | 100  |      | 392          | 27.90   |       |      | 94.00  |        |      | 10,280   |
| AC 1053 STOOP-MAS            | 100  |      | 24           | 19.40   |       |      | 120.00 |        |      | 558      |
| MA 111 SFR-1.0 STY           | 100  |      | 1146         | 136.00  | 1.00  |      | 106.38 |        |      | 165,798  |
| - AR 03 NO AC & FURNACE HEAT | 100  |      | 1146         | 6.75-   |       |      |        |        |      | 7,735-   |
| - BT BT FULL BATH            | 100  |      | 1-           | 5500.00 |       |      |        |        |      | 5,500-   |
| - EW 19 CONCRETE BLOCK-12"   | 100  |      | 152          | .00     |       |      |        |        |      | 0        |
| - FC 48 VINYL/CARPET         | 100  |      | 1146         | .00     |       |      |        |        |      | 0        |
| - FN 02 CONT WALL-CONC BLOCK | 100  |      | 152          | .00     |       |      |        |        |      | 0        |
| - IF 01 DRYWALL              | 100  |      | 1146         | .00     |       |      |        |        |      | 0        |
| - RC 02 COMPOSITION SHINGLE  | 100  |      | 1146         | .00     |       |      |        |        |      | 0        |
| - RT 03 DOUBLE PITCH ROOF    | 100  |      | 1146         | .00     |       |      |        |        |      | 0        |
| RCN...                       |      |      | PCT COMPLETE |         | 100   | x    |        |        |      | 163,401  |
| QUAL..                       | D+05 |      |              |         | 80.00 | x    |        |        |      | 130,720  |
| DEPR.. RD                    |      |      |              |         | 59.00 | -    |        | 77,124 |      | 77,124 T |
| --ASV...                     |      |      |              |         |       |      |        |        |      | 53,596   |

PROPERTY NOTES:  
 VERIFY ALL BLDGS PER MRS. ELLIS (DAUGHTER).  
 2016 INFORMAL APPEAL

| PERMIT NO | TYPE | DATE | BOOK   | PAGE | DT   | DATE       | QS | SALES | PRICE  |
|-----------|------|------|--------|------|------|------------|----|-------|--------|
|           |      |      | 2636   | 826  | WD   | 11/30/2015 | X  |       | 45,000 |
| AMOUNT    |      |      | 2012CD | 0    | CDTH | 5/18/2012  | X  |       |        |
|           |      |      | 2010CD | 0    | CDTH | 12/30/2010 | X  |       |        |
| AMOUNT    |      |      | 1863   | 311  | WD   | 2/07/2002  | X  |       |        |

| MISC CODE | DESC           | UNITS  | RATE  | AYB  | EYB  | DT  | PCT   | %CMP | ADD.DEPR | PCT | VALUE | EXMPT |
|-----------|----------------|--------|-------|------|------|-----|-------|------|----------|-----|-------|-------|
| 81 1173   | STG-FR 16 X 24 | 384.00 | 24.00 | 1900 | 1965 | MAV | 65.00 | 100  |          |     | 2,903 |       |
|           |                |        |       |      |      |     | .00   |      |          |     |       |       |
|           |                |        |       |      |      |     | .00   |      |          |     |       |       |
|           |                |        |       |      |      |     | .00   |      |          |     |       |       |

| # | ZONE | TYPE/CODE | LAND QTY | LAND RATE | DPTH | DPT% | TOP% | LOC% | SIZ%   | SHP% | OTH% | ADJ    | FMV    | EXMPT |
|---|------|-----------|----------|-----------|------|------|------|------|--------|------|------|--------|--------|-------|
| 1 | AR   | AC 5010   | .830     | 40,000.00 |      | .00  | .00  | .00  | 117.00 | .00  | .00  | 117.00 | 38,844 |       |

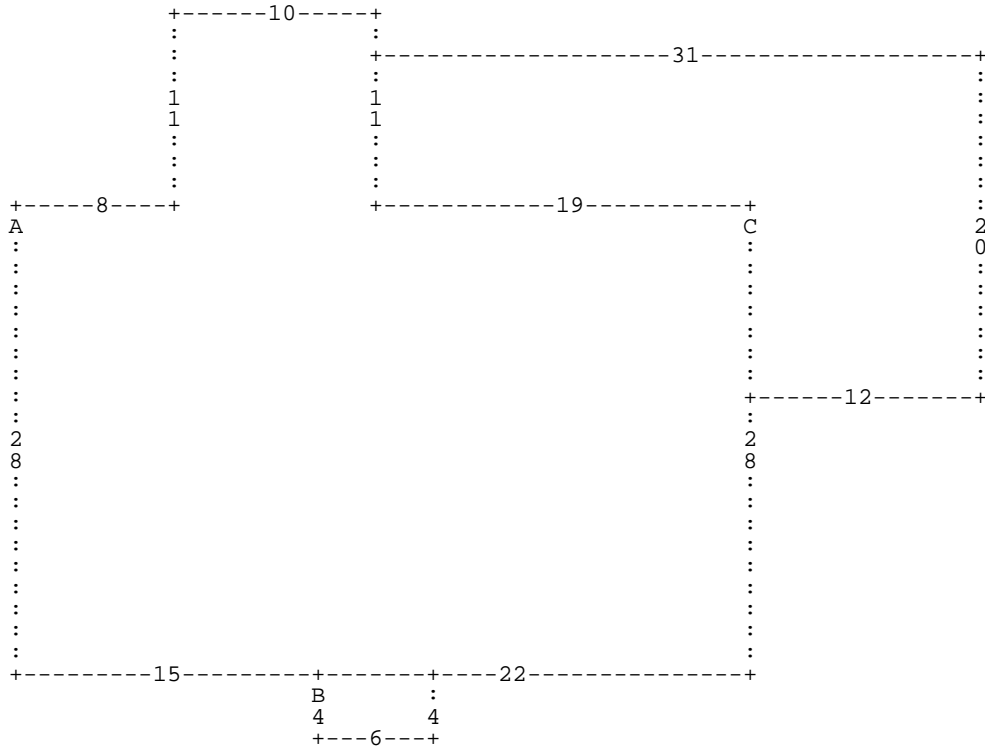

:A DD28 DR15 :B DD4 DR6 DU4 DL6 \* DR22 DU28 :C DD12 DR12 DU20 DL31 DD8 DR19 \* DL  
 19 DU11 DL10 DD11 DL8 \*

A= MA 111

1,146.00 SFR-1.0 STY

B= AC 1053

24.00 STOOP-MAS

C= AC 1031

392.00 CARPORT

HOLMAN LLOYD C  
 4841 ST ROSE CHURCH RD  
 1.00LT  
 .830 AC

N2 FOUND YR 2024 **2783810763.000**  
 4841 ST ROSE CHURCH RD  
 PIN: 2783 81 0763 000  
**DISTRICT:** 22 C/SW/SIMS FD

Wilson County

**ACCOUNT#:** 1105615 **PAGE** 3  
**NBHD:** 8219 OLD\_FIELDS  
 Plat Bk/Pg SWAF 2.00 EXCD: **APPR:** REV APPR DT: 3/17/2016  
**NOTICE:** 82 3/08/2024

Bldg No. 2 Exempt Code  
 Imp Desc: R1.0 SFR-1.0 STY EYB: 1985 4847 ST ROSE CHURCH RD  
 Grade : D+10 D+10 GRADE AYB: 1950 Finished Area: 1,152.00  
 # of Units 3 Rms 2 Bedrms 1.0 Bathrms HBaths

| TYPE/CODE/DESCRIPTION        | PCT  | %CMP | UNITS        | RATE    | STR#  | STR%   | SIZ%   | HGT%   | PER% | COST     |
|------------------------------|------|------|--------------|---------|-------|--------|--------|--------|------|----------|
| AC 1031 CARPORT              | 100  |      | 624          | 27.90   |       |        | 90.00  |        |      | 15,668   |
| AC 1053 STOOP-MAS            | 100  |      | 48           | 19.40   |       |        | 110.00 |        |      | 1,024    |
| AC 1071 UTILITY STG-FR       | 100  |      | 192          | 39.45   |       | 100.00 | 100.00 |        |      | 7,574    |
| MA 111 SFR-1.0 STY           | 100  |      | 1152         | 136.00  | 1.00  |        | 105.94 |        |      | 165,977  |
| - AR 27 ELECTRIC HEAT PUMP   | 100  |      | 1152         | .00     |       |        |        |        |      | 0        |
| - BT BT FULL BATH            | 100  |      | 1-           | 5500.00 |       |        |        |        |      | 5,500-   |
| - EW 19 CONCRETE BLOCK-12"   | 100  |      | 166          | .00     |       |        |        |        |      | 0        |
| - FC 48 VINYL/CARPET         | 100  |      | 1152         | .00     |       |        |        |        |      | 0        |
| - FN 02 CONT WALL-CONC BLOCK | 100  |      | 166          | .00     |       |        |        |        |      | 0        |
| - IF 01 DRYWALL              | 100  |      | 1152         | .00     |       |        |        |        |      | 0        |
| - RC 07 WOOD SHAKES/3D-SHING | 100  |      | 1152         | .00     |       |        |        |        |      | 0        |
| - RT 03 DOUBLE PITCH ROOF    | 100  |      | 1152         | .00     |       |        |        |        |      | 0        |
| -----                        |      |      |              |         |       |        |        |        |      |          |
| RCN...                       |      |      | PCT COMPLETE |         | 100   | x      |        |        |      | 184,743  |
| QUAL..                       | D+10 |      |              |         | 85.00 | x      |        |        |      | 157,031  |
| DEPR..                       | RD   |      |              |         | 53.00 | -      |        | 83,226 |      | 83,226 T |
| --ASV...                     |      |      |              |         |       |        |        |        |      | 73,805   |

PROPERTY NOTES:

| PERMIT NO | TYPE | DATE | BOOK | PAGE | DT | DATE       | QS | SALES | PRICE |
|-----------|------|------|------|------|----|------------|----|-------|-------|
|           |      |      | 669  | 279  | WD | 10/25/1999 | @  |       |       |
| AMOUNT    |      |      |      |      |    | 9/01/1957  | X  |       |       |
| AMOUNT    |      |      |      |      |    |            |    |       |       |

| MISC CODE | DESC | UNITS | RATE | AYB | EYB | DT | PCT | %CMP | ADD.DEPR | PCT | VALUE | EXMPT |
|-----------|------|-------|------|-----|-----|----|-----|------|----------|-----|-------|-------|
|           |      |       |      |     |     |    | .00 |      |          |     |       |       |
|           |      |       |      |     |     |    | .00 |      |          |     |       |       |
|           |      |       |      |     |     |    | .00 |      |          |     |       |       |
|           |      |       |      |     |     |    | .00 |      |          |     |       |       |

| # | ZONE | TYPE/CODE | LAND QTY | LAND RATE | DPTH | DPT% | TOP% | LOC% | SIZ% | SHP% | OTH% | ADJ | FMV | EXMPT |
|---|------|-----------|----------|-----------|------|------|------|------|------|------|------|-----|-----|-------|
|---|------|-----------|----------|-----------|------|------|------|------|------|------|------|-----|-----|-------|

