

HINTON JOHNNIE MILLARD JR
 6239 US 264A HWY W
 TRACT #4 2.62AC
 2.620 AC

Wilson County
 YR 2024 2783023622.000
 6239 US 264A HWY W
 PIN: 2783 02 3622 000
 DISTRICT: 22 C/SW/SIMS FD

ACCOUNT#: 54646320
 NBHD: 8281 SIMS_RA
 Plat Bk/Pg 1.00 EXCD:
 SWAF
 APPR: REV APPR DT: 5/19/2015
 NOTICE: 82 3/08/2024
 PAGE 1

Bldg No. 1
 Imp Desc: R1.0 SFR-1.0 STY EYB: 1970 6239 US 264A HWY W Exempt Code
 Grade : C-10 C-10 GRADE AYB: 1900 Finished Area: 1,704.00
 # of Units 3 Rms 2 Bedrms 1.0 Bathrms 1 HBaths

LAND VALUE 56,135
 MISC VALUE 12,420
 BLDG VALUE 80,536
 TOTAL VALUE 149,091

TYPE/CODE/DESCRIPTION	PCT	%CMP	UNITS	RATE	STR#	STR%	SIZ%	HGT%	PER%	COST
AC 1051 PORCH-OPEN-FR	100		120	38.80			104.00			4,842
AC 1051 PORCH-OPEN-FR	100		40	38.80			110.00			1,707
AC 1052 PORCH-OPEN-MAS	100		216	29.10			100.00			6,285
AC 1064 DECK-WOOD	100		268	24.95			97.00			6,485
MA 111 SFR-1.0 STY	100		1704	136.00	1.00		98.50			228,267
- AR 10 FORCED AIR HEAT W/ A100			1704	.00						0
- BT BT FULL BATH	100		1-	5500.00						5,500-
- BT HBT HALF BATH	100		1	3667.00						3,667
- EW 02 VINYL SIDING	100		168	.00						0
- FC 48 VINYL/CARPET	100		1704	.00						0
- FN 02 CONT WALL-CONC BLOCK100			168	.00						0
- IF 22 DRYWALL/PANEL/PLASTE100			1704	.00						0
- RC 04 METAL-CORRUGATED	100		1704	1.65						2,811
- RT 03 DOUBLE PITCH ROOF	100		1704	.00						0

RCN...			PCT COMPLETE		100	x				248,564
QUAL..	C-10				90.00	x				223,708
DEPR.. RC					64.00	-		143,172		143,172 T
--ASV...										80,536

PROPERTY NOTES:

PERMIT NO	TYPE	DATE	BOOK	PAGE	DT	DATE	QS	SALES	PRICE
			95E	537	WI	11/13/2003	X		
AMOUNT					@	2/17/2003	@		
					@	10/25/1999	@		
AMOUNT			95E	537	WI	11/13/1995	Z		

MISC CODE	DESC	UNITS	RATE	AYB	EYB	DT	PCT	%CMP	ADD.DEPR	PCT	VALUE	EXMPT
82 1173	STG-FR 8 X 12	96.00	24.00	1980	1980	MAV	65.00	100			774	
84 032	BARN-TOB-FRAME 16 X 18	288.00	12.00	1900	1965	MAV	65.00	100			1,137	
85 038	SHED-IMPLEMENT 22 X 40	880.00	9.75	1960	1960	MAV	65.00	100			2,703	
86 020	BARN (GEN PURP) 12 X 16	192.00	13.50	1960	1960	MAV	65.00	100			853	

#	ZONE	TYPE/CODE	LAND QTY	LAND RATE	DPTH	DPT%	TOP%	LOC%	SIZ%	SHP%	OTH%	ADJ	FMV	EXMPT
1	RA	AC 5010	1.000	40,000.00		.00	.00	.00	100.00	.00	.00	.00	40,000	
2	RA	AC 0121	1.620	6,000.00		.00	.00	.00	166.00	.00	.00	166.00	16,135	

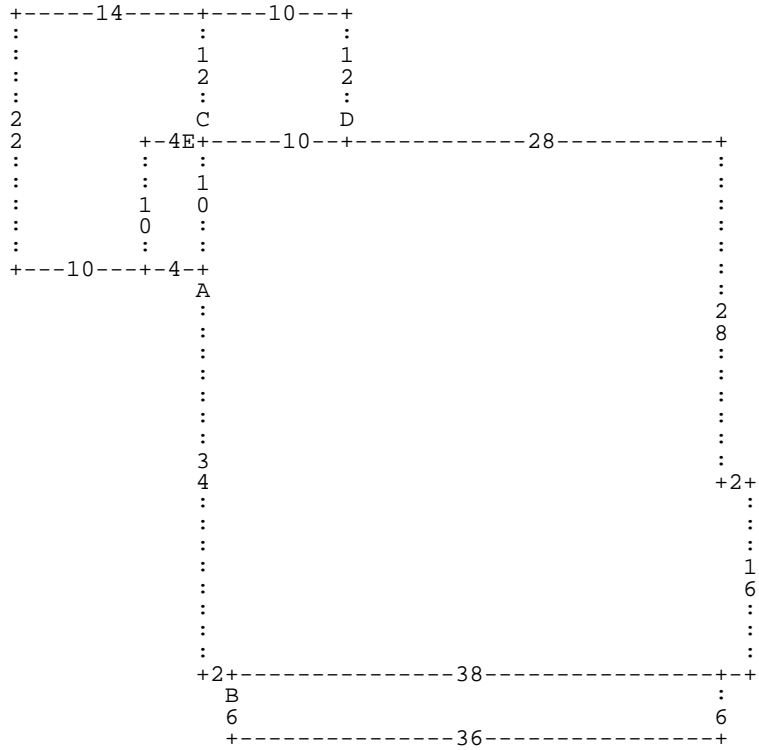

:A DD34 DR2 :B DD6 DR36 DU6 DL36 * DR38 DU16 DL2 DU28 DL28 :D DU12 DL10 DD12 DR1
0 * DL10 :C DU12 DL14 DD22 DR10 DU10 DR4 * :E DL4 DD10 DR4 DU10 * DD10 *

A= MA 111
D= AC 1051

1,704.00 SFR-1.0 STY
120.00 PORCH-OPEN-FR

B= AC 1052
E= AC 1051

216.00 PORCH-OPEN-MA
40.00 PORCH-OPEN-FR

C= AC 1064

268.00 DECK-WOOD

HINTON JOHNNIE MILLARD JR
 6239 US 264A HWY W
 TRACT #4 2.62AC
 2.620 AC

Wilson County
 YR 2024 2783023622.000
 6239 US 264A HWY W
 PIN: 2783 02 3622 000
 DISTRICT: 22 C/SW/SIMS FD

ACCOUNT#: 54646320
 NBHD: 8281 SIMS_RA
 Plat Bk/Pg 1.00 EXCD:
 SWAF
 APPR: REV APPR DT: 5/19/2015
 NOTICE: 82 3/08/2024
 PAGE 3

Bldg No. 1 Exempt Code
 Imp Desc: R1.0 SFR-1.0 STY EYB: 1970 6239 US 264A HWY W
 Grade : C-10 C-10 GRADE AYB: 1900 Finished Area: 1,704.00
 # of Units 3 Rms 2 Bedrms 1.0 Bathrms 1 HBaths

 TYPE/CODE/DESCRIPTION PCT %CMP UNITS RATE STR# STR% SIZ% HGT% PER% COST

PROPERTY NOTES:	PERMIT NO	TYPE	DATE	BOOK	PAGE	DT	DATE	QS	SALES	PRICE
				1105	904	WD	1/01/1974	X		

MISC CODE	DESC	UNITS	RATE	AYB	EYB	DT	PCT	%CMP	ADD.DEPR	PCT	VALUE	EXMPT
87 038	SHED-IMPLEMENT 16 X 16	256.00	9.75	1960	1960	MAV	65.00	100			822	
88 1143	SHELTER-OPEN 18 X 46	828.00	10.50	1960	1960	MAV	65.00	100			2,739	
89 020	BARN (GEN PURP) 33 X 18	594.00	13.50	1960	1960	MAV	65.00	100			2,526	
90 038	SHED-IMPLEMENT 18 X 15	270.00	9.75	1960	1960	MAV	65.00	100			866	

#	ZONE	TYPE/CODE	LAND QTY	LAND RATE	DPTH	DPT%	TOP%	LOC%	SIZ%	SHP%	OTH%	ADJ	FMV	EXMPT
---	------	-----------	----------	-----------	------	------	------	------	------	------	------	-----	-----	-------

