

BOYKIN MIRANDA RAE  
6604 MAIN ST  
.279 AC 1.00LT

Wilson County  
YR 2024 2773827341.000  
6604 MAIN ST  
PIN: 2773 82 7341 000  
DISTRICT: 5 C/CISI/FRSI-SIM

ACCOUNT#: 1131831  
NBHD: 8280 SIMS\_R-15  
Plat Bk/Pg  
EXCD: APPR: REV APPR DT: 5/12/2015  
NOTICE: 82 3/08/2024

Bldg No. 1  
Imp Desc: R1.0 SFR-1.0 STY EYB: 1999 6604 MAIN ST Exempt Code  
Grade : C-10 C-10 GRADE AYB: 1944 Finished Area: 1,056.00  
# of Units 4 Rms 2 Bedrms 2.0 Bathrms HBaths

LAND VALUE 40,000  
MISC VALUE 12,598  
BLDG VALUE 107,434  
TOTAL VALUE 160,032

TYPE/CODE/DESCRIPTION	PCT	%CMP	UNITS	RATE	STR#	STR%	SIZ%	HGT%	PER%	COST
AC 1053 STOOP-MAS	100		24	19.40			120.00			558
AC 1056 PORCH-ENCL-FR	100		112	58.20	1.00	100.00	104.00			6,779
MA 111 SFR-1.0 STY	100		1056	136.00	1.00		107.75			154,746
- AR 03 NO AC & FURNACE HEAT	100		1056	6.75-						7,128-
- EW 17 ALUMINUM SIDING	100		130	.00						0
- FC 20 HARDWOOD/CARPET	100		1056	2.00						2,112
- FN 02 CONT WALL-CONC BLOCK	100		130	.00						0
- IF 08 DRYWALL/PLASTER	100		1056	.00						0
- RC 02 COMPOSITION SHINGLE	100		1056	.00						0
- RT 03 DOUBLE PITCH ROOF	100		1056	.00						0
RCN... PCT COMPLETE					100	x				157,067
QUAL.. C-10					90.00	x				141,360
DEPR.. RC					24.00	-		33,926		33,926 T
--ASV...										107,434

PROPERTY NOTES:

PERMIT NO	TYPE	DATE	BOOK	PAGE	DT	DATE	QS	SALES	PRICE
			3037	82	WD	10/20/2023			160,000
AMOUNT			1972	227	WD	7/15/2003			45,000
AMOUNT			1912	403	WD	10/28/2002	X		42,000
			1912	401	QD	10/28/2002	X		

MISC CODE	DESC	UNITS	RATE	AYB	EYB	DT	PCT	%CMP	ADD.DEPR	PCT	VALUE	EXMPT
81 1121	GARAGE 024 X 026	624.00	51.50	1932	1999	MAV	60.00	100			12,598	
							.00					
							.00					
							.00					

#	ZONE	TYPE/CODE	LAND	QTY	LAND RATE	DPTH	DPT%	TOP%	LOC%	SIZ%	SHP%	OTH%	ADJ	FMV	EXMPT
1	R15	LT 0100		1.000	40,000.00	137	.00	.00	.00	100.00	.00	.00	.00	40,000	

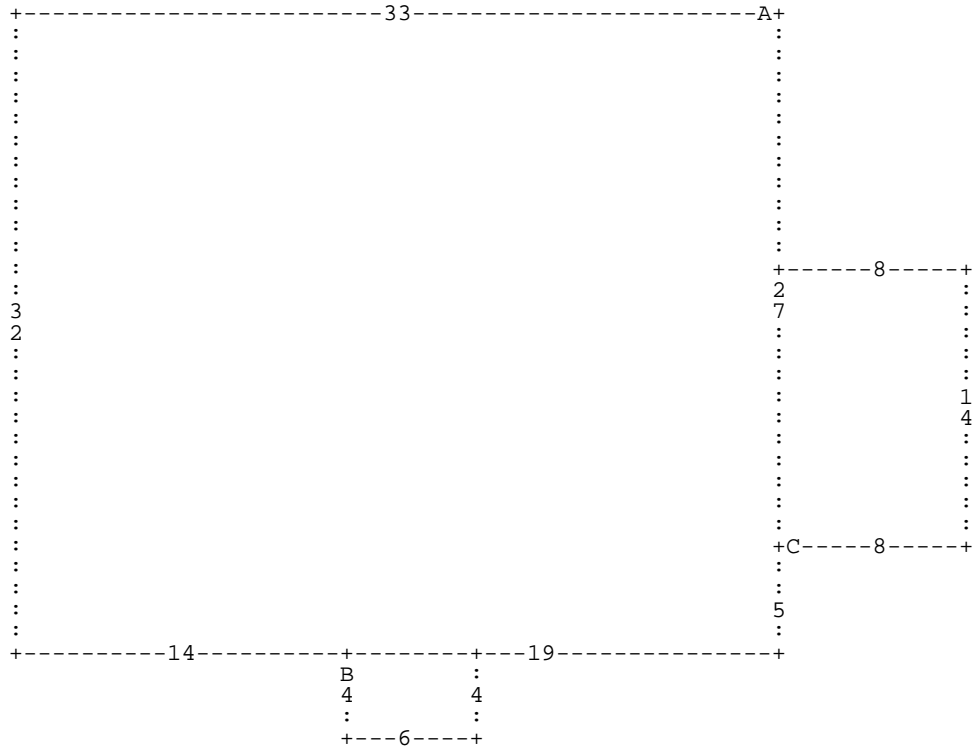

:A DL33 DD32 DR14 :B DD4 DR6 DU4 DL6 \* DR19 DU5 :C DR8 DU14 DL8 DD14 \* DU27 \*

A= MA 111

1,056.00 SFR-1.0 STY

B= AC 1053

24.00 STOOP-MAS

C= AC 1056

112.00 PORCH-ENCL-FR