

ELLIS DANNY R
 6907 WHEATFIELD LN
 P14 STOTTS CRSSNG 1.71AC
 1.710 AC

Wilson County
 N2 FOUND YR 2024 2772873776.000
 6907 WHEATFIELD LN
 PIN: 2772 87 3776 000
 DISTRICT: 19 C/SW/ROCK RIDGE SWAF

ACCOUNT#: 69954188
 NBHD: 8302 STOTTS_CROSSING
 Plat Bk/Pg 32 157 APPR: REV APPR DT: 5/18/2015
 1.00 EXCD: NOTICE: 82 3/08/2024

Bldg No. 1
 Imp Desc: R1.5 SFR-UPTO 1.5 STY EYB: 2005 6907 WHEATFIELD LN Exempt Code
 Grade : B-10 B-10 GRADE AYB: 2005 Finished Area: 2,059.00
 # of Units 5 Rms 3 Bedrms 2.0 Bathrms HBaths

LAND VALUE 67,500
 MISC VALUE 0
 BLDG VALUE 242,949
 TOTAL VALUE 310,449

TYPE/CODE/DESCRIPTION	PCT	%CMP	UNITS	RATE	STR#	STR%	SIZ%	HGT%	PER%	COST
AC 1021 GARAGE-ATT-FR	100		400	42.55			100.00			17,020
AC 1052 PORCH-OPEN-MAS	100		70	29.10			106.00			2,159
AC 1061 PATIO-CONC	100		280	7.50			58.00			1,218
MA 112 SFR-1.5 STY	100		1775	116.00	1.00		98.00			201,782
AT FAT FIN ATTIC	16		284	68.00						19,312
- AR 10 FORCED AIR HEAT W/ A100	100		1775	.00						0
- EW 02 VINYL SIDING	100		232	.00						0
- FC 20 HARDWOOD/CARPET	100		1775	2.00						3,550
- FN 03 CONT WALL-BRICK	100		232	.00						0
- FP 2 PREFAB	100		1	3500.00						3,500
- IF 30 DRYWALL/CUSTOM	100		1775	.00						0
- RC 07 WOOD SHAKES/3D-SHING	100		1775	.00						0
- RT 04 HIP ROOF	100		1775	.00						0
RCN...		PCT COMPLETE			100	x				248,541
QUAL..	B-10				115.00	x				285,822
DEPR.. RB					15.00	-		42,873		42,873
--ASV...										242,949

PROPERTY NOTES:

PERMIT NO	TYPE	DATE	BOOK	PAGE	DT	DATE	QS	SALES PRICE
			2207	67	DC	10/17/2006	C	
AMOUNT			2111	635	WD	6/22/2005		176,000
			2095	300	WD	3/31/2005	A	
AMOUNT			2018	216	WD	2/23/2004	A	337,000

MISC CODE	DESC	UNITS	RATE	AYB	EYB	DT	PCT	%CMP	ADD.DEPR	PCT	VALUE	EXMPT
							.00					
							.00					
							.00					
							.00					

#	ZONE	TYPE/CODE	LAND QTY	LAND RATE	DPTH	DPT%	TOP%	LOC%	SIZ%	SHP%	OTH%	ADJ	FMV	EXMPT
1	RA	LT 5010	1.500	50,000.00		.00	.00	.00	90.00	.00	.00	90.00	67,500	

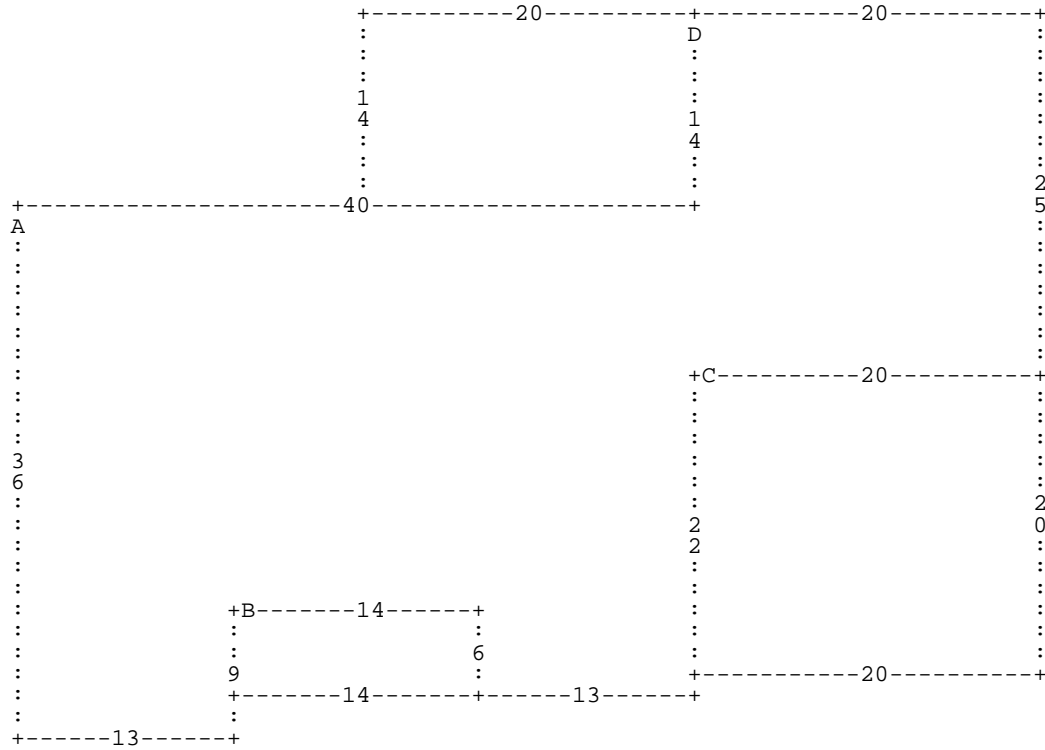

:A DD36 DR13 DU9 :B DR14 DD5 DL14 DU5 * DR14 DD6 DR13 DU22 :C DR20 DD20 DL20 DU2
 0 * DR20 DU25 DL20 :D DD14 DL20 DU14 DR20 * DD14 DL40 *

A= MA 112
D= AC 1061

1,775.00 SFR-1.5 STY
 280.00 PATIO-CONC

B= AC 1052

70.00 PORCH-OPEN-MA

C= AC 1021

400.00 GARAGE-ATT-FR