

VANDIFORD RAY N
6751 NEAL RD
L1 1.370 AC 1.37AC

N2 FOUND YR 2024 2770747470.000
6751 NEAL RD
PIN: 2770 74 7470 000
DISTRICT: 19 C/SW/ROCK RIDGE SWAF

Wilson County
ACCOUNT#: 48784940
NBHD: 8287 SPRING_HILL
Plat Bk/Pg 44 45
EXCD: 1.00

PAGE 1
APPR: GRW APPR DT: 8/21/2023
NOTICE: 82 3/08/2024

Bldg No. 1
Imp Desc: R2.0 SFR-UPTO 2.0 STY
Grade : C+10 C+10 GRADE
of Units 5 Rms 3 Bedrms 2.0 Bathrms HBaths

EYB: 1989 6751 NEAL RD
AYB: 1979 Finished Area: 2,610.00
Exempt Code

LAND VALUE 38,885
MISC VALUE 10,478
BLDG VALUE 208,476
TOTAL VALUE 257,839

TYPE/CODE/DESCRIPTION	PCT	%CMP	UNITS	RATE	STR#	STR%	SIZ%	HGT%	PER%	COST
AC 1021 GARAGE-ATT-FR	100		648	42.55			85.00			23,436
AC 1052 PORCH-OPEN-MAS	100		24	29.10			120.00			838
AC 1053 STOOP-MAS	100		46	19.40			110.00			981
MA 113 SFR-2.0 STY	100		1434	116.00	1.82		90.94			151,272
MA 113 (UPPER FLOORS)	100		1176	116.00	1.82	100.00	90.94			124,056
- AR 10 FORCED AIR HEAT W/ A100	100		2610	.00						0
- EW 02 VINYL SIDING	100		168	.00						0
- FC 06 CARPET	100		2610	.00						0
- FN 03 CONT WALL-BRICK	100		168	.00						0
- FP 3 1STY SNGL	100		1	5100.00						5,100
- IF 30 DRYWALL/CUSTOM	100		1434	.00						0
- RC 02 COMPOSITION SHINGLE	100		1434	.00						0
- RT 09 GAMBREL ROOF	100		1434	.00						0
RCN... PCT COMPLETE					100	x				305,683
QUAL.. C+10					110.00	x				336,251
DEPR.. RC					38.00	-		127,775		127,775
--ASV...										208,476

PROPERTY NOTES:	PERMIT NO	TYPE	DATE	BOOK	PAGE	DT	DATE	QS	SALES	PRICE
SIDING'04				1146	718	SPL	2/23/2023	#		
	AMOUNT					@	12/28/2001	@		
	AMOUNT			1146	718	WD	10/25/1999	@		
							11/01/1977	X		3,000

MISC CODE	DESC	UNITS	RATE	AYB	EYB	DT	PCT	%CMP	ADD.DEPR	PCT	VALUE	EXMPT
81 1176	SHOP-FR 36 X 24	864.00	38.50	1990	1991	MAV	65.00	100			10,478	
							.00					
							.00					
							.00					

#	ZONE	TYPE/CODE	LAND	QTY	LAND RATE	DPTH	DPT%	TOP%	LOC%	SIZ%	SHP%	OTH%	ADJ	FMV	EXMPT
1	AR	AC 5010		1.000	35,000.00		.00	.00	.00	100.00	.00	.00	.00	35,000	
2	AR	AC 0121		.370	5,000.00		.00	.00	.00	210.00	.00	.00	210.00	3,885	

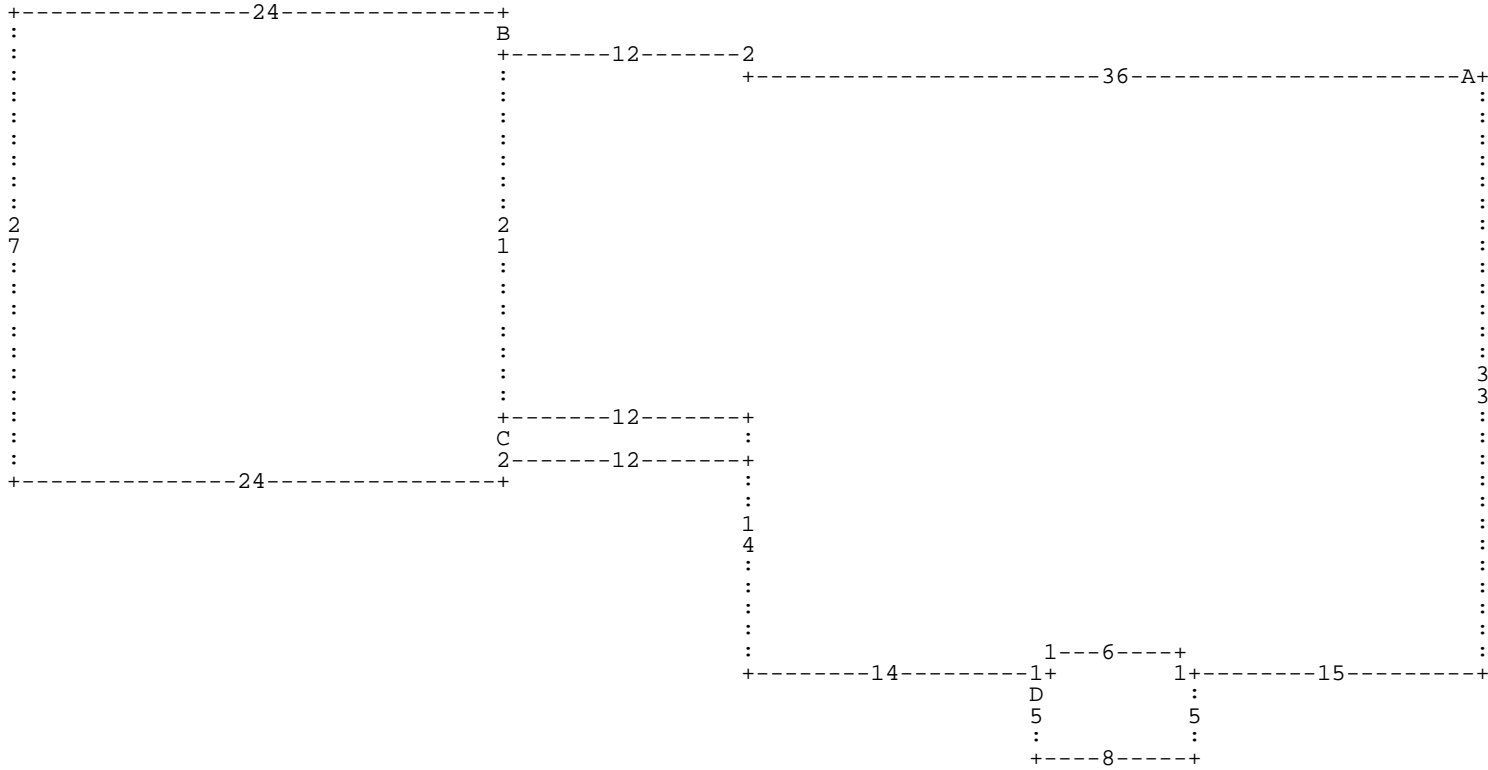

:A DL36 DU2 DL12 :B DU2 DL24 DD27 DR24 DU25 * DD21 :C DD2 DR12 DU2 DL12 * DR12 D
 D14 DR14 :D DD5 DR8 DU5 DL1 DU1 DL6 DD1 DL1 * DR1 DU1 DR6 DD1 DR15 DU33 *

A= MA 113
 D= AC 1053

1,434.00 SFR-2.0 STY
 46.00 STOOP-MAS

B= AC 1021

648.00 GARAGE-ATT-FR

C= AC 1052

24.00 PORCH-OPEN-MA