

MORRIS TERESA GAIL SIMPSON  
 7223 NC 42 HWY W  
 2.320 AC

Wilson County  
 YR 2024 2770246245.000  
 7223 NC 42 HWY W  
 PIN: 2770 24 6245 000  
 DISTRICT: 19 C/SW/ROCK RIDGE SWAF

ACCOUNT#: 1129538  
 NBHD: 8287 SPRING\_HILL  
 Plat Bk/Pg 1.00 EXCD:  
 APPR: REV APPR DT: 3/21/2016  
 NOTICE: 82 3/08/2024

Bldg No. 1  
 Imp Desc: R1.0 SFR-1.0 STY EYB: 1969 7223 NC 42 HWY W Exempt Code  
 Grade : C+10 C+10 GRADE AYB: 1954 Finished Area: 2,228.00  
 # of Units 6 Rms 4 Bedrms 2.0 Bathrms HBaths

LAND VALUE 46,352  
 MISC VALUE 1,833  
 BLDG VALUE 127,634  
 TOTAL VALUE 175,819

TYPE/CODE/DESCRIPTION	PCT	%CMP	UNITS	RATE	STR#	STR%	SIZ%	HGT%	PER%	COST
AC 1031 CARPORT	100		672	27.90			90.00			16,873
AC 1053 STOOP-MAS	100		24	19.40			120.00			558
AC 1056 PORCH-ENCL-FR	100		180	58.20			100.00			10,476
AC 1072 UTILITY STG-MAS	100		20	41.40		100.00	100.00			828
MA 111 SFR-1.0 STY	100		2228	136.00	1.00		93.88			284,462
- AR 10 FORCED AIR HEAT W/ A100	100		2228	.00						0
- EW 18 BRICK VENEER	100		232	35.00						8,120
- FC 48 VINYL/CARPET	100		2228	.00						0
- FN 03 CONT WALL-BRICK	100		232	.00						0
- FP 3 1STY SNGL	100		2	5100.00						10,200
- IF 08 DRYWALL/PLASTER	100		2228	.00						0
- RC 07 WOOD SHAKES/3D-SHING100	100		2228	.00						0
- RT 03 DOUBLE PITCH ROOF	100		2228	.00						0
RCN... PCT COMPLETE					100	x				331,517
QUAL.. C+10					110.00	x				364,668
DEPR.. RC					65.00	-		237,034		237,034
--ASV...										127,634

PROPERTY NOTES:  
 ADDED FUT & SHLTR 4 '10-GRW.  
 2016 INFORMAL APPEAL

PERMIT NO	TYPE	DATE	BOOK	PAGE	DT	DATE	QS	SALES	PRICE
			2021E	556	WI	12/31/2022	E		
AMOUNT			2005	CDTH	CDTH	12/31/2012	E		
AMOUNT				@	@	10/25/1999	@		
			1684	447	WD	8/26/1998	C		

MISC CODE	DESC	UNITS	RATE	AYB	EYB	DT	PCT	%CMP	ADD.DEPR	PCT	VALUE	EXMPT
81 038	SHED-IMPLEMENT 10 X 20	200.00	9.75	1954	1968	MAV	65.00	100			642	
82 1143	SHELTER-OPEN 18 X 20	360.00	10.50	1970	1970	MAV	65.00	100			1,191	
							.00					
							.00					

#	ZONE	TYPE/CODE	LAND QTY	LAND RATE	DPTH	DPT%	TOP%	LOC%	SIZ%	SHP%	OTH%	ADJ	FMV	EXMPT
1	AR	AC 5010	1.000	35,000.00		.00	.00	.00	100.00	.00	.00	.00	35,000	
2	AR	AC 0121	1.320	5,000.00		.00	.00	.00	172.00	.00	.00	172.00	11,352	

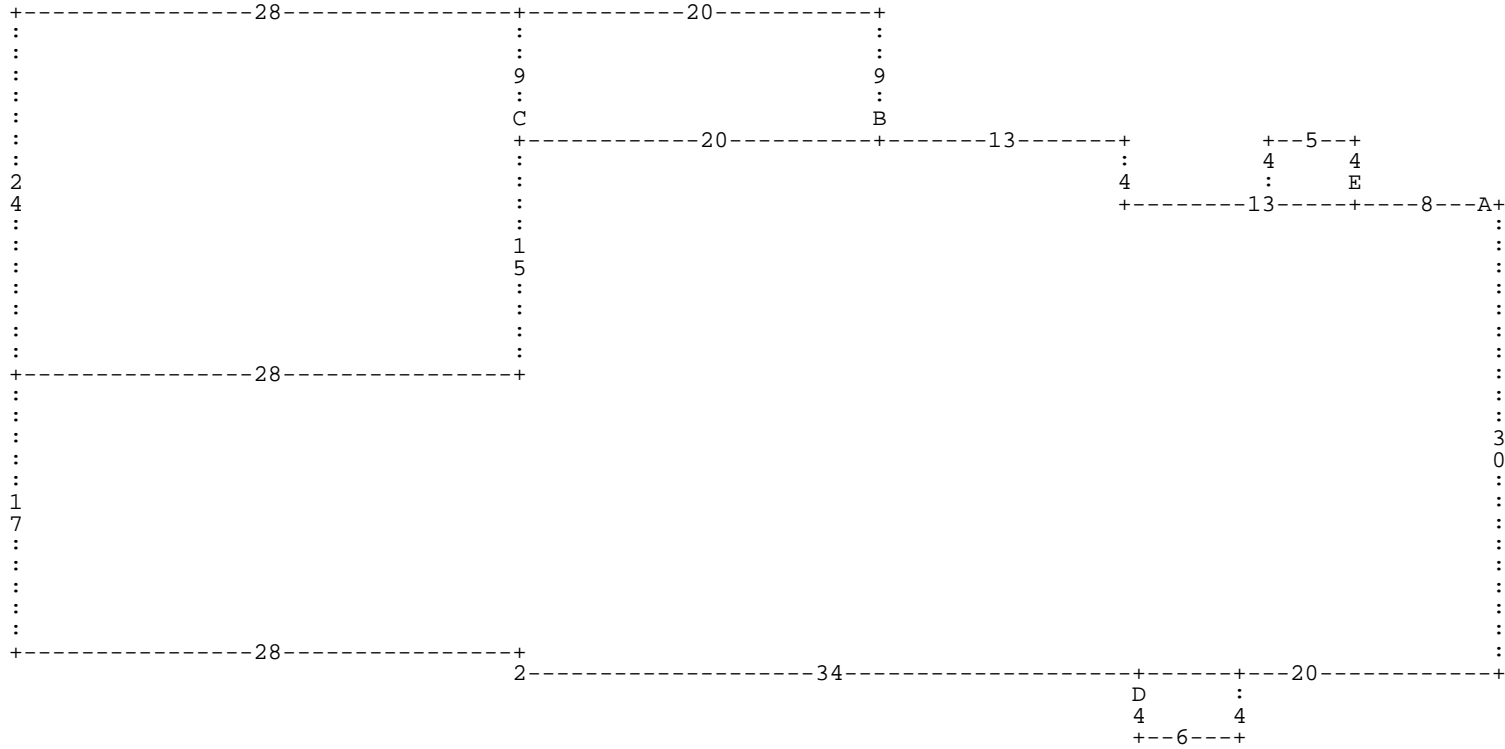

:A DL8 :E DU4 DL5 DD4 DR5 \* DL13 DU4 DL13 :B DU9 DL20 DD9 DR20 \* DL20 :C DU9 DL2  
 8 DD24 DR28 DU15 \* DD15 DL28 DD17 DR28 DD2 DR34 :D DD4 DR6 DU4 DL6 \* DR20 DU30 \*

**A=** MA 111  
**D=** AC 1053

2,228.00 SFR-1.0 STY  
 24.00 STOOP-MAS

**B=** AC 1056  
**E=** AC 1072

180.00 PORCH-ENCL-FR  
 20.00 UTILITY STG-M

**C=** AC 1031

672.00 CARPORT