

BASS ZACHARY  
 5227 NOWELL RD  
 L12 NOWELLS COVE 1.00LT  
 1.000 AC

Wilson County  
 N2 FOUND YR 2024 2761020571.000  
 5227 NOWELL RD  
 PIN: 2761 02 0571 000  
 DISTRICT: 19 C/SW/ROCK RIDGE SWAF

ACCOUNT#: 1123444  
 NBHD: 8215 NOWELLS\_COVE  
 Plat Bk/Pg 32 139 APPR: REV APPR DT: 6/08/2015  
 EXCD: NOTICE: 82 3/08/2024

Bldg No. 1  
 Imp Desc: R1.5 SFR-UPTO 1.5 STY EYB: 2006 5227 NOWELL RD Exempt Code  
 Grade : B-10 B-10 GRADE AYB: 2006 Finished Area: 1,937.00  
 # of Units 5 Rms 3 Bedrms 2.0 Bathrms HBaths

LAND VALUE 50,000  
 MISC VALUE 31,679  
 BLDG VALUE 292,799  
 TOTAL VALUE 374,478

TYPE/CODE/DESCRIPTION	PCT	%CMP	UNITS	RATE	STR#	STR%	SIZ%	HGT%	PER%	COST
AC 1021 GARAGE-ATT-FR	100		550	42.55			90.00			21,062
AC 1052 PORCH-OPEN-MAS	100		210	29.10			100.00			6,111
AC 1052 PORCH-OPEN-MAS	100		90	29.10			104.00			2,723
MA 112 SFR-1.5 STY	100		1937	116.00	1.00		96.38			216,556
- AR 10 FORCED AIR HEAT W/ A100			1937	.00						0
- AT UUS UNF UPPER STY	58		1123	39.00			96.38			42,211
- EW 02 VINYL SIDING	100		204	.00						0
- FC 20 HARDWOOD/CARPET	100		1937	2.00						3,874
- FN 03 CONT WALL-BRICK	100		204	.00						0
- FP 2 PREFAB	100		1	3500.00						3,500
- IF 30 DRYWALL/CUSTOM	100		1937	.00						0
- RC 07 WOOD SHAKES/3D-SHING	100		1937	.00						0
- RT 03 DOUBLE PITCH ROOF	100		1937	.00						0
RCN...			PCT COMPLETE		100	x				296,037
QUAL..	B-10				115.00	x				340,463
DEPR.. RB					14.00	-		47,664		47,664
--ASV...										292,799

PROPERTY NOTES:	PERMIT NO	TYPE	DATE	BOOK	PAGE	DT	DATE	QS	SALES	PRICE
PERMIT CODE: N MO/YR: 042006 NOTE: 2554SFD				2910	309	WD	7/25/2021			333,000
	AMOUNT			2716	774	WD	9/29/2017			280,000
				2218	519	WD	12/12/2006			231,000
	AMOUNT			2135	672	WD	10/14/2005	A		30,000

MISC CODE	DESC	UNITS	RATE	AYB	EYB	DT	PCT	%CMP	ADD.DEPR	PCT	VALUE	EXMPT
81 107	GAR-DET W/APT-F 24 X 24	576.00	97.00	2006	2006	MAV	37.00	100			31,679	
							.00					
							.00					
							.00					

#	ZONE	TYPE/CODE	LAND QTY	LAND RATE	DPTH	DPT%	TOP%	LOC%	SIZ%	SHP%	OTH%	ADJ	FMV	EXMPT
1	AR	LT 5010	1.000	50,000.00		.00	.00	.00	100.00	.00	.00	.00	50,000	

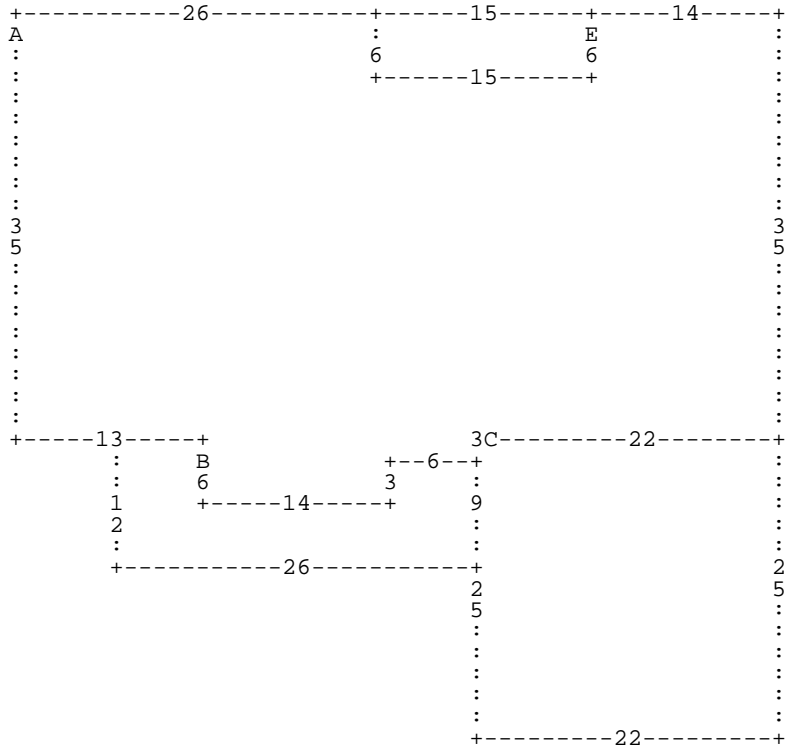

:A DD35 DR13 :B DD6 DR14 DU3 DR6 DD9 DL26 DU12 DR6 \* DD6 DR14 DU3 DR6 DU3 :C DR2  
 2 DD25 DL22 DU25 \* DR22 DU35 DL14 :E DD6 DL15 DU6 DR15 \* DD6 DL15 DU6 DL26 \*

**A=** MA 112  
**E=** AC 1052

1,937.00 SFR-1.5 STY  
 90.00 PORCH-OPEN-MA

**B=** AC 1052

210.00 PORCH-OPEN-MA

**C=** AC 1021

550.00 GARAGE-ATT-FR