

BURGESS TINA MCKEEL
 7646 NC 42 HWY W
 L24S2 STONEGATE 1.00LT
 .990 AC

Wilson County
 YR 2024 2760727879.000
 7646 NC 42 HWY W
 PIN: 2760 72 7879 000
 DISTRICT: 19 C/SW/ROCK RIDGE SWAF

ACCOUNT#: 1102320
 NBHD: 8419 STONEGATE
 Plat Bk/Pg 38 220
 EXCD: 1.00
 APPR: REV APPR DT: 3/21/2016
 NOTICE: 82 3/08/2024

Bldg No. 1
 Imp Desc: R1.0 SFR-1.0 STY EYB: 2013 7646 NC 42 HWY W Exempt Code
 Grade : C+10 C+10 GRADE AYB: 2013 Finished Area: 1,261.00
 # of Units 6 Rms 3 Bedrms 2.0 Bathrms HBaths

LAND VALUE 40,000
 MISC VALUE 0
 BLDG VALUE 183,362
 TOTAL VALUE 223,362

TYPE/CODE/DESCRIPTION	PCT	%CMP	UNITS	RATE	STR#	STR%	SIZ%	HGT%	PER%	COST
AC 1052 PORCH-OPEN-MAS	100		65	29.10		100.00	106.00			2,004
AC 1061 PATIO-CONC	100		248	7.50		100.00	100.00			1,860
AC 1071 UTILITY STG-FR	100		24	39.45		100.00	120.00			1,136
MA 111 SFR-1.0 STY	100		1261	136.00	1.00		104.38			179,006
- AR 27 ELECTRIC HEAT PUMP	100		1261	.00						0
- EW 02 VINYL SIDING	100		156	.00						0
- FC 48 VINYL/CARPET	100		1261	.00						0
- FN 06 SPREAD FOOTING	100		156	5.30-						826-
- IF 01 DRYWALL	100		1261	.00						0
- RC 02 COMPOSITION SHINGLE	100		1261	.00						0
- RT 03 DOUBLE PITCH ROOF	100		1261	.00						0

RCN...			PCT COMPLETE		100	x				183,180
QUAL..		C+10			110.00	x				201,496
DEPR.. RC					9.00	-		18,134		18,134 T
--ASV...										183,362

PROPERTY NOTES:	PERMIT NO	TYPE	DATE	BOOK	PAGE	DT	DATE	QS	SALES	PRICE
CK 4 COMPLETION LATE 13/JHB MECHPERMIT 2/17/17	BP00001333N		8/27/2013	2560	813	WD	1/03/2014	D	119,000	
100% COMPLETE FOR 01/31/2014	AMOUNT			2556	905	WD	11/22/2013	B	15,000	
100% COMPLETE ON 02/04/2014	AMOUNT			2325	756	SPL	10/20/2011	#		
2016 INFORMAL APPEAL										

MISC CODE	DESC	UNITS	RATE	AYB	EYB	DT	PCT	%CMP	ADD.DEPR	PCT	VALUE	EXMPT
							.00					
							.00					
							.00					
							.00					

#	ZONE	TYPE/CODE	LAND QTY	LAND RATE	DPTH	DPT%	TOP%	LOC%	SIZ%	SHP%	OTH%	ADJ	FMV	EXMPT
1	AR	LT 0100	1.000	40,000.00		.00	.00	.00	100.00	.00	.00	.00	40,000	

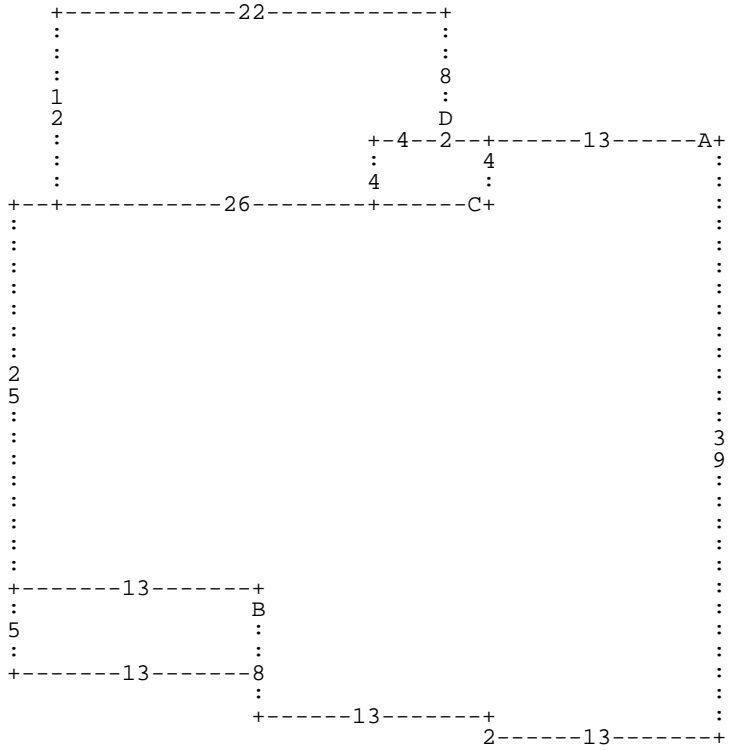

:A DL13 DD4 :C DL6 DU4 DR4 :D DU8 DL22 DD12 DR18 DU4 DR4 * DR2 DD4 * DL26 DD25 D
R13 :B DD5 DL13 DU5 DR13 * DD8 DR13 DD2 DR13 DU39 *

A= MA 111
D= AC 1061

1,261.00 SFR-1.0 STY
248.00 PATIO-CONC

B= AC 1052

65.00 PORCH-OPEN-MA

C= AC 1071

24.00 UTILITY STG-F