

DOCK REBECCA
5607 NC 581 HWY
.920 AC

Wilson County
YR 2024 2760466056.000
5607 NC 581 HWY
PIN: 2760 46 6056 000
DISTRICT: 19 C/SW/ROCK RIDGE SWAF

ACCOUNT#: 69954259
NBHD: 8287 SPRING_HILL
Plat Bk/Pg 1.00 EXCD:
APPR: REV APPR DT: 10/16/2015
NOTICE: 82 3/08/2024

Bldg No. 1
Imp Desc: R1.0 SFR-1.0 STY
Grade : C-05 C-05 GRADE
of Units 4 Rms 3 Bedrms 1.0 Bathrms HBaths
EYB: 1985 5607 NC 581 HWY
AYB: 1971 Finished Area: 1,025.00
Exempt Code
LAND VALUE 34,454
MISC VALUE 2,739
BLDG VALUE 83,579
TOTAL VALUE 120,772

TYPE/CODE/DESCRIPTION	PCT	%CMP	UNITS	RATE	STR#	STR%	SIZ%	HGT%	PER%	COST
AC 1031 CARPORT	100		228	27.90			100.00			6,361
AC 1053 STOOP-MAS	100		24	19.40			120.00			558
AC 1072 UTILITY STG-MAS	100		72	41.40			78.00			2,325
MA 111 SFR-1.0 STY	100		1025	136.00	1.00		108.75			151,597
- AR 27 ELECTRIC HEAT PUMP	100		1025	.00						0
- BT BT FULL BATH	100		1-	5500.00						5,500-
- EW 18 BRICK VENEER	100		132	35.00						4,620
- FC 48 VINYL/CARPET	100		1025	.00						0
- FN 03 CONT WALL-BRICK	100		132	.00						0
- IF 01 DRYWALL	100		1025	.00						0
- RC 02 COMPOSITION SHINGLE	100		1025	.00						0
- RT 03 DOUBLE PITCH ROOF	100		1025	.00						0
RCN...			PCT COMPLETE		100	x				159,961
QUAL..	C-05				95.00	x				151,962
DEPR.. RC					45.00	-		68,383		68,383 T
--ASV...										83,579

PROPERTY NOTES:

PERMIT NO	TYPE	DATE	BOOK	PAGE	DT	DATE	QS	SALES	PRICE
			2117	255	WD	7/15/2005	X		
AMOUNT					@	10/25/1999	@		
			73E	74	WI	1/01/1973	Z		
AMOUNT			1040	344	WD	2/01/1970	X		500,000

MISC CODE	DESC	UNITS	RATE	AYB	EYB	DT	PCT	%CMP	ADD.DEPR	PCT	VALUE	EXMPT
81	1173 STG-FR 12 X 14	168.00	24.00	1971	1974	MAV	65.00	100			1,327	
82	1133 CARPORT-DET-LC 18 X 20	360.00	5.80	1990	1990	MAV	65.00	100			731	
83	1143 SHELTER-OPEN 18 X 20	360.00	10.50	2000	2000	MFR	75.00	100			681	
							.00					

#	ZONE	TYPE/CODE	LAND QTY	LAND RATE	DPTH	DPT%	TOP%	LOC%	SIZ%	SHP%	OTH%	ADJ	FMV	EXMPT
1	AR	AC 5010	.920	35,000.00		.00	.00	.00	107.00	.00	.00	107.00	34,454	

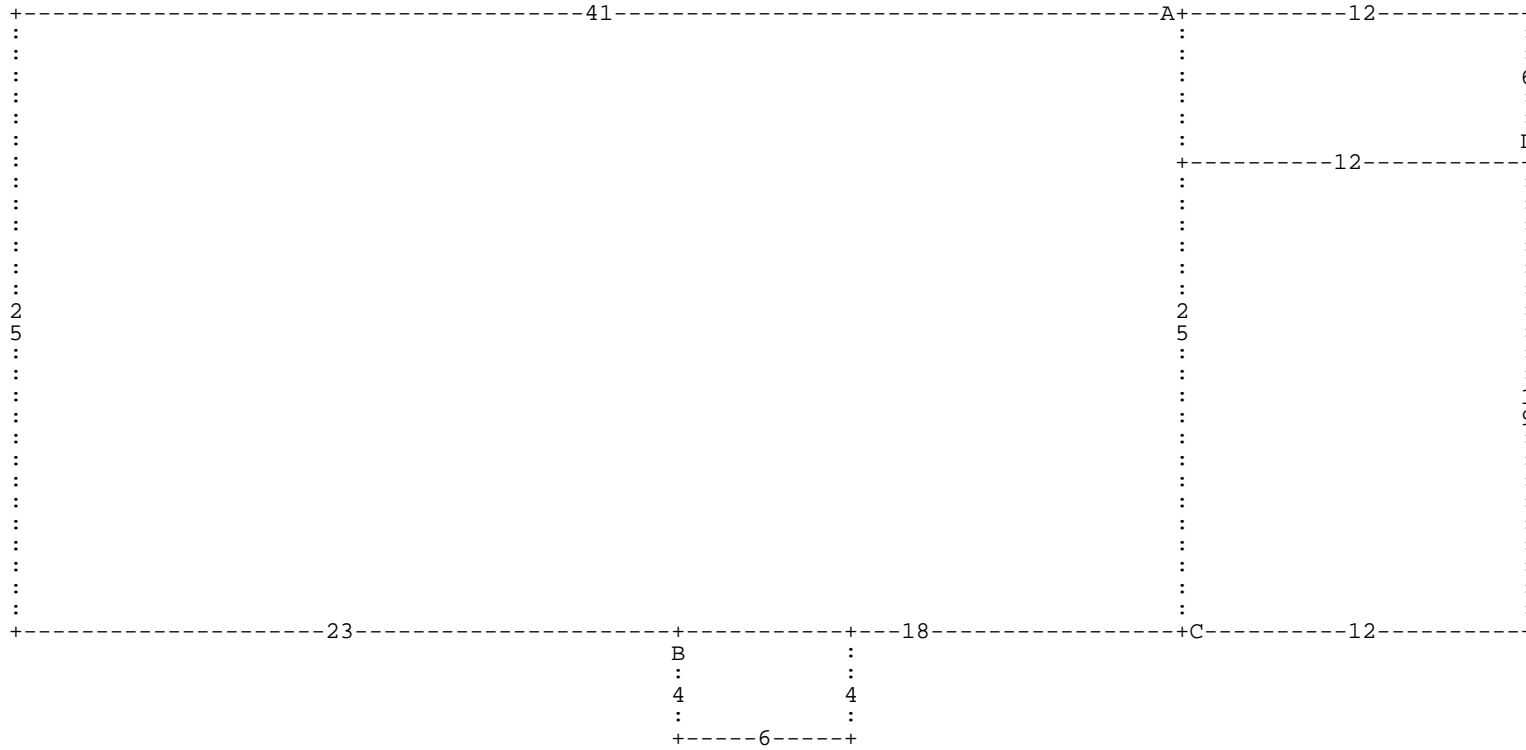

:A DL41 DD25 DR23 :B DD4 DR6 DU4 DL6 * DR18 :C DR12 DU19 :D DU6 DL12 DD6 DR12 *
 DL12 DD19 * DU25 *

A= MA 111
D= AC 1072

1,025.00 SFR-1.0 STY
 72.00 UTILITY STG-M

B= AC 1053

24.00 STOOP-MAS

C= AC 1031

228.00 CARPORT