

NEWTON LARRY M
 5415 RADFORD RD
 L5S1 DEER CROSS 1.00LT
 .920 AC

Wilson County
 YR 2024 2699680416.000
 5415 RADFORD RD
 PIN: 2699 68 0416 000
 DISTRICT: 15 C/SW/CROSSROADS SWAF

ACCOUNT#: 69947750
 NBHD: 8463 DEER CROSS
 Plat Bk/Pg 29 97
 EXCD: 1.00
 APPR: REV APPR DT: 10/08/2015
 NOTICE: 82 3/08/2024
 PAGE 1

Bldg No. 1
 Imp Desc: R1.5 SFR-UPTO 1.5 STY EYB: 2006 5415 RADFORD RD Exempt Code
 Grade : C+10 C+10 GRADE AYB: 2001 Finished Area: 1,597.00
 # of Units 5 Rms 3 Bedrms 2.0 Bathrms HBaths

LAND VALUE 30,000
 MISC VALUE 0
 BLDG VALUE 210,747
 TOTAL VALUE 240,747

TYPE/CODE/DESCRIPTION	PCT	%CMP	UNITS	RATE	STR#	STR%	SIZ%	HGT%	PER%	COST
AC 1021 GARAGE-ATT-FR	100		506	42.55			90.00			19,377
AC 1051 PORCH-OPEN-FR	100		150	38.80			102.00			5,936
AC 1053 STOOP-MAS	100		16	19.40			120.00			372
AC 1071 UTILITY STG-FR	100		54	39.45			106.00			2,258
MA 112 SFR-1.5 STY	100		1597	116.00	1.00		100.00			185,252
- AR 10 FORCED AIR HEAT W/ A100			1597	.00						0
- AT UAT UNF ATTIC	19		303	27.00			100.00			8,181
- EW 02 VINYL SIDING	100		176	.00						0
- FC 20 HARDWOOD/CARPET	100		1597	2.00						3,194
- FN 03 CONT WALL-BRICK	100		176	.00						0
- FP 2 PREFAB	100		1	3500.00						3,500
- IF 30 DRYWALL/CUSTOM	100		1597	.00						0
- RC 07 WOOD SHAKES/3D-SHING100			1597	.00						0
- RT 03 DOUBLE PITCH ROOF	100		1597	.00						0

RCN...			PCT COMPLETE		100	x				228,070
QUAL..	C+10				110.00	x				250,889
DEPR.. RC					16.00	-		40,142		40,142 T
--ASV...										210,747

PROPERTY NOTES:	PERMIT NO	TYPE	DATE	BOOK	PAGE	DT	DATE	QS	SALES	PRICE
PERMIT CODE: N MO/YR: 082002 NOTE: 81637				1923	761	WD	12/18/2002	X		
	AMOUNT			1895	784	WD	8/12/2002		18,500	
	AMOUNT			1202	813	@	8/31/2000	@		
						WD	3/03/1981	X		

MISC CODE	DESC	UNITS	RATE	AYB	EYB	DT	PCT	%CMP	ADD.DEPR	PCT	VALUE	EXMPT
							.00					
							.00					
							.00					
							.00					

#	ZONE	TYPE/CODE	LAND QTY	LAND RATE	DPTH	DPT%	TOP%	LOC%	SIZ%	SHP%	OTH%	ADJ	FMV	EXMPT
1	AR	LT 5010	1.000	30,000.00		.00	.00	.00	100.00	.00	.00	.00	30,000	

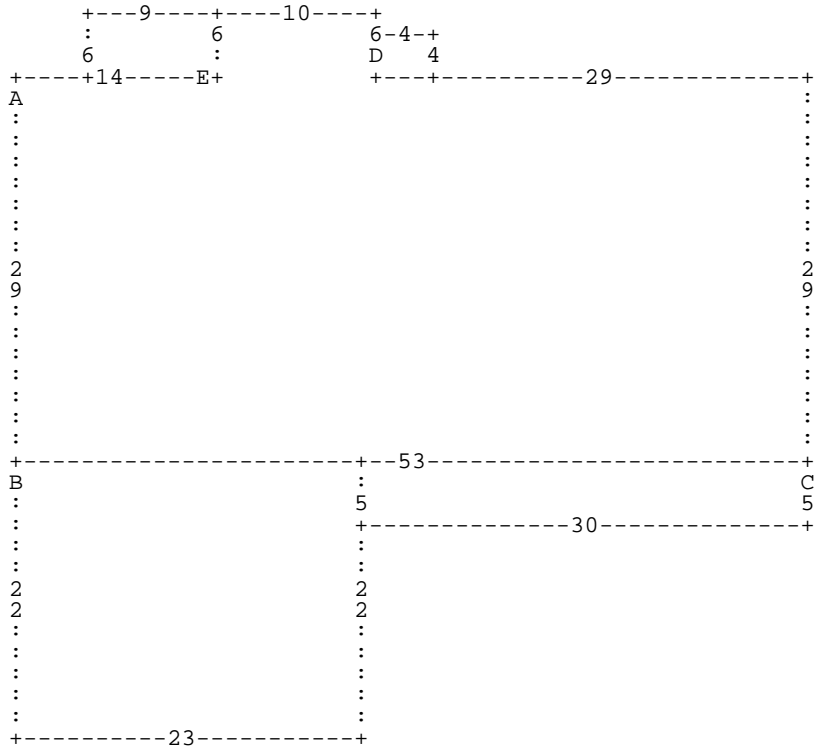

:A DD29 :B DD22 DR23 DU22 DL23 * DR53 :C DD5 DL30 DU5 DR30 * DU29 DL29 :D DU4 DR
 4 DD4 DL4 * DU6 DL10 DD6 :E DL9 DU6 DR9 DD6 * DL14 *

A= MA 112
 D= AC 1053

1,597.00 SFR-1.5 STY
 16.00 STOOP-MAS

B= AC 1021
 E= AC 1071

506.00 GARAGE-ATT-FR
 54.00 UTILITY STG-F

C= AC 1051

150.00 PORCH-OPEN-FR