

AMAYA DENIS FERNANDO LOPEZ
 6413 US 301 HWY S
 M1L6L7 .365 AC

N2 FOUND

Wilson County
 YR 2024 2699104198.000
 6413 US 301 HWY S
 PIN: 2699 10 4198 000
 DISTRICT: 15 C/SW/CROSSROADS SWAF

ACCOUNT#: 1118834
 NBHD: 8178 LUCAMA_CH
 Plat Bk/Pg 4 53
 EXCD: 1.00
 APPR: JHB APPR DT: 8/05/2020
 NOTICE: 82 3/08/2024

PAGE 1

Bldg No. 1
 Imp Desc: R1.0 SFR-1.0 STY
 Grade : C C GRADE
 # of Units 6 Rms 3 Bedrms 2.0 Bathrms HBaths

EYB: 1970 6413 US 301 HWY S
 AYB: 1956 Finished Area: 1,544.00

Exempt Code
 LAND VALUE 19,874
 MISC VALUE 232
 BLDG VALUE 85,490
 TOTAL VALUE 105,596

TYPE/CODE/DESCRIPTION	PCT	%CMP	UNITS	RATE	STR#	STR%	SIZ%	HGT%	PER%	COST
AC 1031 CARPORT	100		354	27.90			94.00			9,284
AC 1053 STOOP-MAS	100		49	19.40			110.00			1,045
AC 1071 UTILITY STG-FR	100		30	39.45			120.00			1,420
MA 111 SFR-1.0 STY	100		1544	136.00	1.00		100.63			211,305
- AR 27 ELECTRIC HEAT PUMP	100		1544	.00						0
- EW 18 BRICK VENEER	100		178	35.00						6,230
- FC 20 HARDWOOD/CARPET	100		1544	2.00						3,088
- FN 03 CONT WALL-BRICK	100		178	.00						0
- FP 3 1STY SNGL	100		1	5100.00						5,100
- IF 01 DRYWALL	100		1544	.00						0
- RC 02 COMPOSITION SHINGLE	100		1544	.00						0
- RT 03 DOUBLE PITCH ROOF	100		1544	.00						0
RCN...					100	x				237,472
QUAL..	C				100.00	x				237,472
DEPR..	RC				64.00	-		151,982		151,982
--ASV...										85,490

PROPERTY NOTES:	PERMIT NO	TYPE	DATE	BOOK	PAGE	DT	DATE	QS	SALES	PRICE
CHANGED EW,FC PER AUDIT WBOR LISTING 4'20	BP00020006A		3/30/2020	2823	846	WD	2/28/2020			77,000
EXPANDED EXITING BATH/05/18/2020/JHB	AMOUNT	11,440		2467	715	WD	12/02/2011	I		30,000
100% COMPLETE ON ADDITION COMBINES WITH BASE/08/05/2020/JHB	BP00200012D		3/19/2020	2422	654	TD	10/11/2010	P		
	AMOUNT					@	5/21/2002	@		

MISC CODE	DESC	UNITS	RATE	AYB	EYB	DT	PCT	%CMP	ADD.DEPR	PCT	VALUE	EXMPT
81 1175	STG-MTL 9 X 10	90.00	11.90	2010	2010	MFR	70.00	100			232	
							.00					
							.00					
							.00					

#	ZONE	TYPE/CODE	LAND QTY	LAND RATE	DPTH	DPT%	TOP%	LOC%	SIZ%	SHP%	OTH%	ADJ	FMV	EXMPT
1	CH	SF 0700	15,899.400	1.25		.00	.00	.00	.00	.00	.00	.00	19,874	

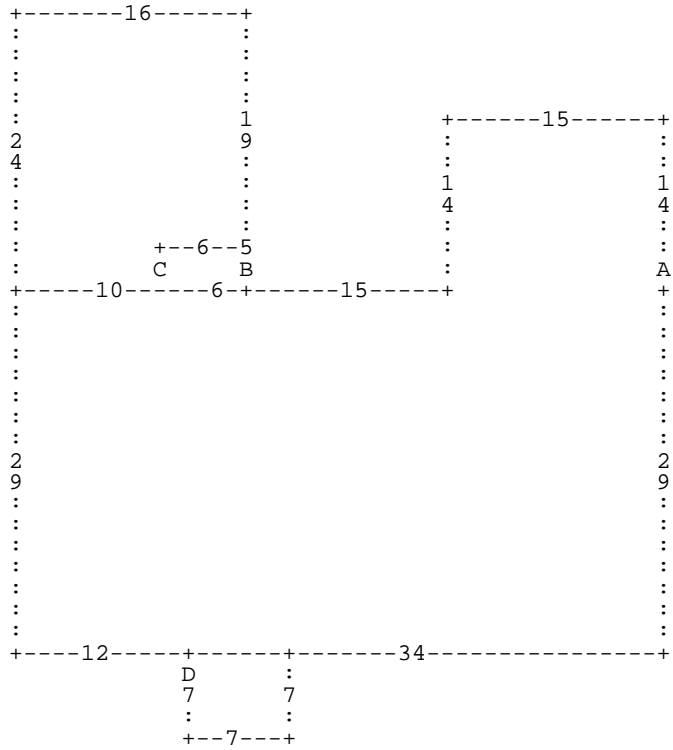

:A DU14 DL15 DD14 DL15 :B DU5 DL6 DD5 DR6 * DL6 :C DU5 DR6 DU19 DL16 DD24 DR10 *
 DL10 DD29 DR12 :D DD7 DR7 DU7 DL7 * DR34 DU29 *

A= MA 111
D= AC 1053

1,544.00 SFR-1.0 STY
 49.00 STOOP-MAS

B= AC 1071

30.00 UTILITY STG-F

C= AC 1031

354.00 CARPORT