

BISSETTE MALISHA WOODARD  
 6166 BLALOCK RD  
 4.730 AC

N2 FOUND YR 2024 **2698880606.000**  
 6166 BLALOCK RD  
 PIN: 2698 88 0606 000  
**DISTRICT:** 15 C/SW/CROSSROADS SWAF

Wilson County

**ACCOUNT#:** 1132354  
**NBHD:** 8183 LUCAMA\_RA-20  
 Plat Bk/Pg 11 57  
**EXCD:** 1.00  
 APPR: REV APPR DT: 3/17/2016  
 NOTICE: 82 3/08/2024

Bldg No. 1  
 Imp Desc: R1.0 SFR-1.0 STY EYB: 1998 6166 BLALOCK RD Exempt Code  
 Grade : C-05 C-05 GRADE AYB: 1978 Finished Area: 1,782.00  
 # of Units 5 Rms 3 Bedrms 2.0 Bathrms HBaths

**LAND VALUE** 46,037  
**MISC VALUE** 5,327  
**BLDG VALUE** 198,729  
**TOTAL VALUE** 250,093

TYPE/CODE/DESCRIPTION	PCT	%CMP	UNITS	RATE	STR#	STR%	SIZ%	HGT%	PER%	COST
AC 1031 CARPORT	100		638	27.90			90.00			16,020
AC 1052 PORCH-OPEN-MAS	100		168	29.10			102.00			4,986
AC 1052 PORCH-OPEN-MAS	100		348	29.10		100.00	97.00			9,823
MA 111 SFR-1.0 STY	100		1782	136.00	1.00		97.75			236,899
- AR 10 FORCED AIR HEAT W/ A100			1782	.00						0
- EW 18 BRICK VENEER	100		174	35.00						6,090
- FC 48 VINYL/CARPET	100		1782	.00						0
- FN 03 CONT WALL-BRICK	100		174	.00						0
- FP 3 1STY SNGL	100		1	5100.00						5,100
- IF 02 PANELING	100		1782	.00						0
- RC 07 WOOD SHAKES/3D-SHING	100		1782	.00						0
- RT 03 DOUBLE PITCH ROOF	100		1782	.00						0
RCN...			PCT COMPLETE		100	x				278,918
QUAL..	C-05				95.00	x				264,972
DEPR.. RC					25.00	-		66,243		66,243 T
--ASV...										198,729

PROPERTY NOTES:  
 2016 INFORMAL APPEAL

PERMIT NO	TYPE	DATE	BOOK	PAGE	DT	DATE	QS	SALES	PRICE
			3044	150	SWD	12/18/2023			240,000
AMOUNT			2743	458	WD	5/16/2018	A		
			2591	784	SPL	1/20/2015	#		
AMOUNT			2591	784	WD	10/17/2014	E		

MISC CODE	DESC	UNITS	RATE	AYB	EYB	DT	PCT	%CMP	ADD.DEPR	PCT	VALUE	EXMPT
81 038	SHED-IMPLEMENT 12 X 26	312.00	9.75	1970	1970	MFR	75.00	100			513	
82 038	SHED-IMPLEMENT 21 X 24	504.00	9.75	1970	1970	MFR	75.00	100			829	
83 1174	STG-MAS 20 X 23	460.00	27.50	1970	1970	MAV	65.00	100			3,985	
							.00					

#	ZONE	TYPE/CODE	LAND QTY	LAND RATE	DPTH	DPT%	TOP%	LOC%	SIZ%	SHP%	OTH%	ADJ	FMV	EXMPT
1	RA20	AC 5010	1.000	25,000.00		.00	.00	.00	100.00	.00	.00	.00	25,000	
2	RA20	AC 0121	3.730	4,000.00		.00	.00	.00	141.00	.00	.00	141.00	21,037	

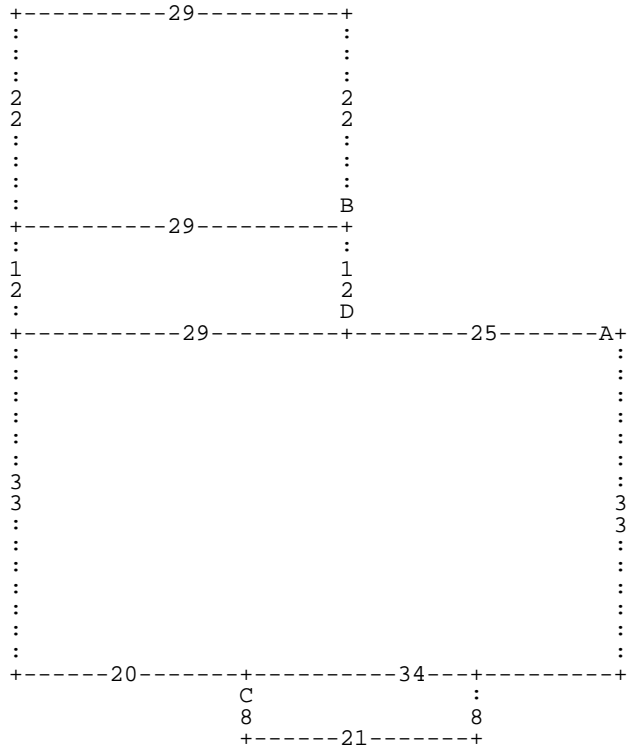

:A DL25 :D DU12 :B DU22 DL29 DD22 DR29 \* DL29 DD12 DR29 \* DL29 DD33 DR20 :C DD8  
DR21 DU8 DL21 \* DR34 DU33 \*

A= MA 111  
D= AC 1052

1,782.00 SFR-1.0 STY  
348.00 PORCH-OPEN-MA

B= AC 1031

638.00 CARPORT

C= AC 1052

168.00 PORCH-OPEN-MA