

TOWN OF LUCAMA
 503 S MAIN ST
 1.210 AC 1.00LT

Wilson County
 YR 2024 2698591394.000
 503 S MAIN ST
 PIN: 2698 59 1394 000
 DISTRICT: 3 C/CILU-LUCAMA

ACCOUNT#: 69913415
 NBHD: 8181 LUCAMA_R-15
 Plat Bk/Pg 7 46
 EXCD: A APPR: REV APPR DT: 7/21/2015
 NOTICE: 82 3/08/2024

Bldg No. 1 CROSSROADS COMMUNITY BUILDING Exempt Code
 Imp Desc: 7707 CLUBS/LODGES EYB: 2002 503 S MAIN ST
 Grade : C+05 C+05 GRADE AYB: 1970 Finished Area: 3,000.00
 # of Units Rms Bedrms Bathrms HBaths
 LAND VALUE 40,002
 MISC VALUE 2,646
 BLDG VALUE 337,166
 TOTAL VALUE 379,814

TYPE/CODE/DESCRIPTION	PCT	%CMP	UNITS	RATE	STR#	STR%	SIZ%	HGT%	PER%	COST
AC 2031 CARPORT	100		576	27.90		100.00	90.00			14,463
AC 2052 PORCH-OPEN-MAS	100		192	29.10			100.00			5,587
AC 2053 STOOP-MAS	100		30	19.40			120.00			698
AC 2053 STOOP-MAS	100		24	19.40			120.00			558
MA 265 LODGE	100		3000	120.00	1.00		118.00			424,800
- AR 27 ELECTRIC HEAT PUMP	100		3000	.00						0
- EW 18 BRICK VENEER	100		260	35.00						9,100
- FC 01 NO COVERING	100		3000	4.65-						13,950-
- FN 06 SPREAD FOOTING	100		260	5.30-						1,378-
- FT 01 WOOD FRAME	100		3000	.00						0
- IF 06 MINIMAL FINISH	100		3000	.00						0
- RC 07 WOOD SHAKES/3D-SHING	100		3000	.00						0
- RT 03 DOUBLE PITCH ROOF	100		3000	.00						0
RCN...			PCT COMPLETE		100	x				439,878
QUAL..		C+05			105.00	x				461,871
DEPR..	C45				27.00	-		124,705		124,705 T
--ASV...										337,166

PROPERTY NOTES:
 FCP 4 '10.

PERMIT NO	TYPE	DATE	BOOK	PAGE	DT	DATE	QS	SALES	PRICE
BP09000007R		10/02/2009	2165	32	WD	3/23/2006	I		
AMOUNT					@	10/25/1999	@		
BP00090031A		7/06/2009	793	600	WD	4/02/1962	C		
AMOUNT									

MISC CODE	DESC	UNITS	RATE	AYB	EYB	DT	PCT	%CMP	ADD.DEPR	PCT	VALUE	EXMPT
81 1143	SHELTER-OPEN 20 X 40	800.00	10.50	1970	1970	MAV	65.00	100			2,646	
							.00					
							.00					
							.00					

#	ZONE	TYPE/CODE	LAND QTY	LAND RATE	DPH	DPT%	TOP%	LOC%	SIZ%	SHP%	OTH%	ADJ	FMV	EXMPT
1	R15	LT 7700	3.000	20,000.00	278	.00	.00	.00	66.67	.00	.00	66.67	40,002	

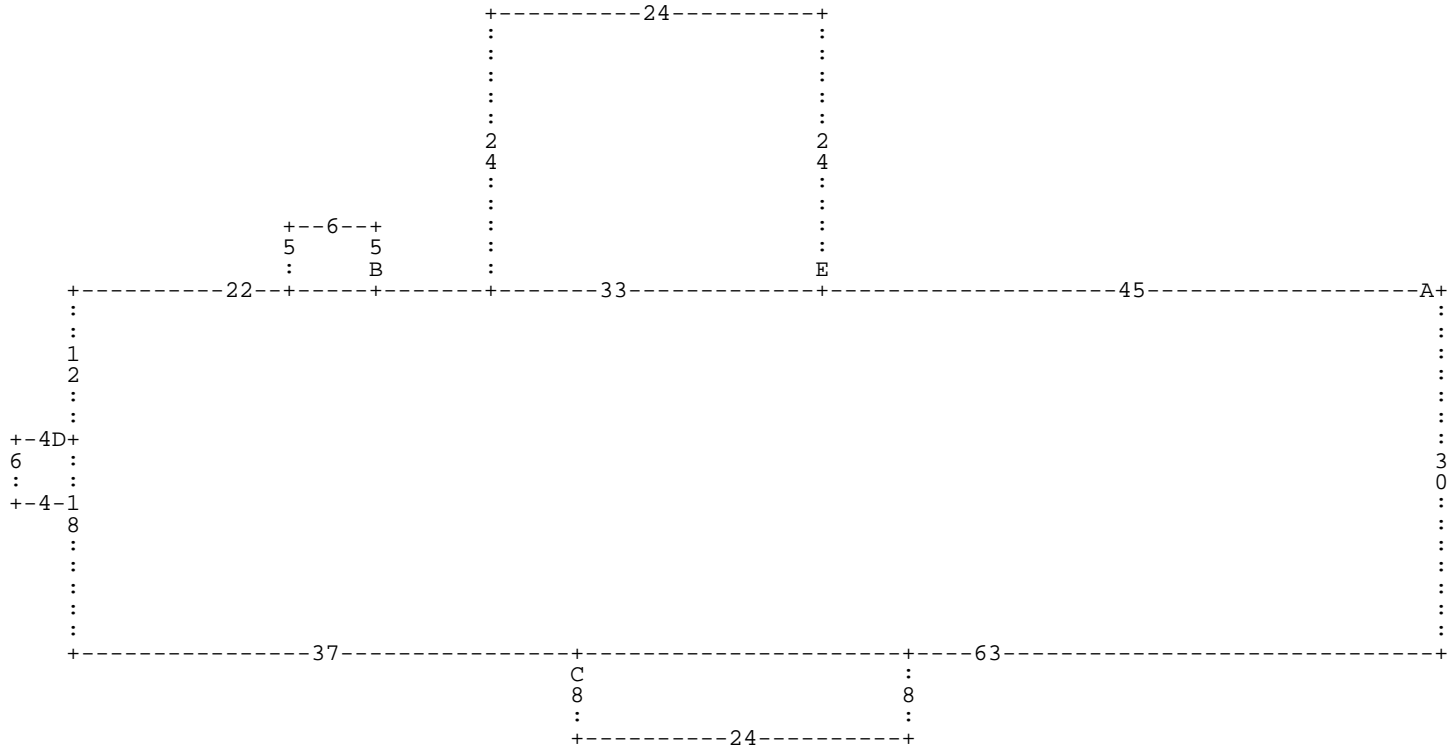

:A DL45 :E DU24 DL24 DD24 DR24 * DL33 :B DU5 DL6 DD5 DR6 * DL22 DD12 :D DL4 DD6
 DR4 DU6 * DD18 DR37 :C DD8 DR24 DU8 DL24 * DR63 DU30 *

A= MA 265
D= AC 2053

3,000.00 LODGE
 24.00 STOOP-MAS

B= AC 2053
E= AC 2031

30.00 STOOP-MAS
 576.00 CARPORT

C= AC 2052

192.00 PORCH-OPEN-MA