

MINSHEW DENNIS  
 7015 CREEKVIEW CT  
 L55L56L57 CRKVIEW 1.46AC  
 1.460 AC

Wilson County  
 N2 FOUND YR 2024 2698218750.000  
 7015 CREEKVIEW CT  
 PIN: 2698 21 8750 000  
 DISTRICT: 15 C/SW/CROSSROADS SWAF

ACCOUNT#: 1130636  
 NBHD: 8078 CREEKVIEW  
 Plat Bk/Pg 12 130  
 EXCD: 1.00  
 APPR: REV APPR DT: 9/22/2015  
 NOTICE: 82 3/08/2024

Bldg No. 1  
 Imp Desc: R1.0 SFR-1.0 STY EYB: 1989 7015 CREEKVIEW CT Exempt Code  
 Grade : C+05 C+05 GRADE AYB: 1975 Finished Area: 1,955.00  
 # of Units 5 Rms 3 Bedrms 2.0 Bathrms HBaths

LAND VALUE 28,680  
 MISC VALUE 6,536  
 BLDG VALUE 188,708  
 TOTAL VALUE 223,924

TYPE/CODE/DESCRIPTION	PCT	%CMP	UNITS	RATE	STR#	STR%	SIZ%	HGT%	PER%	COST
AC 1031 CARPORT	100		484	27.90			90.00			12,153
AC 1052 PORCH-OPEN-MAS	100		69	29.10			106.00			2,128
AC 1064 DECK-WOOD	100		294	24.95			97.00			7,115
MA 111 SFR-1.0 STY	100		1955	136.00	1.00		96.19			255,749
- AR 10 FORCED AIR HEAT W/ A100			1955	.00						0
- EW 18 BRICK VENEER	100		218	35.00						7,630
- FC 48 VINYL/CARPET	100		1955	.00						0
- FN 03 CONT WALL-BRICK	100		218	.00						0
- FP 3 1STY SNGL	100		1	5100.00						5,100
- IF 01 DRYWALL	100		1955	.00						0
- RC 02 COMPOSITION SHINGLE	100		1955	.00						0
- RT 03 DOUBLE PITCH ROOF	100		1955	.00						0
RCN...					100	x				289,875
QUAL..	C+05				105.00	x				304,368
DEPR.. RC					38.00	-		115,660		115,660 T
--ASV...										188,708

PROPERTY NOTES:

PERMIT NO	TYPE	DATE	BOOK	PAGE	DT	DATE	QS	SALES	PRICE
			3015	329	DG	5/08/2023	E		
AMOUNT					@	10/25/1999	@		
AMOUNT			1125	532	WD	7/01/1976	X	16,500	

MISC CODE	DESC	UNITS	RATE	AYB	EYB	DT	PCT	%CMP	ADD.DEPR	PCT	VALUE	EXMPT
81 1121	GAR-DET-FR 24 X 30	720.00	51.50	1975	1975	MFR	75.00	100			6,536	
							.00					
							.00					
							.00					

#	ZONE	TYPE/CODE	LAND	QTY	LAND RATE	DPTH	DPT%	TOP%	LOC%	SIZ%	SHP%	OTH%	ADJ	FMV	EXMPT
1	RA20	AC 5010		1.000	25,000.00		.00	.00	.00	100.00	.00	.00	.00	25,000	
2	RA20	AC 0121		.460	4,000.00		.00	.00	.00	200.00	.00	.00	200.00	3,680	

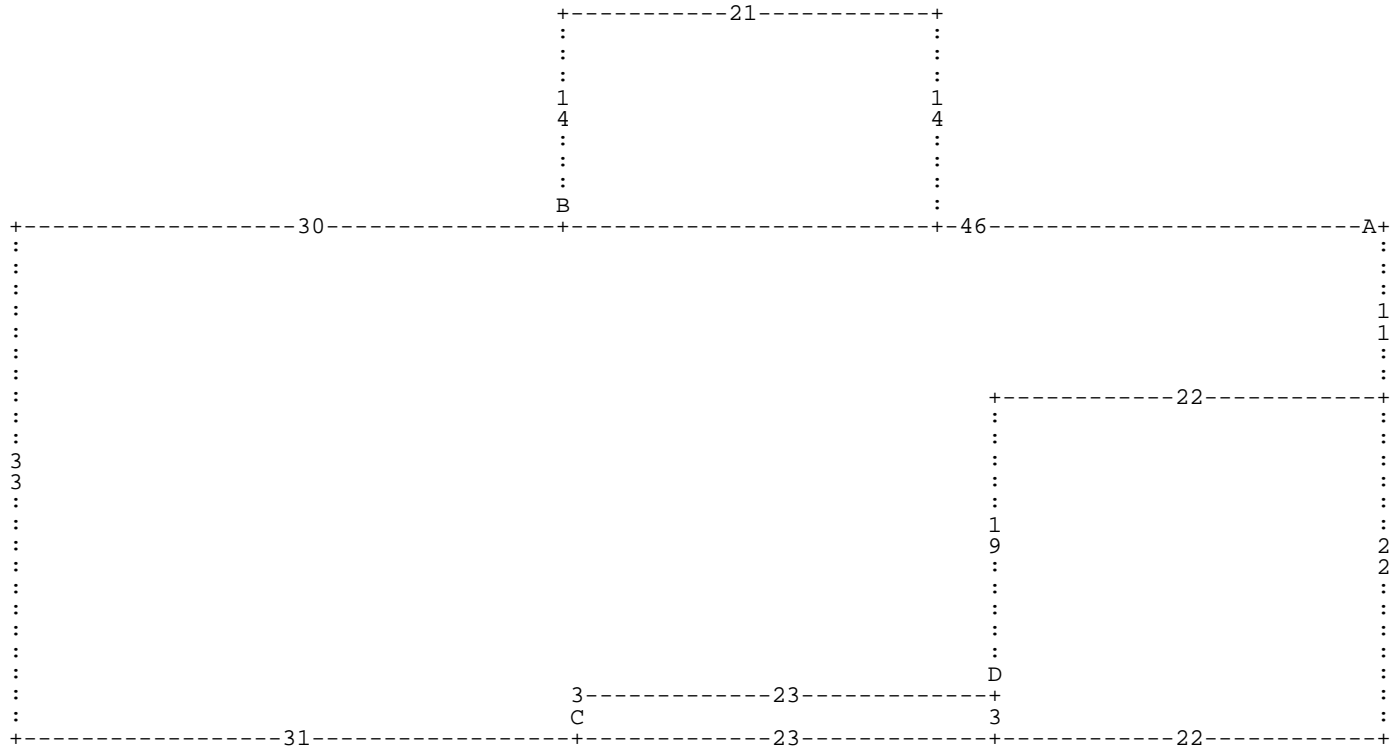

:A DL46 :B DU14 DR21 DD14 DL21 \* DL30 DD33 DR31 :C DU3 DR23 DD3 DL23 \* DU3 DR23  
 :D DU19 DR22 DD22 DL22 DU3 \* DU19 DR22 DU11 \*

A= MA 111  
 D= AC 1031

1,955.00 SFR-1.0 STY  
 484.00 CARPORT

B= AC 1064

294.00 DECK-WOOD

C= AC 1052

69.00 PORCH-OPEN-MA