

TURNER APRIL LYNN
 6609 MOBLEY RD
 L5 1.140 AC 1.14AC

Wilson County
 YR 2024 2698093901.000
 6609 MOBLEY RD
 PIN: 2698 09 3901 000
 DISTRICT: 15 C/SW/CROSSROADS SWAF

ACCOUNT#: 1075240
 NBHD: 8183 LUCAMA_RA-20
 Plat Bk/Pg 34 264 APPR: KRC APPR DT: 12/21/2022
 EXCD: 1.00 NOTICE: 82 3/08/2024

Bldg No. 1
 Imp Desc: R1.0 SFR-1.0 STY EYB: 1985 6609 MOBLEY RD Exempt Code
 Grade : B-10 B-10 GRADE AYB: 1956 Finished Area: 2,775.00
 # of Units 10 Rms 4 Bedrms 2.0 Bathrms HBaths

LAND VALUE 26,288
 MISC VALUE 10,030
 BLDG VALUE 271,008
 TOTAL VALUE 307,326

TYPE/CODE/DESCRIPTION	PCT	%CMP	UNITS	RATE	STR#	STR%	SIZ%	HGT%	PER%	COST
AC 1031 CARPORT	100		506	27.90			90.00			12,705
AC 1052 PORCH-OPEN-MAS	100		42	29.10			110.00			1,344
AC 1061 PATIO-CONC	100		723	7.50			55.00			2,982
AC 1072 UTILITY STG-MAS	100		132	41.40			102.00			5,574
MA 111 SFR-1.0 STY	100		2775	136.00	1.00		90.00			339,660
- AR 10 FORCED AIR HEAT W/ A100	100		2775	.00						0
- EW 18 BRICK VENEER	100		250	35.00						8,750
- FC 51 LAMINATE/TILE	100		2775	6.00						16,650
- FN 03 CONT WALL-BRICK	100		250	.00						0
- FP 3 1STY SNGL	100		1	5100.00						5,100
- IF 01 DRYWALL	100		2775	.00						0
- RC 02 COMPOSITION SHINGLE	100		2775	.00						0
- RT 03 DOUBLE PITCH ROOF	100		2775	.00						0
RCN... PCT COMPLETE					100	x				392,765
QUAL.. B-10					115.00	x				451,679
DEPR.. RB					40.00	-		180,671		180,671
--ASV...										271,008

PROPERTY NOTES:	PERMIT NO	TYPE	DATE	BOOK	PAGE	DT	DATE	QS	SALES	PRICE
UPDATED FC,1/2BATH PER AUDIT 4'23 WBOR LISTING				2997	140	WD	12/16/2022			298,000
	AMOUNT			2940	546	WD	12/29/2021	X		120,000
	AMOUNT			2676	909	WD	11/09/2016	E		
						@	10/25/1999	@		

MISC CODE	DESC	UNITS	RATE	AYB	EYB	DT	PCT	%CMP	ADD.DEPR	PCT	VALUE	EXMPT
81 1178	SHOP-RSF 12 X 20	240.00	28.00	1956	1965	MFR	75.00	100			1,336	
83 1173	STG-FR 22 X 40	880.00	24.00	1966	1969	MFR	75.00	100			3,564	
84 1173	STG-FR 24 X 16	384.00	24.00	1975	1978	MAV	65.00	100			2,903	
85 C9000	BARBECUE	1.00	725.00	1975	1995	MNO	.00	100			725	

#	ZONE	TYPE/CODE	LAND QTY	LAND RATE	DPTH	DPT%	TOP%	LOC%	SIZ%	SHP%	OTH%	ADJ	FMV	EXMPT
1	RA20	AC 5010	1.000	25,000.00		.00	.00	.00	100.00	.00	.00	.00	25,000	
2	RA20	AC 0121	.140	4,000.00		.00	.00	.00	230.00	.00	.00	230.00	1,288	

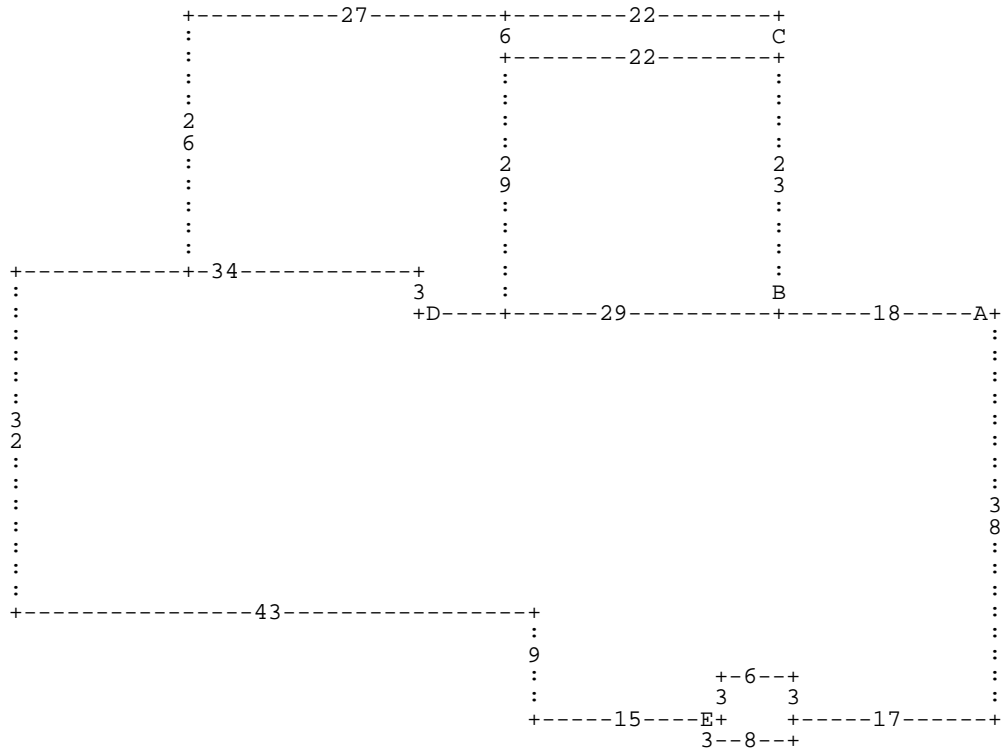

:A DL18 :B DU23 :C DU6 DL22 DD6 DR22 * DL22 DD23 DR22 * DL29 :D DR7 DU29 DL27 DD
 26 DR20 DD3 * DU3 DL34 DD32 DR43 DD9 DR15 :E DL1 DD3 DR8 DU3 DL1 DU3 DL6 DD3 * D
 U3 DR6 DD3 DR17 DU38 *

A= MA 111
D= AC 1061

2,775.00 SFR-1.0 STY
 723.00 PATIO-CONC

B= AC 1031
E= AC 1052

506.00 CARPORT
 42.00 PORCH-OPEN-MA

C= AC 1072

132.00 UTILITY STG-M

TURNER APRIL LYNN
 6609 MOBLEY RD
 L5 1.140 AC 1.14AC

Wilson County
 YR 2024 **2698093901.000**
 6609 MOBLEY RD
 PIN: 2698 09 3901 000
DISTRICT: 15 C/SW/CROSSROADS SWAF

ACCOUNT#: 1075240
NBHD: 8183 LUCAMA_RA-20
 Plat Bk/Pg 34 264 APPR: KRC APPR DT: 12/21/2022
 1.00 EXCD: NOTICE: 82 3/08/2024

Bldg No. 1 Exempt Code
 Imp Desc: R1.0 SFR-1.0 STY EYB: 1985 6609 MOBLEY RD
 Grade : B-10 B-10 GRADE AYB: 1956 Finished Area: 2,775.00
 # of Units 10 Rms 4 Bedrms 2.0 Bathrms HBaths

 TYPE/CODE/DESCRIPTION PCT %CMP UNITS RATE STR# STR% SIZ% HGT% PER% COST

PROPERTY NOTES:

PERMIT NO	TYPE	DATE	BOOK	PAGE	DT	DATE	QS	SALES	PRICE
			933	191	WD	2/23/1966	X		
AMOUNT									
AMOUNT									

MISC CODE	DESC	UNITS	RATE	AYB	EYB	DT	PCT	%CMP	ADD.DEPR	PCT	VALUE	EXMPT
86 66013	DWELLING 22 X 13	286.00	15.00	1975	1978	MAV	65.00	100			1,502	
							.00					
							.00					
							.00					

#	ZONE	TYPE/CODE	LAND QTY	LAND RATE	DPTH	DPT%	TOP%	LOC%	SIZ%	SHP%	OTH%	ADJ	FMV	EXMPT
---	------	-----------	----------	-----------	------	------	------	------	------	------	------	-----	-----	-------

