

CREE BRADLEY JAMES
 6681 GABRIELS WAY
 L3 GABRIELS LNDNG 1.50LT
 1.490 AC

Wilson County
 N2 FOUND YR 2024 2689809354.000
 6681 GABRIELS WAY
 PIN: 2689 80 9354 000
 DISTRICT: 15 C/SW/CROSSROADS SWAF

ACCOUNT#: 1121046
 NBHD: 8409 GABRIELS LANDING
 Plat Bk/Pg 41 143 APPR: JHB APPR DT: 12/18/2020
 EXCD: NOTICE: 82 3/08/2024

Bldg No. 1
 Imp Desc: R1.0 SFR-1.0 STY EYB: 2020 6681 GABRIELS WAY Exempt Code
 Grade : C+10 C+10 GRADE AYB: 2020 Finished Area: 1,183.00
 # of Units 7 Rms 3 Bedrms 2.0 Bathrms HBaths

LAND VALUE 47,250
 MISC VALUE 0
 BLDG VALUE 189,287
 TOTAL VALUE 236,537

| TYPE/CODE/DESCRIPTION | PCT | %CMP | UNITS | RATE | STR# | STR% | SIZ% | HGT% | PER% | COST |
|------------------------------|------|------|--------------|--------|--------|--------|--------|-------|------|---------|
| AC 1052 PORCH-OPEN-MAS | 100 | | 90 | 29.10 | | 100.00 | 104.00 | | | 2,723 |
| AC 1064 DECK-WOOD | 100 | | 144 | 24.95 | | 100.00 | 110.00 | | | 3,952 |
| MA 111 SFR-1.0 STY | 100 | | 1183 | 136.00 | 1.00 | | 105.50 | | | 169,736 |
| - AR 27 ELECTRIC HEAT PUMP | 100 | | 1183 | .00 | | | | | | 0 |
| - EW 02 VINYL SIDING | 100 | | 148 | .00 | | | | | | 0 |
| - FC 52 LAMINATE/CARPET | 100 | | 1183 | 1.50 | | | | | | 1,774 |
| - FN 06 SPREAD FOOTING | 100 | | 148 | 5.30- | | | | | | 784- |
| - IF 30 DRYWALL/CUSTOM | 100 | | 1183 | .00 | | | | | | 0 |
| - RC 07 WOOD SHAKES/3D-SHING | 100 | | 1183 | .00 | | | | | | 0 |
| - RT 03 DOUBLE PITCH ROOF | 100 | | 1183 | .00 | | | | | | 0 |
| RCN... | | | PCT COMPLETE | | 100 | x | | | | 177,401 |
| QUAL.. | C+10 | | | | 110.00 | x | | | | 195,141 |
| DEPR.. RC | | | | | 3.00 | - | | 5,854 | | 5,854 |
| --ASV... | | | | | | | | | | 189,287 |

| PROPERTY NOTES: | PERMIT NO | TYPE | DATE | BOOK | PAGE | DT | DATE | QS | SALES | PRICE |
|-----------------|-----------|------|------|------|------|-----|------------|----|-------|---------|
| SFD 100% 4 21. | | | | 2868 | 124 | WD | 12/15/2020 | | | 172,000 |
| | AMOUNT | | | 2820 | 838 | WD | 2/05/2020 | A | | 42,000 |
| | AMOUNT | | | 2515 | 447 | CMB | 4/06/2018 | Y | | |
| | | | | 2515 | 447 | SWD | 1/09/2013 | A | | 130,000 |

| MISC CODE | DESC | UNITS | RATE | AYB | EYB | DT | PCT | %CMP | ADD.DEPR | PCT | VALUE | EXMPT |
|-----------|------|-------|------|-----|-----|----|-----|------|----------|-----|-------|-------|
| | | | | | | | .00 | | | | | |
| | | | | | | | .00 | | | | | |
| | | | | | | | .00 | | | | | |
| | | | | | | | .00 | | | | | |

| # | ZONE | TYPE/CODE | LAND | QTY | LAND RATE | DPTH | DPT% | TOP% | LOC% | SIZ% | SHP% | OTH% | ADJ | FMV | EXMPT |
|---|------|-----------|------|-------|-----------|------|------|------|------|-------|------|------|-------|--------|-------|
| 1 | RA20 | LT 0100 | | 1.500 | 35,000.00 | | .00 | .00 | .00 | 90.00 | .00 | .00 | 90.00 | 47,250 | |

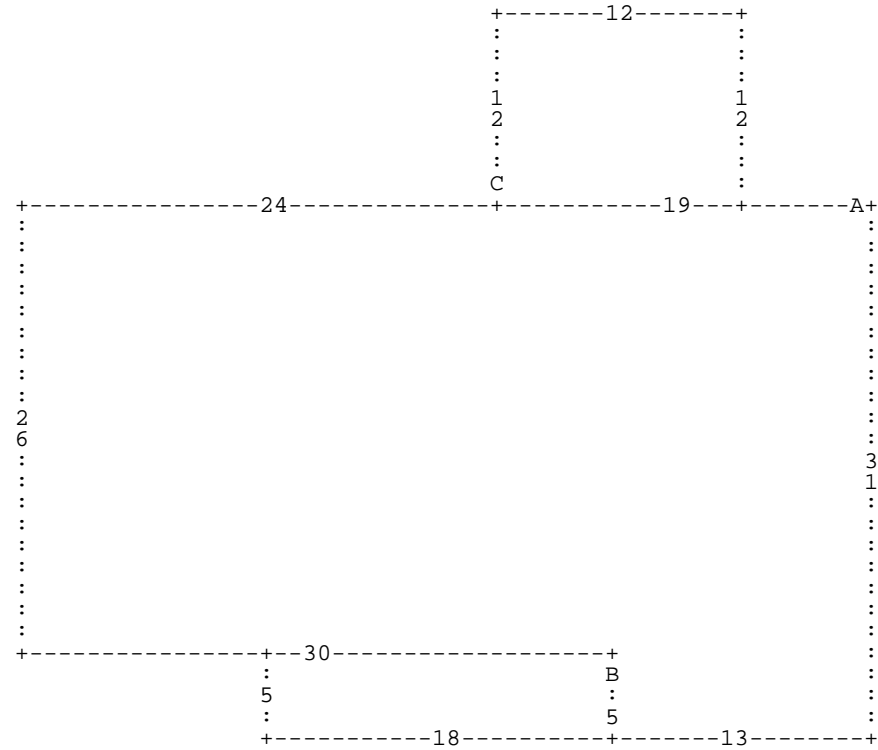

:A DL19 :C DU12 DR12 DD12 DL12 * DL24 DD26 DR30 :B DD5 DL18 DU5 DR18 * DD5 DR13
 DU31 *

A= MA 111

1,183.00 SFR-1.0 STY

B= AC 1052

90.00 PORCH-OPEN-MA

C= AC 1064

144.00 DECK-WOOD