

WOODRUFF KENNETH W  
7659 SPRING HILL CHURCH RD  
.670 AC

N2 FOUND YR 2024 **2679033796.000**  
7659 SPRING HILL CH RD  
PIN: 2679 03 3796 000  
**DISTRICT: 19 C/SW/ROCK RIDGE SWAF**

Wilson County

**ACCOUNT#:** 49817180  
**NBHD:** 8287 SPRING\_HILL  
Plat Bk/Pg 1.00 EXCD:  
APPR: REV APPR DT: 9/18/2015  
NOTICE: 82 3/08/2024

Bldg No. 1  
Imp Desc: R1.0 SFR-1.0 STY  
Grade : C+05 C+05 GRADE  
# of Units 6 Rms 3 Bedrms 2.0 Bathrms HBaths  
EYB: 1980 7659 SPRING HILL CHURCH RD  
AYB: 1970 Finished Area: 2,166.00  
Exempt Code  
**LAND VALUE** 30,485  
**MISC VALUE** 31,519  
**BLDG VALUE** 154,825  
**TOTAL VALUE** 216,829

TYPE/CODE/DESCRIPTION	PCT	%CMP	UNITS	RATE	STR#	STR%	SIZ%	HGT%	PER%	COST
AC 1031 CARPORT	100		280	27.90			97.00			7,577
AC 1052 PORCH-OPEN-MAS	100		168	29.10			102.00			4,986
AC 1054 PORCH-SCR-MAS	100		380	45.80			94.00			16,359
MA 111 SFR-1.0 STY	100		2166	136.00	1.00		94.44			278,196
- AR 10 FORCED AIR HEAT W/ A100			2166	.00						0
- EW 18 BRICK VENEER	100		238	35.00						8,330
- FC 48 VINYL/CARPET	100		2166	.00						0
- FN 03 CONT WALL-BRICK	100		238	.00						0
- FP 3 1STY SNGL	100		1	5100.00						5,100
- IF 01 DRYWALL	100		2166	.00						0
- RC 07 WOOD SHAKES/3D-SHING	100		2166	.00						0
- RT 03 DOUBLE PITCH ROOF	100		2166	.00						0

RCN...		PCT COMPLETE	100	x			320,548
QUAL..	C+05		105.00	x			336,575
DEPR..	RC		54.00	-	181,750		181,750 T
--ASV...							154,825

PROPERTY NOTES:  
SHELTER '05. FIXED OBS & WDD 2 FSP 4 '11-GRW.  
PERMIT CODE: N MO/YR: 012000 NOTE: 10000

PERMIT NO	TYPE	DATE	BOOK	PAGE	DT	DATE	QS	SALES	PRICE
BP01000112A		3/25/2010			@	10/25/1999	@		
AMOUNT		5,280	1027	366	WD	2/01/1969	X		
AMOUNT									

MISC CODE	DESC	UNITS	RATE	AYB	EYB	DT	PCT	%CMP	ADD.DEPR	PCT	VALUE	EXMPT
81 1176	SHOP-FR 30 X 40	1,200.00	38.50	1999	1999	MAV	60.00	100			16,632	
82 1131	CARPORT-DET-FR 30 X 30	900.00	26.75	2004	2004	MAV	43.00	100			12,351	
83 1142	LEAN-TO 12 X 40	480.00	4.80	2005	2005	MAV	40.00	100			1,383	
84 1173	STG-FR 8 X 10	80.00	24.00	1980	1980	MAV	65.00	100			659	

#	ZONE	TYPE/CODE	LAND QTY	LAND RATE	DPTH	DPT%	TOP%	LOC%	SIZ%	SHP%	OTH%	ADJ	FMV	EXMPT
1	AR	AC 5010	.670	35,000.00		.00	.00	.00	130.00	.00	.00	130.00	30,485	

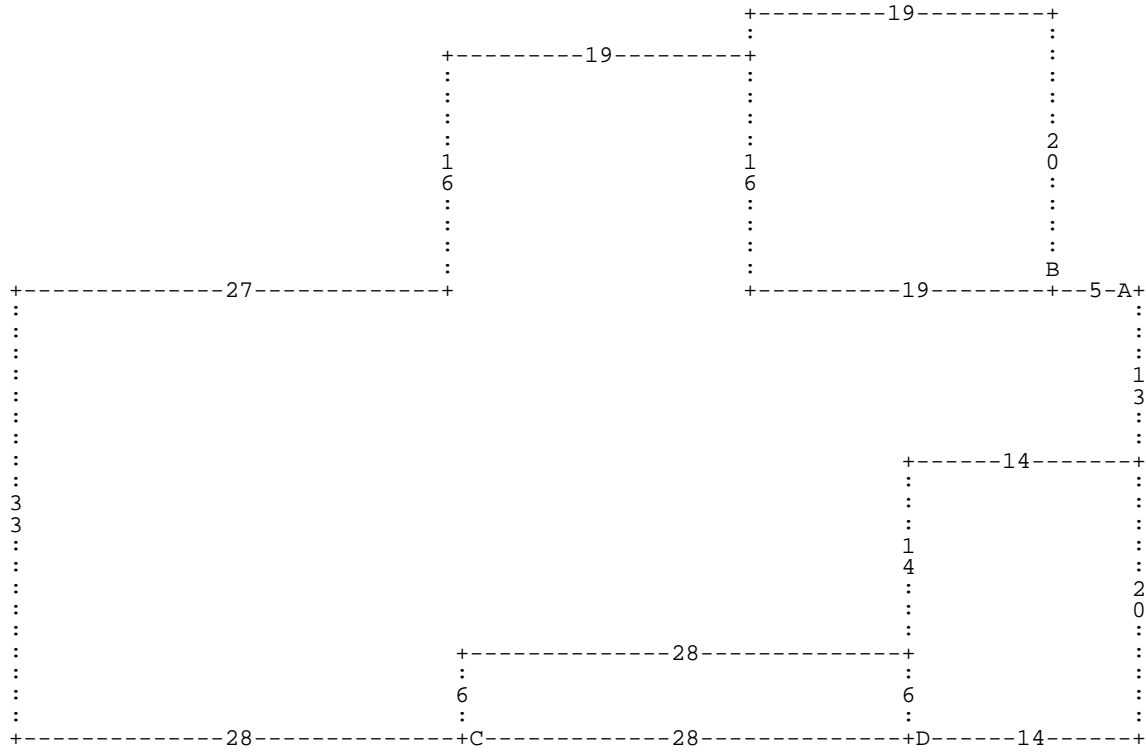

:A DL5 :B DU20 DL19 DD20 DR19 \* DL19 DU16 DL19 DD16 DL27 DD33 DR28 :C DR28 :D DR  
 14 DU20 DL14 DD20 \* DU6 DL28 DD6 \* DU6 DR28 DU14 DR14 DU13 \*

A= MA 111  
 D= AC 1031

2,166.00 SFR-1.0 STY  
 280.00 CARPORT

B= AC 1054

380.00 PORCH-SCR-MAS

C= AC 1052

168.00 PORCH-OPEN-MA

WOODRUFF KENNETH W  
 7659 SPRING HILL CHURCH RD  
 .670 AC

N2 FOUND YR 2024 **2679033796.000**  
 7659 SPRING HILL CH RD  
 PIN: 2679 03 3796 000  
**DISTRICT:** 19 C/SW/ROCK RIDGE SWAF

Wilson County

**ACCOUNT#:** 49817180  
**NBHD:** 8287 SPRING\_HILL  
 Plat Bk/Pg 1.00 EXCD: APPR: REV APPR DT: 9/18/2015  
 NOTICE: 82 3/08/2024

Bldg No. 1 Exempt Code  
 Imp Desc: R1.0 SFR-1.0 STY EYB: 1980 7659 SPRING HILL CHURCH RD  
 Grade : C+05 C+05 GRADE AYB: 1970 Finished Area: 2,166.00  
 # of Units 6 Rms 3 Bedrms 2.0 Bathrms HBaths

-----  
**TYPE/CODE/DESCRIPTION PCT %CMP UNITS RATE STR# STR% SIZ% HGT% PER% COST**  
 -----

PROPERTY NOTES:

PERMIT NO	TYPE	DATE	BOOK	PAGE	DT	DATE	QS	SALES	PRICE

MISC CODE	DESC	UNITS	RATE	AYB	EYB	DT	PCT	%CMP	ADD.DEPR	PCT	VALUE	EXMPT
85 1151	PORCH-DET-FR 4 X 8	32.00	41.55	1980	1980	MAV	65.00	100			494	
							.00					
							.00					
							.00					

#	ZONE	TYPE/CODE	LAND QTY	LAND RATE	DPTH	DPT%	TOP%	LOC%	SIZ%	SHP%	OTH%	ADJ	FMV	EXMPT
---	------	-----------	----------	-----------	------	------	------	------	------	------	------	-----	-----	-------

