

PERRY FRED ROBERT
 8275 NEWSOME MILL RD
 L1 .580 AC

Wilson County
 YR 2024 2677583689.000
 8275 NEWSOME MILL RD
 PIN: 2677 58 3689 000
 DISTRICT: 20 C/SW/BEULAH FD SWAF

ACCOUNT#: 69937014
 NBHD: 8287 SPRING_HILL
 Plat Bk/Pg 21 207
 EXCD: 1.00
 APPR: REV APPR DT: 10/06/2015
 NOTICE: 82 3/08/2024
 PAGE 1

Bldg No. 1
 Imp Desc: R1.0 SFR-1.0 STY EYB: 1995 8275 NEWSOME MILL RD Exempt Code
 Grade : C+05 C+05 GRADE AYB: 1990 Finished Area: 1,458.00
 # of Units 5 Rms 3 Bedrms 2.0 Bathrms HBaths

LAND VALUE 28,420
 MISC VALUE 717
 BLDG VALUE 172,853
 TOTAL VALUE 201,990

TYPE/CODE/DESCRIPTION	PCT	%CMP	UNITS	RATE	STR#	STR%	SIZ%	HGT%	PER%	COST
AC 1031 CARPORT	100		294	27.90			97.00			7,956
AC 1052 PORCH-OPEN-MAS	100		125	29.10			104.00			3,783
AC 1064 DECK-WOOD	100		222	24.95			100.00			5,538
AC 1072 UTILITY STG-MAS	100		84	41.40			70.00			2,434
MA 111 SFR-1.0 STY	100		1458	136.00	1.00		101.56			201,380
- AR 10 FORCED AIR HEAT W/ A100	100		1458	.00						0
- EW 18 BRICK VENEER	100		162	35.00						5,670
- FC 48 VINYL/CARPET	100		1458	.00						0
- FN 03 CONT WALL-BRICK	100		162	.00						0
- FP 3 1STY SNGL	100		1	5100.00						5,100
- IF 01 DRYWALL	100		1458	.00						0
- RC 02 COMPOSITION SHINGLE	100		1458	.00						0
- RT 03 DOUBLE PITCH ROOF	100		1458	.00						0
RCN...			PCT COMPLETE		100	x				231,861
QUAL..	C+05				105.00	x				243,454
DEPR.. RC					29.00	-		70,601		70,601
--ASV...										172,853

PROPERTY NOTES:

PERMIT NO	TYPE	DATE	BOOK	PAGE	DT	DATE	QS	SALES	PRICE
			1672	466	WD	10/23/2003	@		
AMOUNT			1400	379	WD	5/29/1998	U	88,500	
AMOUNT						7/01/1990	X		

MISC CODE	DESC	UNITS	RATE	AYB	EYB	DT	PCT	%CMP	ADD.DEPR	PCT	VALUE	EXMPT
81 1173	STG-FR 12 X 12	144.00	24.00	2000	2000	MFR	75.00	100			622	
82 1142	LEAN-TO 8 X 12	96.00	4.80	2000	2000	MFR	75.00	100			95	
							.00					
							.00					

#	ZONE	TYPE/CODE	LAND QTY	LAND RATE	DPTH	DPT%	TOP%	LOC%	SIZ%	SHP%	OTH%	ADJ	FMV	EXMPT
1	AR	AC 5010	.580	35,000.00		.00	.00	.00	140.00	.00	.00	140.00	28,420	

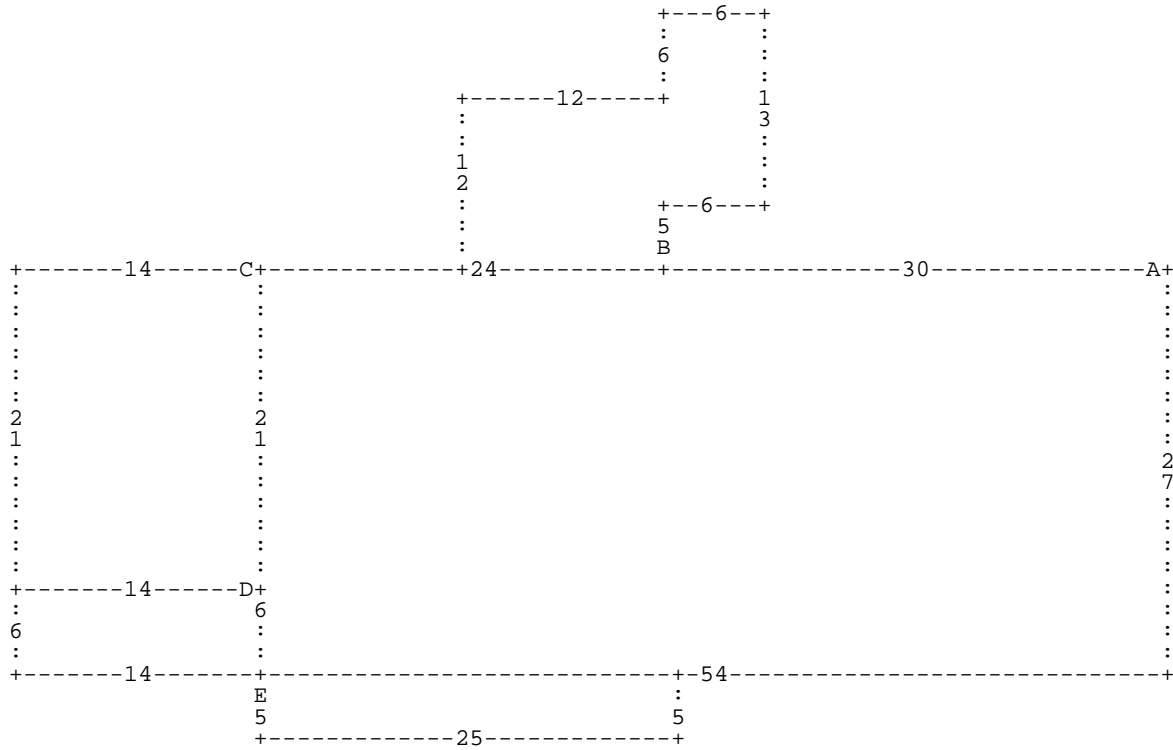

:A DL30 :B DU5 DR6 DU13 DL6 DD6 DL12 DD12 DR12 * DL24 :C DL14 DD21 DR14 DU21 * D
 D21 :D DL14 DD6 DR14 DU6 * DD6 :E DD5 DR25 DU5 DL25 * DR54 DU27 *

A= MA 111
D= AC 1072

1,458.00 SFR-1.0 STY
 84.00 UTILITY STG-M

B= AC 1064
E= AC 1052

222.00 DECK-WOOD
 125.00 PORCH-OPEN-MA

C= AC 1031

294.00 CARPORT