

Wilson County
 YOUNG JEREMY SCOTT N2 FOUND YR 2024 2677415589.000 ACCOUNT#: 1120292 PAGE 1
 9015 FRANK RD 9015 FRANK RD NBHD: 8469 FARMSTEAD SUBD
 L6S1 FARMSTEAD 1.00LT PIN: 2677 41 5589 000 Plat Bk/Pg 20 111 APPR: JHB APPR DT: 3/08/2021
 1.000 AC DISTRICT: 20 C/SW/BEULAH FD SWAF 1.00 EXCD: NOTICE: 82 3/08/2024

Bldg No. 1 Exempt Code
 Imp Desc: DW MH-DOUBLE WIDE EYB: 1991 9015 FRANK RD LAND VALUE 40,500
 Grade : C+05 C+05 GRADE AYB: 1991 Finished Area: 1,620.00 MISC VALUE 1,620
 # of Units 5 Rms 3 Bedrms 2.0 Bathrms HBaths BLDG VALUE 82,348
 Manufacturer: FLEETWOOD HOMES Serial#: NCFLK69AB03068BS Model: TOTAL VALUE 124,468

TYPE/CODE/DESCRIPTION	PCT	%CMP	UNITS	RATE	STR#	STR%	SIZ%	HGT%	PER%	COST
AC 1031 CARPORT	100		676	27.90			90.00			16,974
AC 1064 DECK-WOOD	100		100	24.95		100.00	125.00			3,118
AC 1064 DECK-WOOD	100		60	24.95		100.00	170.00			2,544
MA 152 MFG-DOUBLE WIDE	100		1620	111.00	1.00		94.50			169,929
- AR 10 FORCED AIR HEAT W/ A100	100		1620	.00						0
- EW 02 VINYL SIDING	100		174	.00						0
- FC 48 VINYL/CARPET	100		1620	.00						0
- FN 03 CONT WALL-BRICK	100		174	.00						0
- FP 2 PREFAB	100		1	3500.00						3,500
- IF 01 DRYWALL	100		1620	.00						0
- RC 02 COMPOSITION SHINGLE	100		1620	.00						0
- RT 03 DOUBLE PITCH ROOF	100		1620	.00						0
RCN... PCT COMPLETE					100	x				196,065
QUAL.. C+05					105.00	x				205,868
DEPR.. MC					60.00	-		123,520		123,520 T
--ASV...										82,348

PROPERTY NOTES:	PERMIT NO	TYPE	DATE	BOOK	PAGE	DT	DATE	QS	SALES	PRICE
CORRECTED SKETCH FROM AUDIT REVIEW/03/08/2021/JHB				2849	936	WD	8/28/2020			103,000
				2699	489	WD	5/12/2017			88,000
				2652	426	WD	4/18/2016			87,500
				2634	473	SWD	11/02/2015	I		28,500

MISC CODE	DESC	UNITS	RATE	AYB	EYB	DT	PCT	%CMP	ADD.DEPR	PCT	VALUE	EXMPT
81 1173	STG-FR 20 X 20	400.00	24.00	2000	2000	MFR	75.00	100			1,620	
							.00					
							.00					
							.00					

#	ZONE	TYPE/CODE	LAND QTY	LAND RATE	DPTH	DPT%	TOP%	LOC%	SIZ%	SHP%	OTH%	ADJ	FMV	EXMPT
1	R20MH	LT 5010	1.500	30,000.00		.00	.00	.00	90.00	.00	.00	90.00	40,500	

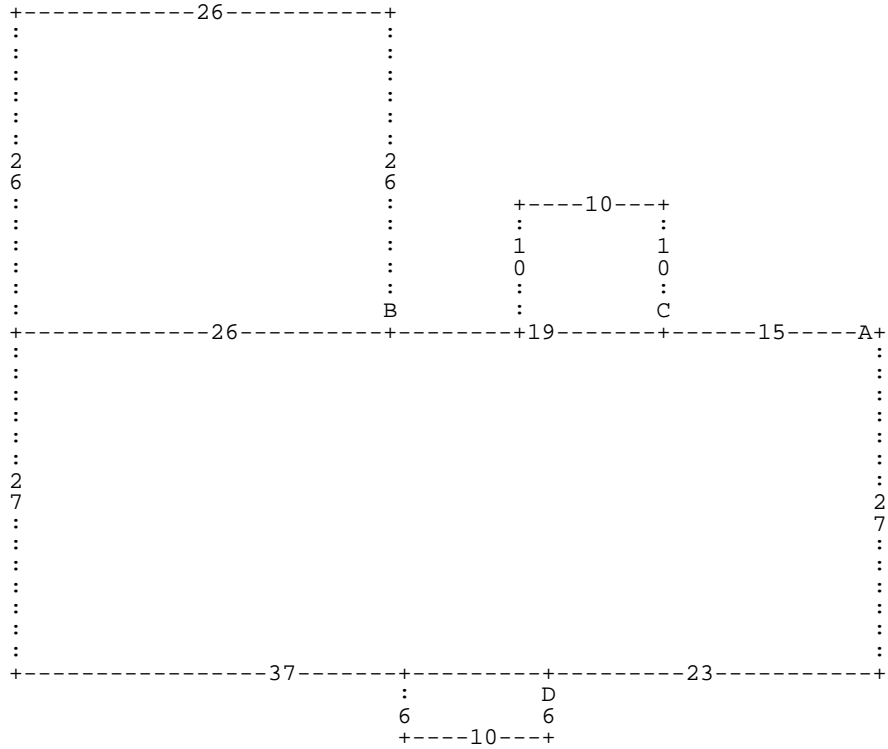

:A DL15 :C DU10 DL10 DD10 DR10 * DL19 :B DU26 DL26 DD26 DR26 * DL26 DD27 DR37 :D
 DD6 DL10 DU6 DR10 * DR23 DU27 *

A= MA 152
 D= AC 1064

1,620.00 MFG-DOUBLE WI
 60.00 DECK-WOOD

B= AC 1031

676.00 CARPORT

C= AC 1064

100.00 DECK-WOOD