

WATSON JOHN R
 8012 SPRINGFIELD SCHOOL RD
 L2L2A WATSON SUB .92AC
 .920 AC

N2 FOUND YR 2024 **2669779500.000**
 8012 SPRINGFIELD SCH RD
 PIN: 2669 77 9500 000
DISTRICT: 19 C/SW/ROCK RIDGE SWAF

Wilson County

ACCOUNT#: 49043920 **PAGE** 1
NBHD: 8287 SPRING_HILL
 Plat Bk/Pg 17 5 **APPR:** REV APPR DT: 9/17/2015
 1.00 EXCD: NOTICE: 82 3/08/2024

Bldg No. 1 Exempt Code
 Imp Desc: R1.5 SFR-UPTO 1.5 STY EYB: 1990 8012 SPRINGFIELD SCHOOL RD **LAND VALUE** 34,454
 Grade : C+05 C+05 GRADE AYB: 1984 Finished Area: 2,168.00 **MISC VALUE** 0
 # of Units 5 Rms 3 Bedrms 2.0 Bathrms HBaths **BLDG VALUE** 179,432
TOTAL VALUE 213,886

TYPE/CODE/DESCRIPTION	PCT	%CMP	UNITS	RATE	STR#	STR%	SIZ%	HGT%	PER%	COST
AC 1052 PORCH-OPEN-MAS	100		330	29.10			97.00			9,314
AC 1053 STOOP-MAS	100		35	19.40			120.00			814
MA 112 SFR-1.5 STY	100		1734	116.00	1.25		94.44			189,959
MA 112 (UPPER FLOORS)	100		434	116.00	1.25	100.00	94.44			47,544
- AR 10 FORCED AIR HEAT W/ A100			2168	.00						0
- AT UAT UNF ATTIC	20		346	27.00			94.44			8,822
- EW 18 BRICK VENEER	100		190	35.00						6,650
- FC 48 VINYL/CARPET	100		2168	.00						0
- FN 03 CONT WALL-BRICK	100		190	.00						0
- FP 4 2STY SNGL/1STY DBL	100		1	8125.00						8,125
- IF 01 DRYWALL	100		1734	.00						0
- RC 07 WOOD SHAKES/3D-SHING	100		1734	.00						0
- RT 03 DOUBLE PITCH ROOF	100		1734	.00						0
RCN...			PCT COMPLETE		100	x				271,228
QUAL..	C+05				105.00	x				284,812
DEPR.. RC					37.00	-		105,380		105,380
--ASV...										179,432

PROPERTY NOTES:	PERMIT NO	TYPE	DATE	BOOK	PAGE	DT	DATE	QS	SALES	PRICE
PERMIT CODE: N MO/YR: 051996 NOTE: 1000				1245	403	WD	10/01/1983	X		500

MISC CODE	DESC	UNITS	RATE	AYB	EYB	DT	PCT	%CMP	ADD.DEPR	PCT	VALUE	EXMPT
							.00					
							.00					
							.00					
							.00					

#	ZONE	TYPE/CODE	LAND QTY	LAND RATE	DPTH	DPT%	TOP%	LOC%	SIZ%	SHP%	OTH%	ADJ	FMV	EXMPT
1	AR	AC 5010	.920	35,000.00		.00	.00	.00	107.00	.00	.00	107.00	34,454	

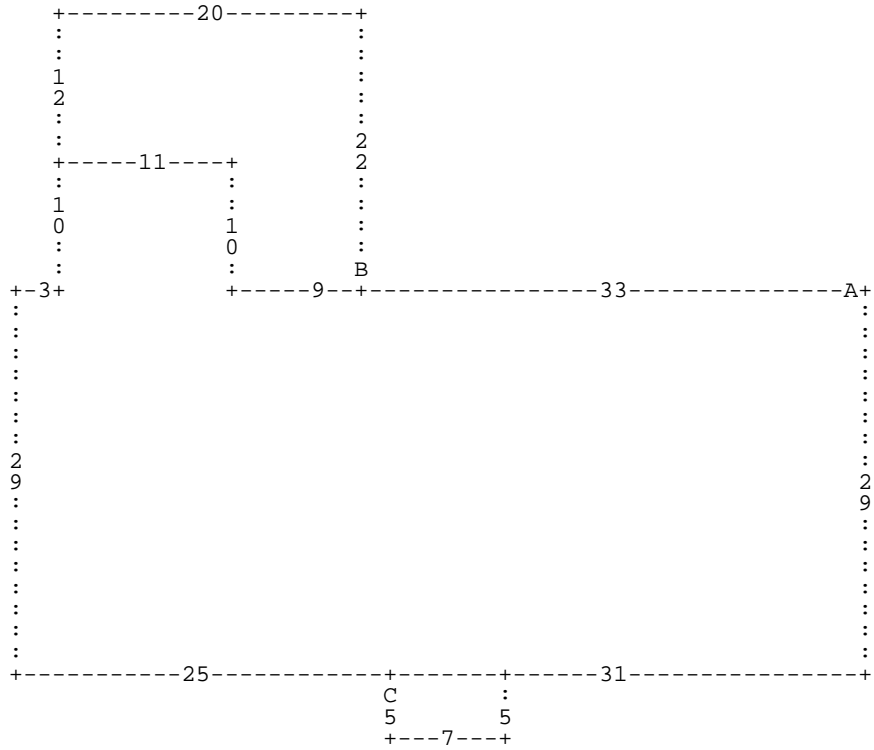

:A DL33 :B DU22 DL20 DD12 DR11 DD10 DR9 * DL9 DU10 DL11 DD10 DL3 DD29 DR25 :C DD
 5 DR7 DU5 DL7 * DR31 DU29 *

A= MA 112

1,734.00 SFR-1.5 STY

B= AC 1052

330.00 PORCH-OPEN-MA

C= AC 1053

35.00 STOOP-MAS