

SHEPARD KATHY F
 628 LINCOLN DR
 L87S1 ENGLEWOOD 1.00LT
 .694 AC

Wilson County
 YR 2024 2667069392.000
 628 LINCOLN DR
 PIN: 2667 06 9392 000
 DISTRICT: 28 C/CIKN-KENLY

ACCOUNT#: 47859500 PAGE 1
 NBHD: 8525 ENGLEWOOD SUBD
 Plat Bk/Pg 12 151 APPR: REV APPR DT: 9/28/2015
 EXCD: NOTICE: 82 3/08/2024

Bldg No. 1
 Imp Desc: R1.0 SFR-1.0 STY EYB: 1993 628 LINCOLN DR Exempt Code LAND VALUE 37,500
 Grade : C-05 C-05 GRADE AYB: 1988 Finished Area: 2,052.00 MISC VALUE 898
 # of Units 10 Rms 4 Bedrms 2.0 Bathrms 1 HBaths BLDG VALUE 178,915
 TOTAL VALUE 217,313

TYPE/CODE/DESCRIPTION	PCT	%CMP	UNITS	RATE	STR#	STR%	SIZ%	HGT%	PER%	COST
AC 1051 PORCH-OPEN-FR	100		45	38.80			110.00			1,920
AC 1051 PORCH-OPEN-FR	100		24	38.80			120.00			1,117
AC 1051 PORCH-OPEN-FR	100		110	38.80			104.00			4,438
MA 111 SFR-1.0 STY	100		2052	136.00	1.00		95.25			265,816
- AR 14 GAS PACK	100		2052	.00						0
- BT HBT HALF BATH	100		1	3667.00						3,667
- EW 02 VINYL SIDING	100		240	.00						0
- FC 48 VINYL/CARPET	100		2052	.00						0
- FN 02 CONT WALL-CONC BLOCK	100		240	.00						0
- IF 01 DRYWALL	100		2052	.00						0
- RC 02 COMPOSITION SHINGLE	100		2052	.00						0
- RT 03 DOUBLE PITCH ROOF	100		2052	.00						0
RCN...					100	x				276,958
QUAL..	C-05				95.00	x				263,110
DEPR.. RC					32.00	-		84,195		84,195 T
--ASV...										178,915

PROPERTY NOTES:	PERMIT NO	TYPE	DATE	BOOK	PAGE	DT	DATE	QS	SALES	PRICE
SFR MVD FROM 2667160235.000 4 '10-GRW				1324	831	WD	10/25/1999	@		
	AMOUNT			1321	919	WD	4/22/1987	A	11,000	
	AMOUNT			1230	133	WD	3/20/1987	A	10,000	
							1/24/1983	X	5,000	

MISC CODE	DESC	UNITS	RATE	AYB	EYB	DT	PCT	%CMP	ADD.DEPR	PCT	VALUE	EXMPT
81 1164	DECK-WOOD-DET 12 X 16	192.00	24.95	2000	2000	MFR	75.00	100			898	
							.00					
							.00					
							.00					

#	ZONE	TYPE/CODE	LAND	QTY	LAND RATE	DPTH	DPT%	TOP%	LOC%	SIZ%	SHP%	OTH%	ADJ	FMV	EXMPT
1	R10MH	LT 0100		2.000	25,000.00		.00	.00	.00	75.00	.00	.00	75.00	37,500	

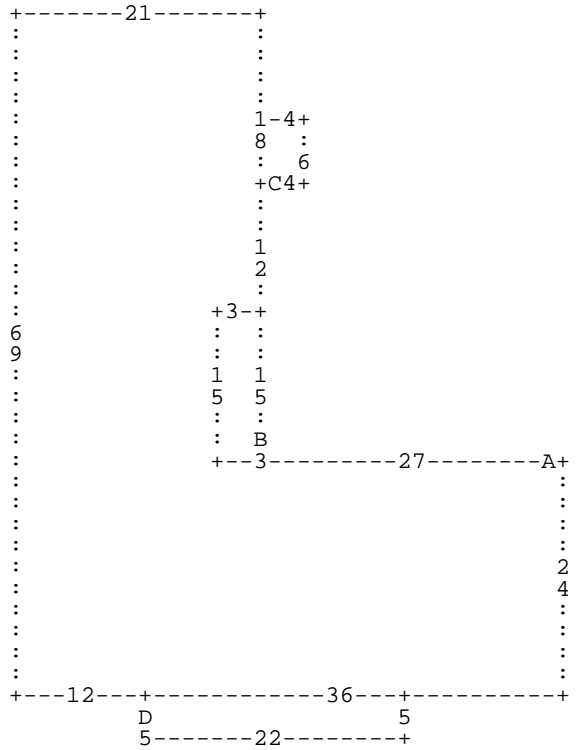

:A DL27 :B DU15 DL3 DD15 DR3 * DL3 DU15 DR3 DU12 :C DR4 DU6 DL4 DD6 * DU18 DL21
 DD69 DR12 :D DD5 DR22 DU5 DL22 * DR36 DU24 *

A= MA 111 2,052.00 SFR-1.0 STY B= AC 1051 45.00 PORCH-OPEN-FR C= AC 1051 24.00 PORCH-OPEN-FR
 D= AC 1051 110.00 PORCH-OPEN-FR